

**NOTICE!!**

**These documents have been scanned!**

**Do not place un-scanned documents beneath this notice!**

**Do not remove this notice from this file!**

GPO Jacket No. 560-102  
Print Order 61540  
Rise Business Services, LLC  
Job=AZ15 6/26/2019



Box Number= AZ15134



Claim Begin-End: AMC356059-AMC356059

**1 Initial Receipt**



AZ15134-5

AMC356454-AMC363464

Sec 34

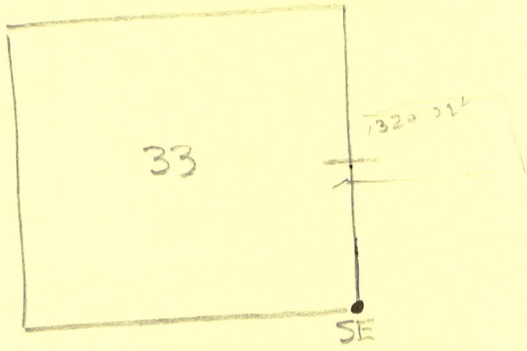



**United States Department of the Interior**  
**Bureau of Land Management**  
 BUSINESS & SUPPORT SVCS DIV  
 222 N CENTRAL AVE  
 PHOENIX, AZ 85004 -2203  
 Phone: (602) 417-9200

Receipt	
No:	465961

<b>Transaction #:</b> 488100	
<b>Date of Transaction:</b> 03/26/2002	
<b>CUSTOMER:</b>	MARTIN J MCKENNA RED HILLS MINING, LLC 4101 E. TAMAYA STREET PHOENIX,AZ 85044

*RS 3/29/2002*  
**ENTERED IN COMPUTER**

LINE #	QTY	DESCRIPTION	REMARKS	UNIT PRICE	TOTAL
1	17.00	LOCATABLE MINERALS / MINING CLAIMS-NEW, UNADJUDI, ONE OR MORE AUTH NO'S / NEW MINING CLM MAINT FEE \$100(1993) <b>CASES:</b> AMC356059/\$100.00, AMC356060/\$100.00, AMC356061/\$100.00, AMC356062/\$100.00, AMC356063/\$100.00, AMC356064/\$100.00, AMC356065/\$100.00, AMC356066/\$100.00, AMC356067/\$100.00, AMC356068/\$100.00, AMC356069/\$100.00, AMC356070/\$100.00, AMC356071/\$100.00, AMC356072/\$100.00, AMC356073/\$100.00, AMC356074/\$100.00, AMC356075/\$100.00		- n/a -	1700.00
2	17.00	LOCATABLE MINERALS / MINING CLAIMS-NEW, UNADJUDI, ONE OR MORE AUTH NO'S / NEW MINING CLAIM SVC CHG \$10 (1930) <b>CASES:</b> AMC356059/\$10.00, AMC356060/\$10.00, AMC356061/\$10.00, AMC356062/\$10.00, AMC356063/\$10.00, AMC356064/\$10.00, AMC356065/\$10.00, AMC356066/\$10.00, AMC356067/\$10.00, AMC356068/\$10.00, AMC356069/\$10.00, AMC356070/\$10.00, AMC356071/\$10.00, AMC356072/\$10.00, AMC356073/\$10.00, AMC356074/\$10.00, AMC356075/\$10.00		- n/a -	170.00
3	17.00	LOCATABLE MINERALS / MINING CLAIMS-NEW, UNADJUDI, ONE OR MORE AUTH NO'S / NEW MINING CLAIM LOCATION FEE \$25(1993) <b>CASES:</b> AMC356059/\$25.00, AMC356060/\$25.00, AMC356061/\$25.00, AMC356062/\$25.00, AMC356063/\$25.00, AMC356064/\$25.00, AMC356065/\$25.00, AMC356066/\$25.00, AMC356067/\$25.00, AMC356068/\$25.00, AMC356069/\$25.00, AMC356070/\$25.00, AMC356071/\$25.00, AMC356072/\$25.00, AMC356073/\$25.00, AMC356074/\$25.00, AMC356075/\$25.00		- n/a -	425.00
4	17.00	IAC PRODUCTS / COPIES / CASEFILE/DOCUMENT COPIES / COPIES (B/W UP TO 11X17)-\$.13/P		0.13	2.21
5	1.00	IAC PRODUCTS / SERVICE/ADMIN CHARGES / MAILING COSTS / POSTAGE		- n/a -	0.30
<b>TOTAL:</b>					<b>\$2,297.51</b>

PAYMENT INFORMATION			
1	AMOUNT:	\$2,297.51	POSTMARKED: 03/22/2002
	TYPE:	CHECK	RECEIVED: 03/25/2002
	CHECK NO:	1016	
	NAME:	RED HILLS MINING, LLC. 4101 E. TAMAYA STREET PHOENIX AZ 85044	

REMARKS
602-735-6887

This receipt was generated by the automated BLM Collections and Billings System and is a paper representation of a portion of the official electronic record contained therein.



**NOTICE!!**

**These documents have been scanned!**

**Do not place un-scanned documents beneath this notice!**

**Do not remove this notice from this file!**

GPO Jacket No. 560-102  
Print Order 61540  
Rise Business Services, LLC  
Job=AZ15 6/26/2019



Box Number= AZ15134



Claim Begin-End: AMC356059-AMC356059

**2 Correspondence**



AZ15134-5

AMC356454-AMC363464

**NO  
DOCUMENTS  
FOUND**

NO DOCUMENTS FOUND  
NO DOCUMENTS FOUND



**NOTICE!!**

**These documents have been scanned!**

**Do not place un-scanned documents beneath this notice!**

**Do not remove this notice from this file!**

GPO Jacket No. 560-102  
Print Order 61540  
Rise Business Services, LLC  
Job=AZ15 6/26/2019



Box Number= AZ15134



Claim Begin-End: AMC356059-AMC356059

**3 Transfers**



AZ15134-5

AMC356454-AMC363464

**NO  
DOCUMENTS  
FOUND**

NO DOCUMENTS FOUND  
NO DOCUMENTS FOUND

**NOTICE!!**

**These documents have been scanned!**

**Do not place un-scanned documents beneath this notice!**

**Do not remove this notice from this file!**

GPO Jacket No. 560-102  
Print Order 61540  
Rise Business Services, LLC  
Job=AZ15 6/26/2019



Box Number= AZ15134



Claim Begin-End: AMC356059-AMC356059

**4 Annual Filings**



AZ15134-5

AMC356454-AMC363464



356003

356059

356123

336106

376428

401831

**MAINTENANCE FEE PAYMENT**

Claimant Name: Clarence Heister

Address: P.O. BOX 937

City: Globe State: Az Zip: 85502

Telephone: 602-722-0861

E-mail address: \_\_\_\_\_

Signature: Clarence B Heister

Check here if this is a change of address.

RECEIVED  
 ARIZONA STATE OFFICE  
 2018 AUG 27 P 1:08  
 PHOENIX, ARIZONA  
 BLM  
 Date  
 Stamp

LINE NO.	AMC NUMBER	CLAIM/SITE NAME	COUNTY RECORDER DATA (If available)	TWP	RNG	SEC
1	356003	Bluerock 20				
2	004	21				
3	005	22				
4	059	23				
5	060	24				
6	061	25				
7	062	26				
8	063	27				
9	064	28				
10	065	29				

List additional claims on Form MCF114.

Bureau of Land Management  
Arizona State Office  
[www.blm.gov/az/](http://www.blm.gov/az/)

No. of Claims\*: 49 x \$155 = \$7595.  
 Check No: 1023 Init. ERC  
 Receipt No.: 4246087  
 For BLM Use Only

\* \$155 per lode mining claim, mill site, or tunnel site; and \$155 for each 20 acres or portion thereof for each placer mining claim.

Form: MCF112  
Revised July 2014

This form is available from the Arizona Geological Survey and may be reproduced.

ENTERED AUG 28 2018

AC 782 PB



**SUPPLEMENTAL ATTACHMENT**

May be used with the following forms for listing additional mining claims:

Check One.

- Affidavit of Performance of Annual Work
- Maintenance Fee Payment
- Notice of Intent to Hold Mining Claims
- Notice of Non-Liability for Labor and Materials Furnished
- Quit claim Deed

BLM  
Date  
Stamp

RECEIVED  
M M AZ STATE OFFICE  
2018 AUG 27 11:08  
PHOENIX, ARIZONA

LINE NO.	AMC NUMBER	CLAIM/SITE NAME	COUNTY RECORDER DATA (If available)	TWP	RNG	SEC
11	336106	BLUEROCK 1				
12	107	2				
13	108	3				
14	109	4				
15	110	5				
16	114	9				
17	116	11				
18	121	16				
19	356066	BLUEROCK 30				
20	067	31				
21	068	32				
22	069	33				
23	070	34				
24	071	35				
25	072	36				
26	073	37				
27	074	38				
28	075	39				
29	356123	40				

ENTERED AUG 28 2018

AC 182 PB

Form MCF114  
Revised July 2014

This form is available from the Arizona Geological Survey and may be reproduced.

**SUPPLEMENTAL ATTACHMENT**

May be used with the following forms for listing additional mining claims:

Check One.

- Affidavit of Performance of Annual Work
- Maintenance Fee Payment
- Notice of Intent to Hold Mining Claims
- Notice of Non-Liability for Labor and Materials Furnished
- Quit claim Deed

RECEIVED  
BLM AZ STATE OFFICE  
PHOENIX, ARIZONA  
2018 AUG 21 P 1:08

BLM  
Date  
Stamp

LINE NO.	AMC NUMBER	CLAIM/SITE NAME	COUNTY RECORDER DATA (If available)	TWP	RNG	SEC
30	356124	BLOEROCK				
31	125					
32	126					
33	127					
36	128					
35	129					
36	130					
37	131					
38	132					
39	133					
40	134					
41	135					
42	136					
43	137					
44	376428					
45	429					
46	430					
47	431					
48	432					

ENTERED AUG 28 2018

AC 782 PB

Form MCF114  
Revised July 2014

This form is available from the Arizona Geological Survey and may be reproduced.

SUPPLEMENTAL ATTACHMENT

RECEIVED  
BLM  
Date  
Stamp  
2018 AUG 27 P 1:08  
PHOENIX, ARIZONA  
BLM AZ STATE OFFICE

May be used with the following forms for listing additional mining claims:

Check One.

- Affidavit of Performance of Annual Work
- Maintenance Fee Payment
- Notice of Intent to Hold Mining Claims
- Notice of Non-Liability for Labor and Materials Furnished
- Quit claim Deed

LINE NO.	AMC NUMBER	CLAIM/SITE NAME	COUNTY RECORDER DATA (If available)	TWP	RNG	SEC
49	401831	BLUEROCK 14				

Ac 782  
ENTERED AUG 28 2018  
PB

Form MCF114  
Revised July 2014

This form is available from the Arizona Geological Survey and may be reproduced.



**United States Department of the Interior**  
**Bureau of Land Management**  
 DIV OF LANDS, MINRLS & ENERGY  
 ONE N CENTRAL AVE  
 PHOENIX, AZ 85004 -4427  
 Phone: 602-417-9200

Receipt

No: 4246087

<b>Transaction #:</b> 4361538	
<b>Date of Transaction:</b> 08/27/2018	
CUSTOMER:	
CLARENCE HEISLER PO BOX 937 GLOBE, AZ 85502-0937 US	

AC 782  
 ENTERED AUG 28 2018

LINE #	QTY	DESCRIPTION	REMARKS	UNIT PRICE	TOTAL
1	1.00	LOCATABLE MINERALS / MINING CLAIMS- NOT NEW-UNADJUD, ONE AUTH NO. ONLY / MINING CLAIM MONEY RECEIVED <b>CASES: AMC356003/\$7595.00</b>	2019 MAINT (49)	- n/a -	7595.00
<b>TOTAL:</b>					<b>\$7,595.00</b>

PAYMENT INFORMATION						
1	AMOUNT:	7595.00	POSTMARKED:	N/A		
	TYPE:	CHECK	RECEIVED:	08/27/2018		
	CHECK NO:	1023				
	NAME:	RED HILLS MINING LLC 32526 E HAWKVIEW RD FLORENCE AZ 85232 US				

REMARKS

This receipt was generated by the automated BLM Collections and Billing System and is a paper representation of a portion of the official electronic record contained therein.



356003

356059

356123 336106

**MAINTENANCE FEE PAYMENT**

Claimant Name: Clarence Heister

Address: P.O. Box 937

City: Globe State: Az Zip: 85502

Telephone: 602-722-0861

E-mail address: \_\_\_\_\_

Signature: Clarence B Heister

Check here if this is a change of address.

376428	PHOENIX, ARIZONA	2011 AUG 30 P 12: 30	RECEIVED BLM STATE OFFICE
401831			
BLM	Date	Stamp	

LINE NO.	AMC NUMBER	CLAIM/SITE NAME	COUNTY RECORDER DATA (if available)	TWP	RNG	SEC
1	356003	BLUEROCK 20				
2	004	21				
3	005	22				
4	059	23				
5	060	24				
6	061	25				
7	062	26				
8	063	27				
9	064	28				
10	065	29				

List additional claims on Form MCF114.

Bureau of Land Management  
Arizona State Office  
[www.blm.gov/az/](http://www.blm.gov/az/)

No. of Claims*: <u>49</u> x \$155 = <u>7595.00</u>
Check No: <u>1019</u> Init. <u>ES</u>
Receipt No.: <u>3966015</u>
For BLM Use Only

\* \$155 per lode mining claim, mill site, or tunnel site; and \$155 for each 20 acres or portion thereof for each placer mining claim.

Form: MCF112  
Revised July 2014

This form is available from the Arizona Geological Survey and may be reproduced.

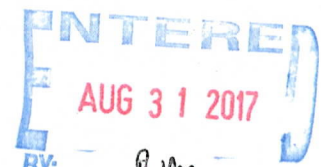

May be used with the following forms for listing additional mining claims:

Check One.

- Affidavit of Performance of Annual Work
- Maintenance Fee Payment
- Notice of Intent to Hold Mining Claims
- Notice of Non-Liability for Labor and Materials Furnished
- Quit claim Deed

BLM  
Date  
Stamp

PHOENIX, ARIZONA  
2011 AUG 30 12:38

RECEIVED  
STATE OFFICE

LINE NO.	AMC NUMBER	CLAIM/SITE NAME	COUNTY RECORDER DATA (If available)	TWP	RNG	SEC
11	336106	BLUEROCK 1				
12	107	2				
13	108	3				
14	109	4				
15	110	5				
16	114	9				
17	116	11				
18	121	16				
19	356066	BLUEROCK 30				
20	067	31				
21	068	32				
22	069	33				
23	070	34				
24	071	35				
25	072	36				
26	073	37				
27	074	38				
28	075	39				
29	356123	40				

Form MCF114  
Revised July 2014

This form is available from the Arizona Geological Survey and may be reproduced.



May be used with the following forms for listing additional mining claims:

Check One.

- Affidavit of Performance of Annual Work
- Maintenance Fee Payment
- Notice of Intent to Hold Mining Claims
- Notice of Non-Liability for Labor and Materials Furnished
- Quit claim Deed

BLM  
Date  
Stamp

RECEIVED  
 PHOENIX, ARIZONA  
 2011 AUG 30 P 12:36  
 OFFICE

LINE NO.	AMC NUMBER	CLAIM/SITE NAME	COUNTY RECORDER DATA (if available)	TWP	RNG	P 12:36	OFFICE
30	356124	BLUEROCK					
31	125						
32	126						
33	127						
36	128						
35	129						
36	130						
37	131						
38	132						
39	133						
40	134						
41	135						
42	136						
43	137						
44	376428						
45	429						
46	430						
47	431						
48	432						

Form MCF114  
Revised July 2014

This form is available from the Arizona Geological Survey and may be reproduced.





**United States Department of the Interior  
Bureau of Land Management**

DIV OF LANDS, MINRLS & ENERGY

ONE N CENTRAL AVE

PHOENIX, AZ 85004 -4427

Phone: 602-417-9200

Receipt

No:

3966015

<b>Transaction #:</b> 4075895	
<b>Date of Transaction:</b> 08/30/2017	
<b>CUSTOMER:</b>	
CLARENCE HEISLER PO BOX 937 GLOBE,AZ 85502-0937 US	

LINE #	QTY	DESCRIPTION	REMARKS	UNIT PRICE	TOTAL
1	1.00	LOCATABLE MINERALS / MINING CLAIMS- NOT NEW-UNADJUD,ONE AUTH NO. ONLY / MINING CLAIM MONEY RECEIVED <b>CASES: AMC356003/\$7595.00</b>	2018 MAINT (49)	- n/a -	7595.00
<b>TOTAL:</b>					<b>\$7,595.00</b>

PAYMENT INFORMATION					
1	AMOUNT:	7595.00	POSTMARKED:	N/A	
	TYPE:	CHECK	RECEIVED:	08/30/2017	
	CHECK NO:	1019			
	NAME:	RED HILLS MINING LLC 32526 E HAWKVIEW RD FLORENCE AZ 85232 US			

REMARKS

This receipt was generated by the automated BLM Collections and Billing System and is a paper representation of a portion of the official electronic record contained therein.

356003  
 356059  
 336106  
 356123  
 376428  
 401831

**MAINTENANCE FEE PAYMENT**

Claimant Name: Clarence Heister  
 Address: P.O. Box 937  
 City: Globe State: Az Zip: 85502  
 Telephone: 602-722-0861  
 E-mail address: \_\_\_\_\_  
 Signature: Clarence B Heister

RECEIVED  
 BLM AZ STATE OFFICE  
 2016 AUG 29 P 1:18  
 PHOENIX, ARIZONA  
 BLM  
 Date  
 Stamp

Check here if this is a change of address.

LINE NO.	AMC NUMBER	CLAIM/SITE NAME	COUNTY RECORDER DATA (If available)	TWP	RNG	SEC
1	356003	BLUEROCK 20				
2	004	21				
3	005	22				
4	059	23				
5	060	24				
6	061	25				
7	062	26				
8	063	27				
9	064	28				
10	065	29				

List additional claims on Form MCF114.

Bureau of Land Management  
 Arizona State Office  
[www.blm.gov/az/](http://www.blm.gov/az/)

No. of Claims\*: 49 x \$155 = 7595  
 Check No: 1009 Init. PETZ  
 Receipt No.: 3645215  
 For BLM Use Only

\* \$155 per lode mining claim, mill site, or tunnel site; and \$155 for each 20 acres or portion thereof for each placer mining claim.

Form: MCF112  
 Revised July 2014

This form is available from the Arizona Geological Survey and may be reproduced.

ENTERED  
 AUG 30 2016  
 BY: RE

**SUPPLEMENTAL ATTACHMENT**

May be used with the following forms for listing additional mining claims:

Check One.

- Affidavit of Performance of Annual Work
- Maintenance Fee Payment
- Notice of Intent to Hold Mining Claims
- Notice of Non-Liability for Labor and Materials Furnished
- Quit claim Deed

RECEIVED  
BLM AZ STATE OFFICE  
PHOENIX, ARIZONA  
2016 AUG 29 P 1:18  
BLM  
Date  
Stamp

LINE NO.	AMC NUMBER	CLAIM/SITE NAME	COUNTY RECORDER DATA (if available)	TWP	RNG	SEC
11	336106	Bluerock 1				
12	107	2				
13	108	3				
14	109	4				
15	110	5				
16	114	9				
17	116	11				
18	121	16				
19	356066	Bluerock 30				
20	067	31				
21	068	32				
22	069	33				
23	070	34				
24	071	35				
25	072	36				
26	073	37				
27	074	38				
28	075	39				
29	356123	40				

Form MCF114  
Revised July 2014

This form is available from the Arizona Geological Survey and may be reproduced.



**SUPPLEMENTAL ATTACHMENT**

May be used with the following forms for listing additional mining claims:

Check One.

- Affidavit of Performance of Annual Work
- Maintenance Fee Payment
- Notice of Intent to Hold Mining Claims
- Notice of Non-Liability for Labor and Materials Furnished
- Quit claim Deed

RECEIVED  
 BLM AZ STATE OFFICE  
 2016 AUG 29 P 1:18  
 PHOENIX, ARIZONA  
 BLM  
 Date  
 Stamp

LINE NO.	AMC NUMBER	CLAIM/SITE NAME	COUNTY RECORDER DATA (If available)	TWP	RNG	SEC
30	356124	BLUEROCK				
31	125					
32	126					
33	127					
36	128					
35	129					
36	130					
37	131					
38	132					
39	133					
40	134					
41	135					
42	136					
43	137					
44	376428					
45	429					
46	430					
47	431					
48	432					

401831 Bluerock 14

Form MCF114  
 Revised July 2014

**SUPPLEMENTAL ATTACHMENT**

May be used with the following forms for listing additional mining claims:

Check One.

- Affidavit of Performance of Annual Work
- Maintenance Fee Payment
- Notice of Intent to Hold Mining Claims
- Notice of Non-Liability for Labor and Materials Furnished
- Quit claim Deed

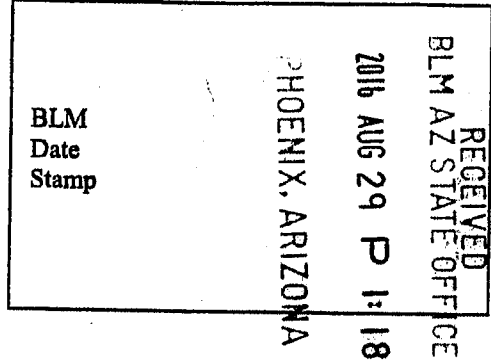

LINE NO.	AMC NUMBER	CLAIM/SITE NAME	COUNTY RECORDER DATA (If available)	TWP	RNG	SEC
49	401831	BLUESOCK 14				

**United States Department of the Interior**  
**Bureau of Land Management**  
 DIV OF LANDS, MINRLS & ENERGY  
 ONE N CENTRAL AVE  
 PHOENIX, AZ 85004 -4427  
 Phone: 602-417-9200

Receipt

No: 3645215

<b>Transaction #:</b> 3749196	
<b>Date of Transaction:</b> 08/29/2016	
CUSTOMER:	
CLARENCE HEISLER PO BOX 937 GLOBE,AZ 85502-0937 US	

LINE #	QTY	DESCRIPTION	REMARKS	UNIT PRICE	TOTAL
1	1.00	LOCATABLE MINERALS / MINING CLAIMS- NOT NEW-UNADJUD,ONE AUTH NO. ONLY / MINING CLAIM MONEY RECEIVED <b>CASES: AMC356003/\$7595.00</b>	2017 MAINT/49	- n/a -	7595.00
<b>TOTAL:</b>					<b>\$7,595.00</b>

PAYMENT INFORMATION			
1	AMOUNT:	7595.00	POSTMARKED: N/A
	TYPE:	CHECK	RECEIVED: 08/29/2016
	CHECK NO:	1009	
	NAME:	HEISLER, CLARENCE PO BOX 937 GLOBE AZ 85502-0937 US	

REMARKS

This receipt was generated by the automated BLM Collections and Billing System and is a paper representation of a portion of the official electronic record contained therein.



356003  
 356059  
 336106  
 356123  
 376428  
 401831

**MAINTENANCE FEE PAYMENT**

Claimant Name: Clarence Heister  
 Address: P.O. BOX 937  
 City: Globe State: Az Zip: 85502  
 Telephone: 602-722-0861  
 E-mail address: \_\_\_\_\_  
 Signature: Clarence B Heister

RECEIVED  
 BLM AZ STATE OFFICE  
 2015 AUG 31 P 12: 53  
 PHOENIX, ARIZONA  
 BLM  
 Date  
 Stamp

Check here if this is a change of address.

LINE NO.	AMC NUMBER	CLAIM/SITE NAME	COUNTY RECORDER DATA (If available)	TWP	RNG	SEC
1	356003	BLUEROCK 20				
2	004	21				
3	005	22				
4	059	23				
5	060	24				
6	061	25				
7	062	26				
8	063	27				
9	064	28				
10	065	29				

List additional claims on Form MCF114.

**Bureau of Land Management**  
**Arizona State Office**  
[www.blm.gov/az/](http://www.blm.gov/az/)

No. of Claims\*: 49 x \$155 = 7,595  
 Check No: 1005 Init. YML  
 Receipt No.: 3381617  
 For BLM Use Only

\* \$155 per lode mining claim, mill site, or tunnel site; and \$155 for each 20 acres or portion thereof for each placer mining claim.

**Form: MCF112**  
 Revised July 2014

This form is available from the Arizona Geological Survey and may be reproduced.

*Ram*

**SUPPLEMENTAL ATTACHMENT**

May be used with the following forms for listing additional mining claims:

Check One.

- Affidavit of Performance of Annual Work
- Maintenance Fee Payment
- Notice of Intent to Hold Mining Claims
- Notice of Non-Liability for Labor and Materials Furnished
- Quit claim Deed

RECEIVED  
 BLM AZ STATE OFFICE  
 PHOENIX, ARIZONA  
 2015 AUG 31 P 12:53  
 BLM  
 Date  
 Stamp

LINE NO.	AMC NUMBER	CLAIM/SITE NAME	COUNTY RECORDER DATA (if available)	TWP	RNG	SEC
11	336106	Bluerock 1				
12	107	2				
13	108	3				
14	109	4				
15	110	5				
16	114	9				
17	116	11				
18	121	16				
19	336066	Bluerock 30				
20	067	31				
21	068	32				
22	069	33				
23	070	34				
24	071	35				
25	072	36				
26	073	37				
27	074	38				
28	075	39				
29	336123	40				

**Form MCF114**  
 Revised July 2014

This form is available from the Arizona Geological Survey and may be reproduced.

**SUPPLEMENTAL ATTACHMENT**

May be used with the following forms for listing additional mining claims:  
Check One.

- Affidavit of Performance of Annual Work
- Maintenance Fee Payment
- Notice of Intent to Hold Mining Claims
- Notice of Non-Liability for Labor and Materials Furnished
- Quit claim Deed

RECEIVED  
BLM AZ STATE OFFICE  
2015 AUG 31 P 12:53  
PHOENIX, ARIZONA

BLM  
Date  
Stamp

LINE NO.	AMC NUMBER	CLAIM/SITE NAME	COUNTY RECORDER DATA (If available)	TWP	RNG	SEC
30	356124 <sup>7</sup>	BLUEROCK				
31	125					
32	126					
33	127					
36	128					
35	129					
36	130					
37	131					
38	132					
39	133					
40	134					
41	135					
42	136					
43	137					
44	376428 <sup>7</sup>					
45	429					
46	430					
47	431					
48	432					

Form MCF114  
Revised July 2014





United States Department of the Interior  
 Bureau of Land Management  
 LANDS/RECREATION & PLANNING  
 ONE N CENTRAL AVE  
 PHOENIX, AZ 85004 -2203  
 Phone: 602-417-9200

Receipt

No: 3381617

<b>Transaction #:</b> 3479910	
<b>Date of Transaction:</b> 08/31/2015	
<b>CUSTOMER:</b>	
CLARENCE HEISLER PO BOX 937 GLOBE, AZ 85502-0937 US	

LINE #	QTY	DESCRIPTION	REMARKS	UNIT PRICE	TOTAL
1	1.00	LOCATABLE MINERALS / MINING CLAIMS- NOT NEW-UNADJUD, ONE AUTH NO. ONLY / MINING CLAIM MONEY RECEIVED <b>CASES: AMC356003/\$7595.00</b>	MAINT 2016/49	- n/a -	7595.00
<b>TOTAL:</b>					<b>\$7,595.00</b>

PAYMENT INFORMATION			
1	AMOUNT:	7595.00	POSTMARKED: N/A
	TYPE:	CHECK	RECEIVED: 08/31/2015
	CHECK NO:	1005	
	NAME:	HEISLER, CLARENCE 32526 E HAWKVIEW RD FLORENCE AZ 85232 US	

REMARKS

This receipt was generated by the automated BLM Collections and Billing System and is a paper representation of a portion of the official electronic record contained therein.

*R. Heisler*

401831 336106  
 356003  
 356059  
 356123  
 376428

**MAINTENANCE FEE PAYMENT**

Claimant Name: CLARENCE HEISLER  
 Address: PO BOX 937  
 City: GLOBE State: AZ Zip: 85502  
 Telephone: 602-722-0861  
 E-mail address: \_\_\_\_\_  
 Signature: Clarence Heisler

RECEIVED  
 AZ STATE OFFICE  
 JULY AUG 29 P 12: 21  
 PHOENIX, ARIZONA  
 BLM  
 Date  
 Stamp

Check here if this is a change of address.

LINE NO.	AMC NUMBER	CLAIM/SITE NAME	COUNTY RECORDER DATA (If available)	TWP	RNG	SEC
1	356003	Bluerock 20				
2	004	21				
3	005	22				
4	059	23				
5	060	24				
6	061	25				
7	062	26				
8	063	27				
9	064	28				
10	065	29				

List additional claims on Form MCF114.

Bureau of Land Management  
 Arizona State Office  
[www.blm.gov/az/](http://www.blm.gov/az/)

INTEREST  
 SEP 02 2014  
 13

No. of Claims\*: 49 x \$155 = 7595  
 Check No: 1036888798 Init. CHM  
 Receipt No.: 3117364  
 For BLM Use Only

\* \$155 per lode mining claim, mill site, or tunnel site; and \$155 for each 20 acres or portion thereof for each placer mining claim.

Form: MCF112  
 Revised July 2014



**SUPPLEMENTAL ATTACHMENT**

May be used with the following forms for listing additional mining claims:

Check One.

- Affidavit of Performance of Annual Work
- Maintenance Fee Payment
- Notice of Intent to Hold Mining Claims
- Notice of Non-Liability for Labor and Materials Furnished

RECEIVED  
 M AZ STATE OFFICE  
 PHOENIX, ARIZONA  
 2014 AUG 29 P 12: 21  
 BLM  
 Date  
 Stamp

LINE NO.	AMC NUMBER	CLAIM/SITE NAME	COUNTY RECORDER DATA (If available)	TWP	RNG	SEC
11	336106	Bluerock 1				
12	107	2				
13	108	3				
14	109	4				
15	110	5				
16	114	9				
17	116	11				
18	121	16				
19	356066	Bluerock 30				
20	067	31				
21	068	32				
22	069	33				
23	070	34				
24	071	35				
25	072	36				
26	073	37				
27	074	38				
28	075	39				
29	356123	40				

Form MCF114  
 Revised June 2005

**SUPPLEMENTAL ATTACHMENT**

May be used with the following forms for listing additional mining claims:

Check One.

- Affidavit of Performance of Annual Work
- Maintenance Fee Payment
- Notice of Intent to Hold Mining Claims
- Notice of Non-Liability for Labor and Materials Furnished

RECEIVED  
 M A Z STATE OFFICE  
 2014 AUG 29 P 12:22  
 PHOENIX, ARIZONA  
 BLM  
 Date  
 Stamp

LINE NO.	AMC NUMBER	CLAIM/SITE NAME	COUNTY RECORDER DATA (If available)	TWP	RNG	SEC
30	356124	Blood				
31	129					
32	126					
33	127					
34	128					
35	129					
36	130					
37	131					
38	132					
39	133					
40	134					
41	135					
42	136					
43	137					
44	376428					
45	429					
46	430					
47	431					
48	432					

Form MCF114  
 Revised June 2005





**United States Department of the Interior  
Bureau of Land Management  
LANDS/RECREATION & PLANNING  
ONE N CENTRAL AVE  
PHOENIX, AZ 85004 -2203  
Phone: 602-417-9200**

Receipt

No: 3117364

<b>Transaction #:</b> 3209148		<b>ENTERED INTO COMPUTER</b>
<b>Date of Transaction:</b> 08/29/2014		
CUSTOMER: SEP - 2 2014 JB		
CLARENCE HEISLER PO BOX 937 GLOBE, AZ 85502-0937 US		

LINE #	QTY	DESCRIPTION	REMARKS	UNIT PRICE	TOTAL
1	1.00	LOCATABLE MINERALS / MINING CLAIMS- NOT NEW-UNADJUD, ONE AUTH NO. ONLY / MINING CLAIM MONEY RECEIVED CASES: AMC356003/\$7595.00	MAINT 2015/49✓	- n/a -	7595.00
<b>TOTAL:</b>					<b>\$7,595.00</b>

PAYMENT INFORMATION					
1	AMOUNT:	7595.00	POSTMARKED:	N/A	
	TYPE:	CHECK	RECEIVED:	08/29/2014	
	CHECK NO:	1036888798			
	NAME:	HEISLER, CLARENCE PO BOX 937 GLOBE AZ 85502-0937 US			

REMARKS	

This receipt was generated by the automated BLM Collections and Billing System and is a paper representation of a portion of the official electronic record contained therein.

336106  
~~356003~~  
~~356123~~  
~~356110~~  
**356059**  
 376428  
 401831

**MAINTENANCE FEE PAYMENT**

Claimant Name: CLARENCE HEISLER  
 Address: PO BOX 937  
 City: 61039 State: AZ Zip: 85502  
 Telephone: 602-722-0861  
 E-mail address: \_\_\_\_\_  
 Signature: Clarence Heisler

RECEIVED  
 BLM AZ STATE OFFICE  
 2013 AUG 21 P 3:40  
 PHOENIX, ARIZONA  
 BLM  
 Date  
 Stamp

Check here if this is a change of address.

LINE NO.	AMC NUMBER	CLAIM/SITE NAME	COUNTY RECORDER DATA (If available)	TWP	RNG	SEC
1	356-003	Blue Rock 20				
2	004	21				
3	005	22				
4	059	23				
5	060	24				
6	061	25				
7	062	26				
8	063	27				
9	064	28				
10	065	29				

List additional claims on Form MCF114.

Bureau of Land Management  
 Arizona State Office  
 www.blm.gov/az/

No. of Claims: 49 x \$140 = 6860  
 Check No: 1244 Init. SC  
 Receipt No.: 2866762  
 For BLM Use Only

Form: MCF112  
 Revised July 2009

This form is available from the Arizona Department of Mines and Mineral Resources and may be reproduced.

ENTERED  
 SEP - 3 2013  
 BY: RE

**SUPPLEMENTAL ATTACHMENT**

May be used with the following forms for listing additional mining claims:

Check One.

- Affidavit of Performance of Annual Work
- Maintenance Fee Payment
- Notice of Intent to Hold Mining Claims
- Notice of Non-Liability for Labor and Materials Furnished

BLM  
Date  
Stamp

2013 AUG 27 P 3:40  
 PHOENIX, ARIZONA  
 OFFICE  
 BLM RECEIVED

wrong #  
336106 to 336110  
wrong #  
wrong Amc  
notified by phone on 10/30/13 2m

LINE NO.	AMC NUMBER	CLAIM/SITE NAME	COUNTY RECORDER DATA (If available)	TWP	RNG	SEC
11	<del>336106</del> 336106	Blorrock 1				
12	<del>336107</del> 107					2
13	108					3
14	109					4
15	110					5
16	<del>336114</del> 114					9
17	<del>336116</del> 116					11
18	<del>336121</del> 121					16
19	066					30
20	067					31
21	068					32
22	069					33
23	070					34
24	071					35
25	072					36
26	073					37
27	074					38
28	075					39
29	123					40

19/50

Form MCF114  
Revised June 2005

This form is available from the Arizona Department of Mines & Mineral Resources and may be reproduced.



**SUPPLEMENTAL ATTACHMENT**

May be used with the following forms for listing additional mining claims:

Check One.

- Affidavit of Performance of Annual Work
- Maintenance Fee Payment
- Notice of Intent to Hold Mining Claims
- Notice of Non-Liability for Labor and Materials Furnished

BLM  
Date  
Stamp

PHOENIX, ARIZONA  
 2013 AUG 27 P 3:41  
 RECEIVED STATE OFFICE

LINE NO.	AMC NUMBER	CLAIM/SITE NAME	COUNTY RECORDER DATA (if available)	TWP	RNG	SEC
30	356124					
31	125					
32	126					
33	127					
34	128					
35	129					
36	130					
37	131					
38	132					
39	133					
40	134					
41	135					
42	136					
43	137					
44	376428					
45	429					
46	430					
47	431					
48	432					

19/60

Form MCF114  
Revised June 2005



**United States Department of the Interior**  
**Bureau of Land Management**  
 LANDS/RECREATION & PLANNING  
 ONE N CENTRAL AVE  
 PHOENIX, AZ 85004 -2203  
 Phone: 602-417-9200

Receipt

No: 2866762

<b>Transaction #:</b> 2952691	
<b>Date of Transaction:</b> 08/27/2013	
<b>CUSTOMER:</b>	
CLARENCE HEISLER PO BOX 1169 FLORENCE, AZ 85232-1169 US	

LINE #	QTY	DESCRIPTION	REMARKS	UNIT PRICE	TOTAL
1	1.00	LOCATABLE MINERALS / MINING CLAIMS- NOT NEW-UNADJUD, ONE AUTH NO. ONLY / MINING CLAIM MONEY RECEIVED CASES: AMC356003/\$6860.00	MAINT (49) 2014	- n/a -	6860.00
<b>TOTAL:</b>					<b>\$6,860.00</b>

PAYMENT INFORMATION			
1	AMOUNT:	6860.00	POSTMARKED: N/A
	TYPE:	CHECK	RECEIVED: 08/27/2013
	CHECK NO:	1244	
	NAME:	RED HILLS MINING LLC PO BOX 1169 FLORENCE AZ 85232-1169 US	

<b>REMARKS</b>

This receipt was generated by the automated BLM Collections and Billing System and is a paper representation of a portion of the official electronic record contained therein.



Amc 356003  
 356059  
 356123  
 401831  
 Amc 336106  
 376428

**MAINTENANCE FEE PAYMENT**

Claimant Name: CLARENCE HEISLER  
 Address: PO BOX 937  
 City: 61032 State: AZ Zip: 85502  
 Telephone: 602-722-0861  
 E-mail address:  
 Signature: Clarence Heisler

RECEIVED  
 BLM AZ STATE OFFICE  
 2012 AUG 27 A 11:57  
 PHOENIX, ARIZONA  
 BLM  
 Date  
 Stamp

Check here if this is a change of address.

LINE NO.	AMC NUMBER	CLAIM/SITE NAME	COUNTY RECORDER DATA (If available)	TWP	RNG	SEC
1	356003	Bluerock 20				
2	004	21				
3	005	22				
4	059	23				
5	060	24				
6	061	25				
7	062	26				
8	063	27				
9	064	28				
10	065	29				

List additional claims on Form MCF114.

Bureau of Land Management  
 Arizona State Office  
[www.az.blm.gov](http://www.az.blm.gov)

No. of Claims: 49 x \$140 6,860  
 Check No: 1240 Init. HMC  
 Receipt No.: 2641176  
 For BLM Use Only

Form: MCF112  
 Revised July 2005

This form is available from the Arizona Department of Mines and Mineral Resources and may be reproduced.

9/7/2012 TS  
 ENTERED INTO COMPUTER

**SUPPLEMENTAL ATTACHMENT**

May be used with the following forms for listing additional mining claims:

Check One.

- Affidavit of Performance of Annual Work
- Maintenance Fee Payment
- Notice of Intent to Hold Mining Claims
- Notice of Non-Liability for Labor and Materials Furnished

RECEIVED  
BLM AZ STATE OFFICE  
2012 AUG 27 A 11:57  
PHOENIX, ARIZONA

BLM  
Date  
Stamp

LINE NO.	AMC NUMBER	CLAIM/SITE NAME	COUNTY RECORDER DATA (If available)	TWP	RNG	SEC
11	336106	Bluerock 1				
12	107	2				
13	108	3				
14	109	4				
15	110	5				
16	114	9				
17	116	11				
18	121	16				
19	356066	Bluerock 30				
20	067	31				
21	068	32				
22	069	33				
23	070	34				
24	071	35				
25	072	36				
26	073	37				
27	074	38				
28	075	39				
29	356123	40				

Form MCF114  
Revised June 2005

This form is available from the Arizona Department of Mines & Mineral Resources and may be reproduced.

**SUPPLEMENTAL ATTACHMENT**

May be used with the following forms for listing additional mining claims:

Check One.

- Affidavit of Performance of Annual Work
- Maintenance Fee Payment
- Notice of Intent to Hold Mining Claims
- Notice of Non-Liability for Labor and Materials Furnished

RECEIVED  
BLM AZ STATE OFFICE  
2012 AUG 21 A 11:57  
PHOENIX, ARIZONA

BLM  
Date  
Stamp

LINE NO.	AMC NUMBER	CLAIM/SITE NAME	COUNTY RECORDER DATA (If available)	TWP	RNG	SEC
30	386124					
31	129					
32	126					
33	127					
34	128					
35	129					
36	130					
37	131					
38	132					
39	133					
40	134					
41	135					
42	136					
43	137					
44	376428					
45	429					
46	430					
47	431					
48	432					

Form MCF114  
Revised June 2005





United States Department of the Interior  
 Bureau of Land Management  
 LANDS/RECREATION & PLANNING  
 ONE N CENTRAL AVE  
 PHOENIX, AZ 85004 -2203  
 Phone: 602-417-9200



Receipt

No:

2641176

<b>Transaction #:</b> 2721815	
<b>Date of Transaction:</b> 08/27/2012	
<b>CUSTOMER:</b>	
RED HILLS MINING LLC PO BOX 1169 FLORENCE, AZ 85132-3024 US	

LINE #	QTY	DESCRIPTION	REMARKS	UNIT PRICE	TOTAL
1	1.00	LOCATABLE MINERALS / MINING CLAIMS-NOT NEW-UNADJUD, ONE AUTH NO. ONLY / MINING CLAIM MONEY RECEIVED <b>CASES: AMC356003/\$6860.00</b>	MAINT 2013/49	- n/a -	6860.00
<b>TOTAL:</b>					<b>\$6,860.00</b>

PAYMENT INFORMATION			
1	AMOUNT:	6860.00	POSTMARKED: N/A
	TYPE:	CHECK	RECEIVED: 08/27/2012
	CHECK NO:	1240	
	NAME:	RED HILLS MINING LLC PO BOX 1169 FLORENCE AZ 85132-3024 US	

REMARKS

This receipt was generated by the automated BLM Collections and Billing System and is a paper representation of a portion of the official electronic record contained therein.

**DEPARTMENT OF THE INTERIOR  
BUREAU OF LAND MANAGEMENT**

**MINING CLAIMS**

**MC Customer Information - With Serial No. and Claim Name**

**ACTIVE CLAIMS**

Run Date: 09/07/2012 11:52 AM

Page 1 of 1

Admin State: AZ

Geo State: AZ

RED HILLS MINING LLC  
4101 E TAMAYA ST  
PHOENIX, AZ 85044-15

CUSTOMER ID: 2126781

<u>Serial No.</u>	<u>Claim Name/Number</u>	<u>Lead Serial No.</u>	<u>Disposition</u>
AMC356003	BLUEROCK 20	AMC356003	ACTIVE
AMC356004	BLUEROCK 21	AMC356003	ACTIVE
AMC356005	BLUEROCK 22	AMC356003	ACTIVE
AMC356059	BLUEROCK 23	AMC356059	ACTIVE
AMC356060	BLUEROCK 24	AMC356059	ACTIVE
AMC356061	BLUEROCK 25	AMC356059	ACTIVE
AMC356062	BLUEROCK 26	AMC356059	ACTIVE
AMC356063	BLUEROCK 27	AMC356059	ACTIVE
AMC356064	BLUEROCK 28	AMC356059	ACTIVE
AMC356065	BLUEROCK 29	AMC356059	ACTIVE
AMC356066	BLUEROCK 30	AMC356059	ACTIVE
AMC356067	BLUEROCK 31	AMC356059	ACTIVE
AMC356068	BLUEROCK 32	AMC356059	ACTIVE
AMC356069	BLUEROCK 33	AMC356059	ACTIVE
AMC356070	BLUEROCK 34	AMC356059	ACTIVE
AMC356071	BLUEROCK 35	AMC356059	ACTIVE
AMC356072	BLUEROCK 36	AMC356059	ACTIVE
AMC356073	BLUEROCK 37	AMC356059	ACTIVE
AMC356074	BLUEROCK 38	AMC356059	ACTIVE
AMC356075	BLUEROCK 39	AMC356059	ACTIVE
AMC356123	BLUEROCK 40	AMC356123	ACTIVE
AMC356124	BLUEROCK 41	AMC356123	ACTIVE
AMC356125	BLUEROCK 42	AMC356123	ACTIVE
AMC356126	BLUEROCK 43	AMC356123	ACTIVE
AMC356127	BLUEROCK 44	AMC356123	ACTIVE
AMC356128	BLUEROCK 45	AMC356123	ACTIVE
AMC356129	BLUEROCK 46	AMC356123	ACTIVE
AMC356130	BLUEROCK 47	AMC356123	ACTIVE
AMC356131	BLUEROCK 48	AMC356123	ACTIVE
AMC356132	BLUEROCK 49	AMC356123	ACTIVE
AMC356133	BLUEROCK 50	AMC356123	ACTIVE
AMC356134	BLUEROCK 51	AMC356123	ACTIVE
AMC356135	BLUEROCK 52	AMC356123	ACTIVE
AMC356136	BLUEROCK 53	AMC356123	ACTIVE
AMC356137	BLUEROCK 54	AMC356123	ACTIVE

Number of ACTIVE cases: 35

RED HILLS MINING LLC  
PO BOX 1169  
FLORENCE, AZ 85132-3

CUSTOMER ID: 2304165

<u>Serial No.</u>	<u>Claim Name/Number</u>	<u>Lead Serial No.</u>	<u>Disposition</u>
AMC401831	BLUE ROCK NUMBER 14	AMC401831	ACTIVE

Number of ACTIVE cases: 1

AMC 356003

356059

356123

336106

376428

401831

ENTERED INTO COMPUTER

AUG 30 2011

MAINTENANCE FEE PAYMENT

Claimant Name: CLARENCE HEISLER

Address: PO BOX 1169

City: Florence State: AZ Zip: 85232

Telephone: 602-722-0861

E-mail address:

Signature: Clarence Heisler

Check here if this is a change of address.

RECEIVED  
BLM AT STATE OFFICE  
PHOENIX, ARIZONA  
2011 AUG 25 P 2:08  
BLM  
Date  
Stamp

LINE NO.	AMC NUMBER	CLAIM/SITE NAME	COUNTY RECORDER DATA (if available)	TWP	RNG	SEC
1	356003	Blue Rock 20				
2	004	21				
3	005	22				
4	059	23				
5	060	24				
6	061	25				
7	062	26				
8	063	27				
9	064	28				
10	065	29				

List additional claims on Form MCF114.

Bureau of Land Management  
Arizona State Office  
www.az.blm.gov

No. of Claims: 49 ~~x \$125 =~~ 6,860  
Check No: 1237 Init. [Signature]  
Receipt No.: 2415583  
For BLM Use Only

Form: MCF112  
Revised July 2005

This form is available from the Arizona Department of Mines and Mineral Resources and may be reproduced.

AUG 30 2011

SUPPLEMENTAL ATTACHMENT

May be used with the following forms for listing additional mining claims:

Check One.

- Affidavit of Performance of Annual Work
- Maintenance Fee Payment
- Notice of Intent to Hold Mining Claims
- Notice of Non-Liability for Labor and Materials Furnished

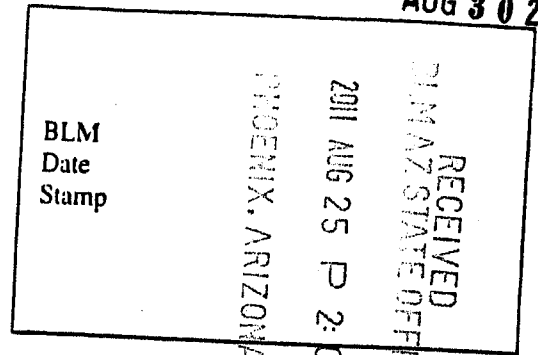

LINE NO.	AMC NUMBER	CLAIM/SITE NAME	COUNTY RECORDER DATA (If available)	TWP	RNG	SEC
30	356124					
31	125					
32	126					
33	127					
34	128					
35	129					
36	130					
37	131					
38	132					
39	133					
40	134					
41	135					
42	136					
43	137					
44	376-428					
45	429					
46	430					
47	431					
48	432					

Form MCF114  
Revised June 2005



United States Department of the Interior  
 Bureau of Land Management  
 LANDS/RECREATION & PLANNING  
 ONE N CENTRAL AVE  
 PHOENIX, AZ 85004 -2203  
 Phone: 602-417-9200

Receipt

No: 2415583

Transaction #: 2490960		<b>ENTERED INTO COMPUTER</b> AUG 30 2011 <i>WZ</i>
Date of Transaction: 08/25/2011		
CUSTOMER:		
RED HILLS MINING LLC PO BOX 1169 FLORENCE, AZ 85132-3024 US		

LINE #	QTY	DESCRIPTION	REMARKS	UNIT PRICE	TOTAL
1	1.00	LOCATABLE MINERALS / MINING CLAIMS-NOT NEW-UNADJUD, ONE AUTH NO. ONLY / MINING CLAIM MONEY RECEIVED CASES: AMC356009/\$6860.00	MAINT 2012/49	- n/a -	6860.00
<b>TOTAL:</b>					<b>\$6,860.00</b>

PAYMENT INFORMATION					
1	AMOUNT:	6860.00	POSTMARKED:	N/A	
	TYPE:	CHECK	RECEIVED:	08/25/2011	
	CHECK NO:	1237			
	NAME:	RED HILLS MINING LLC PO BOX 1169 FLORENCE AZ 85132-3024 US			

REMARKS

This receipt was generated by the automated BLM Collections and Billing System and is a paper representation of a portion of the official electronic record contained therein.

AMC 356003  
 AMC 356059  
 AMC 356123  
 AMC 376428  
 AMC 336106

**MAINTENANCE FEE PAYMENT**

Claimant Name: CLARENCE B HEISLER  
 Address: PO BOX 1169  
 City: FLORENCE State: AZ Zip: 85232  
 Telephone: 602-722-0861  
 E-mail address: \_\_\_\_\_  
 Signature: Clarence B Heisler

Check here if this is a change of address.

RECEIVED  
 BLM AZ STATE OFFICE  
 2010 AUG 12 A 11:09  
 PHOENIX, ARIZONA  
 BLM  
 Date  
 Stamp

LINE NO.	AMC NUMBER	CLAIM/SITE NAME	COUNTY RECORDER DATA (If available)	TWP	RNG	SEC
1	356-003	BLUEROCK 20				
2	004	21				
3	005	22				
4	059	23				
5	060	24				
6	061	25				
7	062	26				
8	063	27				
9	064	28				
10	065	29				

10/50

List additional claims on Form MCF114.

Bureau of Land Management  
 Arizona State Office  
[www.az.blm.gov](http://www.az.blm.gov)

No. of Claims: 48 x \$125 = 6720.  
 Check No: 1231 Init. 140 SC  
 Receipt No.: 2189460  
 For BLM Use Only

**SUPPLEMENTAL ATTACHMENT**

May be used with the following forms for listing additional mining claims:

Check One.

- Affidavit of Performance of Annual Work
- Maintenance Fee Payment
- Notice of Intent to Hold Mining Claims
- Notice of Non-Liability for Labor and Materials Furnished

RECEIVED  
BLM AZ STATE OFFICE  
2010 AUG 12 A 11:09  
PHOENIX, ARIZONA

BLM  
Date  
Stamp

LINE NO.	AMC NUMBER	CLAIM/SITE NAME	COUNTY RECORDER DATA (If available)	TWP	RNG	SEC
	356124	Blue rock	41			
	125		42			
	126		43			
	127		44			
	128		45			
	129		46			
	130		47			
	131		48			
	132		49			
	133		50			
	134		51			
	135		52			
	136		53			
	137		54			
	376428		55			
	429		56			
	430		57			
	431		58			
	432		59			

19/50

Form MCF114  
Revised June 2005

**SUPPLEMENTAL ATTACHMENT**

May be used with the following forms for listing additional mining claims:

Check One.

- Affidavit of Performance of Annual Work
- Maintenance Fee Payment
- Notice of Intent to Hold Mining Claims
- Notice of Non-Liability for Labor and Materials Furnished

RECEIVED  
 BLM AZ STATE OFFICE  
 PHOENIX, ARIZONA  
 2000 AUG 12 A 11:09  
 BLM  
 Date  
 Stamp

LINE NO.	AMC NUMBER	CLAIM/SITE NAME	COUNTY RECORDER DATA (If available)	TWP	RNG	SEC
	336/06	BLUEROCK 1				
	107	2				
	108	3				
	109	4				
	110	9				
	114	9				
	116	11				
	121	16				
	356066	BLUEROCK 30				
	067	31				
	068	32				
	069	33				
	070	34				
	071	35				
	072	36				
	073	37				
	074	38				
	075	39				
	356123	40				

19/50

Form MCF114  
Revised June 2005



United States Department of the Interior  
 Bureau of Land Management  
 LANDS/RECREATION & PLANNING  
 ONE N CENTRAL AVE  
 PHOENIX, AZ 85004 -2203  
 Phone:

Receipt

No: 2189460

**ENTERED INTO COMPUTER**

Transaction #: 2259174  
 Date of Transaction: 08/12/2010

CUSTOMER:	CLARENCE HEISLER PO BOX 1169 FLORENCE, AZ 85232-1169 US	AUG 19 2010
-----------	---	-------------

LINE #	QTY	DESCRIPTION	REMARKS	UNIT PRICE	TOTAL
1	1.00	LOCATABLE MINERALS / MINING CLAIMS-NOT NEW-UNADJUD, ONE AUTH NO. ONLY / MINING CLAIM MONEY RECEIVED CASES: AMC356003/\$6720.00	MAINT (48) 2011	- n/a -	6720.00 ✓
<b>TOTAL:</b>					<b>\$6,720.00</b>

PAYMENT INFORMATION					
1	AMOUNT:	6720.00	POSTMARKED:	N/A	
	TYPE:	CHECK	RECEIVED:	08/12/2010	
	CHECK NO:	1231			
	NAME:	HEISLER, CLARENCE PO BOX 1169 FLORENCE AZ 85232-1169 US			

REMARKS

This receipt was generated by the automated BLM Collections and Billing System and is a paper representation of a portion of the official electronic record contained therein.

AMC 356003  
 356059  
 356123  
 376428  
 336186

**MAINTENANCE FEE PAYMENT**

Claimant Name: CLARENCE HEISLER  
 Address: PO BOX 1169  
 City: FLORENCE State: AZ Zip: 85232  
 Telephone: 602-722-0861  
 E-mail address: \_\_\_\_\_  
 Signature: Clarence Heisler

Check here if this is a change of address.

RECEIVED  
 MARAZ STATE OFFICE  
 2009 JUL -9 P 1:16  
 PHOENIX, ARIZONA  
 BLM  
 Date  
 Stamp

LINE NO.	AMC NUMBER	CLAIM/SITE NAME	COUNTY RECORDER DATA (If available)	TWP	RNG	SEC
1	L 356-003	BLUEROCK 20				
2	004	21				
3	005	22				
4	L 059	23				
5	060	24				
6	061	25				
7	062	26				
8	063	27				
9	064	28				
10	065	29				

List additional claims on Form MCF114.

Bureau of Land Management  
 Arizona State Office  
[www.az.blm.gov](http://www.az.blm.gov)

No. of Claims: 48 x \$125 = 6,000  
 Check No: 1326 Init. SC  
 Receipt No.: 1954309  
 For BLM Use Only

Form: MCF112  
 Revised July 2005

This form is available from the Arizona Department of Mines and Mineral Resources and may be reproduced.

ENTERED INTO COMPUTER

7/23/09 RJJ

**SUPPLEMENTAL ATTACHMENT**

May be used with the following forms for listing additional mining claims:

Check One.

- Affidavit of Performance of Annual Work
- Maintenance Fee Payment
- Notice of Intent to Hold Mining Claims
- Notice of Non-Liability for Labor and Materials Furnished

RECEIVED  
 ARIZONA STATE OFFICE  
 2009 JUL - 9 P 1:16  
 PHOENIX, ARIZONA  
 BLM  
 Date  
 Stamp

LINE NO.	AMC NUMBER	CLAIM/SITE NAME	COUNTY RECORDER DATA (If available)	TWP	RNG	SEC
L	336106	BLUEROCK 1				
	107	2				
	108	3				
	109	4				
	110	5				
	114	9				
	116	11				
	121	16				
	356 066	BLUEROCK 30				
	067	31				
	068	32				
	069	33				
	070	34				
	071	35				
	072	36				
	073	37				
	074	38				
	075	39				
L	356123	40				

Form MCF114  
 Revised June 2005

**SUPPLEMENTAL ATTACHMENT**

May be used with the following forms for listing additional mining claims:

Check One.

- Affidavit of Performance of Annual Work
- Maintenance Fee Payment
- Notice of Intent to Hold Mining Claims
- Notice of Non-Liability for Labor and Materials Furnished

RECEIVED  
BLM ARIZONA STATE OFFICE  
2009 JUL -9 P 1:16  
PHOENIX, ARIZONA

BLM  
Date  
Stamp

LINE NO.	AMC NUMBER	CLAIM/SITE NAME	COUNTY RECORDER DATA (If available)	TWP	RNG	SEC
	356124					
	125					
	126					
	127					
	128					
	129					
	130					
	131					
	132					
	133					
	134					
	135					
	136					
	137					
L	376428					
	429					
	430					
	431					
	432					

**Form MCF114**  
Revised June 2005



**United States Department of the Interior**

**Bureau of Land Management**  
 BUSINESS & SUPPORT SVCS DIV  
 ONE N CENTRAL AVE SUITE 800  
 PHOENIX, AZ 85004 -4427  
 Phone: (602) 417-9200

Receipt

No: 1954309

<b>Transaction #:</b> 2017904	
<b>Date of Transaction:</b> 07/09/2009	
<b>CUSTOMER:</b>	CLARENCE HEISLER PO BOX 1169 FLORENCE, AZ 85232-1169 US

LINE #	QTY	DESCRIPTION	REMARKS	UNIT PRICE	TOTAL
1	1.00	LOCATABLE MINERALS / MINING CLAIMS-NOT NEW-UNADJUD, ONE AUTH NO. ONLY / MINING CLAIM MONEY RECEIVED CASES: AMC356003/\$6720.00	MAINT 2010 (48)	- n/a -	6720.00
<b>TOTAL:</b>					<b>\$6,720.00</b>

PAYMENT INFORMATION					
1	AMOUNT:	6720.00	POSTMARKED:	N/A	
	TYPE:	CHECK	RECEIVED:	07/09/2009	
	CHECK NO:	1226			
	NAME:	HEISLER, CLARENCE PO BOX 1169 FLORENCE AZ 85232-1169 US			

REMARKS

This receipt was generated by the automated BLM Collections and Billing System and is a paper representation of a portion of the official electronic record contained therein.

Amc 356003  
 Amc 356123  
 Amc 376428  
 Amc 336106  
 Amc 356059

**MAINTENANCE FEE PAYMENT**

Claimant Name: CLARENSE HEDER  
 Address: PO BOX 1169  
 City: Florence State: AZ Zip: 85232  
 Telephone: 602-722-0861  
 E-mail address: \_\_\_\_\_  
 Signature: Clarence Heder

Check here if this is a change of address.

RECEIVED  
 BLM AZ STATE OFFICE  
 2008 AUG 27 A 11:03  
 PHOENIX, ARIZONA  
 BLM  
 Date  
 Stamp

LINE NO.	AMC NUMBER	CLAIM/SITE NAME	COUNTY RECORDER DATA (If available)	TWP	RNG	SEC
1	356-003	Bluerock 20				
2	004	21				
3	005	22				
4	009	23				
5	060	24				
6	061	25				
7	062	26				
8	063	27				
9	064	28				
10	065	29				

List additional claims on Form MCF114.

Bureau of Land Management  
 Arizona State Office  
[www.az.blm.gov](http://www.az.blm.gov)

No. of Claims: 48 x \$125 = 6,000.  
 Check No: 1219 Init. SC  
 Receipt No.: 1772539  
 For BLM Use Only

Form: MCF112  
 Revised July 2005

This form is available from the Arizona Department of Mines and Mineral Resources and may be reproduced.

ENTERED INTO COMPUTER  
 SEP 16 '08

10/10

**SUPPLEMENTAL ATTACHMENT**

May be used with the following forms for listing additional mining claims:

Check One.

- Affidavit of Performance of Annual Work
- Maintenance Fee Payment
- Notice of Intent to Hold Mining Claims
- Notice of Non-Liability for Labor and Materials Furnished

BLM  
Date  
Stamp

RECEIVED  
BLM AZ STATE OFFICE  
2008 AUG 27 AM 11:03  
PHOENIX, ARIZONA

LINE NO.	AMC NUMBER	CLAIM/SITE NAME	COUNTY RECORDER DATA (If available)	TWP	RANGE	SEC
	336106	BLUEROCK 1				
	107	2				
	108	3				
	109	4				
	110	5				
	114	9				
	116	11				
	121	16				
	356066	BLUEROCK 30				
	067	31				
	068	32				
	069	33				
	070	34				
	071	35				
	072	36				
	073	37				
	074	38				
	075	39				
	356123	40				

Form MCF114  
Revised June 2005

This form is available from the Arizona Department of Mines & Mineral Resources and may be reproduced.

19/24

**SUPPLEMENTAL ATTACHMENT**

May be used with the following forms for listing additional mining claims:

Check One.

- Affidavit of Performance of Annual Work
- Maintenance Fee Payment
- Notice of Intent to Hold Mining Claims
- Notice of Non-Liability for Labor and Materials Furnished

RECEIVED  
BLM AZ STATE OFFICE  
2008 AUG 27 A 11:08  
PHOENIX, ARIZONA

BLM  
Date  
Stamp

LINE NO.	AMC NUMBER	CLAIM/SITE NAME	COUNTY RECORDER DATA (If available)	TWP	RNG	SEC
	396124	Bluerock 41				
	125	42				
	126	43				
	127	44				
	128	45				
	129	46				
	130	47				
	131	48				
	132	49				
	133	50				
	134	51				
	135	52				
	136	53				
	137	54				
	376428	55				
	429	56				
	430	57				
	431	58				
	432	59				

Form MCF114  
Revised June 2005

This form is available from the Arizona Department of Mines & Mineral Resources and may be reproduced.

19/5



**United States Department of the Interior**

**Bureau of Land Management**

BUSINESS & SUPPORT SVCS DIV

ONE N CENTRAL AVE SUITE 800

PHOENIX, AZ 85004 -4427

Phone: (602) 417-9200

Receipt

No:

1772539

<b>Transaction #:</b> 1830261	
<b>Date of Transaction:</b> 08/27/2008	
<b>CUSTOMER:</b>	CLARENCE HEISLER PO BOX 1169 FLORENCE, AZ 85232

LINE #	QTY	DESCRIPTION	REMARKS	UNIT PRICE	TOTAL
1	1.00	LOCATABLE MINERALS / MINING CLAIMS-NOT NEW-UNADJUD, ONE AUTH NO. ONLY / MINING CLAIM MONEY RECEIVED (455) CASES: AMC356003/\$6000.00	MAINT 2009 (48)	- n/a -	6000.00
<b>TOTAL:</b>					<b>\$6,000.00</b>

PAYMENT INFORMATION					
1	AMOUNT:	\$6,000.00	POSTMARKED:	N/A	
	TYPE:	CHECK	RECEIVED:	08/27/2008	
	CHECK NO:	1219			
	NAME:	HEISLER, CLARENCE PO BOX 1169 FLORENCE AZ 85232			

REMARKS

This receipt was generated by the automated BLM Collections and Billing System and is a paper representation of a portion of the official electronic record contained therein.

AMC 356003  
 AMC 356059  
 AMC 336106  
 AMC 356123  
 AMC 376428

**MAINTENANCE FEE PAYMENT**

Claimant Name: CLARENE HEISLER  
 Address: PO BOX 1169  
 City: Florence State: AZ Zip: 85232  
 Telephone: 602 722 0861  
 E-mail address: \_\_\_\_\_  
 Signature: Clarene Heisler

RECEIVED  
 BLM, AZ STATE OFFICE  
 2001 AUG 28 P 2:17  
 PHOENIX, ARIZONA  
 BLM  
 Date  
 Stamp

Check here if this is a change of address.

LINE NO.	AMC NUMBER	CLAIM/SITE NAME	COUNTY RECORDER DATA (If available)	TWP	RNG	SEC
1	356066	Blosserch 30				
2	067	31				
3	68	32				
4	69	33				
5	70	34				
6	71	35				
7	72	36				
8	73	37				
9	74	38				
10	75	39				

List additional claims on Form MCF114.

Bureau of Land Management  
 Arizona State Office  
[www.az.blm.gov](http://www.az.blm.gov)

No. of Claims: 48 x \$125 = 6000.00  
 Check No: 1197 Init. EHG  
 Receipt No.: 1555434  
 For BLM Use Only

Form: MCF112  
 Revised July 2005

This form is available from the Arizona Department of Mines and Mineral Resources and may be reproduced.

RE 9/20/07

**MAINTENANCE FEE PAYMENT**

Claimant Name: CLARENCE HEUSER/REDHILLS  
 Address: PO BOX 1169  
 City: FLORENCE State: AZ Zip: 85232  
 Telephone: 602722-0861 - 928-425-3812  
 E-mail address: \_\_\_\_\_  
 Signature: Clarence Heuser

Check here if this is a change of address.

RECEIVED  
 BLM, AZ STATE OFFICE  
 2001 AUG 28 P 2: 17  
 PHOENIX, ARIZONA  
 BLM  
 Date  
 Stamp

LINE NO.	AMC NUMBER	CLAIM/SITE NAME	COUNTY RECORDER DATA (If available)	TWP	RNG	SEC
1	356123	Blue Rock 40				
2	124	41				
3	125	42				
4	126	43				
5	127	44				
6	128	45				
7	129	46				
8	130	47				
9	131	48				
10	132	49				

10  
 5/16

List additional claims on Form MCF114.

No. of Claims: \_\_\_\_\_ x \$125 = \_\_\_\_\_  
 Check No: \_\_\_\_\_ Init. \_\_\_\_\_  
 Receipt No.: \_\_\_\_\_  
**For BLM Use Only**

**Bureau of Land Management**  
**Arizona State Office**  
[www.az.blm.gov](http://www.az.blm.gov)

**Form: MCF112**  
 Revised July 2005

This form is available from the **Arizona Department of Mines and Mineral Resources** and may be reproduced.

**SUPPLEMENTAL ATTACHMENT**

May be used with the following forms for listing additional mining claims:

Check One.

- Affidavit of Performance of Annual Work
- Maintenance Fee Payment
- Notice of Intent to Hold Mining Claims
- Notice of Non-Liability for Labor and Materials Furnished

RECEIVED  
BLM AZ STATE OFFICE  
PHOENIX, ARIZONA  
2007 AUG 28 P 2:17

BLM  
Date  
Stamp

LINE NO.	AMC NUMBER	CLAIM/SITE NAME	COUNTY RECORDER DATA (If available)	TWP	RNG	SEC
	356003	Bluerock 20				
	04	21				
	05	22				
	059	23				
	060	24				
	061	25				
	062	26				
	063	27				
	064	28				
	065	29				
	336106	1				
	336107	2				
	336108	3				
	336109	4				
	336110	5				
	336114	9				
	336116	11				
	336121	16				

1824

**Form MCF114**  
Revised June 2005

This form is available from the **Arizona Department of Mines & Mineral Resources** and may be reproduced.





**United States Department of the Interior**  
**Bureau of Land Management**  
 BUSINESS & SUPPORT SVCS DIV  
 ONE N CENTRAL AVE SUITE 800  
 PHOENIX, AZ 85004 -4427  
 Phone: (602) 417-9200

Receipt

No: 1555434

Transaction #: 1606998	
Date of Transaction: 08/28/2007	
CUSTOMER:	RED HILLS MINING LLC P. O. BOX 1169 FLORENCE, AZ 85232

LINE #	QTY	DESCRIPTION	REMARKS	UNIT PRICE	TOTAL
1	1.00	LOCATABLE MINERALS / MINING CLAIMS- NOT NEW-UNADJUD, ONE AUTH NO. ONLY / MINING CLAIM MONEY RECEIVED (455) CASES: AMC356066/\$6000.00	MAINT 2008 (48)	- n/a -	6000.00
<b>TOTAL:</b>					<b>\$6,000.00</b>

PAYMENT INFORMATION			
1	AMOUNT:	\$6,000.00	POSTMARKED: N/A
	TYPE:	CHECK	RECEIVED: 08/28/2007
	CHECK NO:	1197	
	NAME:	RED HILLS MINING LLC P. O. BOX 1169 FLORENCE AZ 85232	

REMARKS

This receipt was generated by the automated BLM Collections and Billing System and is a paper representation of a portion of the official electronic record contained therein.

*RS 9/20/07*

AMC 356123

356059

356003

336106

**MAINTENANCE FEE PAYMENT**

Claimant Name: CLARK WELSER / RED HILLS

Address: PO BOX 41169

City: Florence State: AZ Zip: 85232

Telephone: 602-722-0861

E-mail address: \_\_\_\_\_

Signature: [Signature]

Check here if this is a change of address.

RECEIVED  
BLM, AZ STATE OFFICE  
2006 AUG 15 P 2:33  
PHOENIX, AZ  
BLM  
Date  
Stamp

LINE NO.	AMC NUMBER	CLAIM/SITE NAME	COUNTY RECORDER DATA (If available)	TWP	RNG	SEC
1	356123	BlueRock 40				
2	124	41				
3	125	42				
4	126	43				
5	127	44				
6	128	45				
7	129	46				
8	130	47				
9	131	48				
10	132	49				

List additional claims on Form MCF114.

Bureau of Land Management  
Arizona State Office  
[www.az.blm.gov](http://www.az.blm.gov)

No. of Claims: 15 x \$125 = 1875.  
 Check No: 1188 Init. [Signature]  
 Receipt No.: 1335033  
 For BLM Use Only

Form: MCF112  
Revised July 2005

This form is available from the Arizona Department of Mines and Mineral Resources and may be reproduced.

RE 8/21/06

ENTERED COMPUTER





**MAINTENANCE FEE PAYMENT**

Claimant Name: CLARKWEISER  
 Address: PO Box 1169  
 City: Florence State: AZ Zip: 85232  
 Telephone: 6027220861  
 E-mail address: \_\_\_\_\_  
 Signature: Clark

RECEIVED  
 BLM, AZ STATE OFFICE  
 2006 AUG 15 P 2:33  
 PHOENIX, AZ  
 BLM  
 Date  
 Stamp

Check here if this is a change of address.

LINE NO.	AMC NUMBER	CLAIM/SITE NAME	COUNTY RECORDER DATA (If available)	TWP	RNG	SEC
1	386066	Bloss Rock 30				
2	067	31				
3	68	32				
4	69	33				
5	70	34				
6	71	35				
7	72	36				
8	73	37				
9	74	38				
10	75	39				

List additional claims on Form MCF114.

Bureau of Land Management  
 Arizona State Office  
[www.az.blm.gov](http://www.az.blm.gov)

No. of Claims: 28 x \$125 = 3500.00  
 Check No: 1188 Init. TES  
 Receipt No.: 1335033  
 For BLM Use Only

Form: MCF112  
 Revised July 2005

This form is available from the Arizona Department of Mines and Mineral Resources and may be reproduced.

**SUPPLEMENTAL ATTACHMENT**

May be used with the following forms for listing additional mining claims:

Check One.

- Affidavit of Performance of Annual Work
- Maintenance Fee Payment
- Notice of Intent to Hold Mining Claims
- Notice of Non-Liability for Labor and Materials Furnished

RECEIVED  
BLM, AZ STATE OFFICE  
2006 AUG 15 P 2:53  
PHOENIX, AZ  
BLM  
Date  
Stamp

LINE NO.	AMC NUMBER	CLAIM/SITE NAME	COUNTY RECORDER DATA (If available)	TWP	RNG	SEC
	356003	Blue Rock 20				
	04	21				
	05	22				
	059	23				
	060	24				
	061	25				
	062	26				
	063	27				
	064	28				
	065	29				
	336106	1				
	336107	2				
	336108	3				
	336109	4				
	336110	5				
	336114	9				
	336116	11				
	336121	16				

**Form MCF114**  
Revised June 2005

This form is available from the Arizona Department of Mines & Mineral Resources and may be reproduced.

**United States Department of the Interior**  
**Bureau of Land Management**  
 BUSINESS & SUPPORT SVCS DIV  
 ONE N CENTRAL AVE  
 PHOENIX, AZ 85004 -2203  
 Phone: (602) 417-9200

Receipt

No: 1335033

AMC 356123  
 AMC 356059  
 AMC 356003  
 AMC 336106

<b>Transaction #:</b> 1380139	
<b>Date of Transaction:</b> 08/15/2006	
<b>CUSTOMER:</b>	RED HILLS MINING LLC P. O. BOX 1169 FLORENCE, AZ 85232

LINE #	QTY	DESCRIPTION	REMARKS	UNIT PRICE	TOTAL
1	1.00	LOCATABLE MINERALS / MINING CLAIMS-NOT NEW-UNADJUD, ONE AUTH NO. ONLY / MINING CLAIM MONEY RECEIVED (455) CASES: AMC356123/\$5375.00	MAINT 2007 (43)	- n/a -	5375.00
<b>TOTAL:</b>					<b>\$5,375.00</b>

PAYMENT INFORMATION				
1	AMOUNT:	\$5,375.00	POSTMARKED:	N/A
	TYPE:	CHECK	RECEIVED:	08/15/2006
	CHECK NO:	1188		
	NAME:	RED HILLS MINING LLC P. O. BOX 1169 FLORENCE AZ 85232		

REMARKS

This receipt was generated by the automated BLM Collections and Billing System and is a paper representation of a portion of the official electronic record contained therein.

RE 8/21/06  
 ENT



AMC 336106  
 AMC 356123  
 AMC 356059  
 AMC 356003

**MAINTENANCE FEE PAYMENT**

Claimant Name: Clark Heister Pennington  
 Address: PO Box 1169  
 City: Florence State: AZ Zip: 85232  
 Telephone: 6027220861  
 E-mail address: \_\_\_\_\_  
 Signature: [Signature]

Check here if this is a change of address.

RECEIVED  
 B.L.M. AZ STATE OFFICE  
 2005 AUG 24 P 12:13  
 PHOENIX, ARIZONA  
 BLM  
 Date  
 Stamp

LINE NO.	AMC NUMBER	CLAIM/SITE NAME	COUNTY RECORDER DATA (If available)	TWP	RNG	SEC
1	356123	Bluerock 40				
2	356124	41				
3	356125	42				
4	356126	43				
5	356127	44				
6	356128	45				
7	356129	46				
8	356130	47				
9	356131	48				
10	356132	49				

List additional claims on Form MCF114.

Bureau of Land Management  
 Arizona State Office  
[www.az.blm.gov](http://www.az.blm.gov)

No. of Claims: 10 x \$125 = 1,250  
 Check No: 1176 Init. TMC  
 Receipt No.: 1136368  
 For BLM Use Only

Form: MCF112  
 Revised July 2005

This form is available from the Arizona Department of Mines and Mineral Resources and may be reproduced.

ENTERED IN COMPUTER  
 RE 8/31/05



**MAINTENANCE FEE PAYMENT**

Claimant Name: CLARK HEISLER/REDHILLS  
 Address: PO Box 1169  
 City: Florence State: AZ Zip: 85037  
 Telephone: 6027220861  
 E-mail address: \_\_\_\_\_  
 Signature: Clark Heisler

Check here if this is a change of address.

RECEIVED  
 B.L.M. AZ STATE OFFICE  
 2005 AUG 24 P 12:13  
 PHOENIX, ARIZONA

BLM  
 Date  
 Stamp

LINE NO.	AMC NUMBER	CLAIM/SITE NAME	COUNTY RECORDER DATA (If available)	TWP	RNG	SEC
1	396133	BLUEROCK 50				
2	356134	51				
3	356135	52				
4	356136	53				
5	356137	54				
6						
7						
8						
9						
10						

List additional claims on Form MCF114.

Bureau of Land Management  
 Arizona State Office  
[www.az.blm.gov](http://www.az.blm.gov)

No. of Claims: 5 x \$125 = 625  
 Check No: 1176 Init. YMC  
 Receipt No.: 1136368  
 For BLM Use Only

Form: MCF112  
 Revised July 2005

This form is available from the Arizona Department of Mines and Mineral Resources and may be reproduced.

ENTERED IN COMPUTER  
 RE 8/31/06

**MAINTENANCE FEE PAYMENT**

Claimant Name: Clark Hester  
 Address: PO Box 1169  
 City: Flagstaff State: AZ Zip: 86001  
 Telephone: 602 722 0861  
 E-mail address: \_\_\_\_\_  
 Signature: Clark Hester

Check here if this is a change of address.

RECEIVED  
 B.L.M. AZ STATE OFFICE  
 PHOENIX, ARIZONA  
 2005 AUG 24 P 12:13  
 BLM  
 Date  
 Stamp

LINE NO.	AMC NUMBER	CLAIM/SITE NAME	COUNTY RECORDER DATA (if available)	TWP	RNG	SEC
1	356066	Blue Rock 30				
2	356067	31				
3	356068	32				
4	356069	33				
5	356070	34				
6	356071	35				
7	356072	36				
8	356073	37				
9	356074	38				
10	356075	39				

List additional claims on Form MCF114.

Bureau of Land Management  
 Arizona State Office  
[www.az.blm.gov](http://www.az.blm.gov)

No. of Claims: 10 x \$125 = 1,250  
 Check No: 1176 Init. JMC  
 Receipt No.: 1136368  
 For BLM Use Only

Form: MCF112  
 Revised July 2005

This form is available from the Arizona Department of Mines and Mineral Resources and may be reproduced.

ENTERED IN COMPUTER  
 RE 8/31/06

**MAINTENANCE FEE PAYMENT**

Claimant Name: Clark Heister/REDUITS Mining  
 Address: PO Box 1169  
 City: Florence State: AZ Zip: 85232  
 Telephone: 602 722 0861  
 E-mail address: \_\_\_\_\_  
 Signature: Clark Heister

Check here if this is a change of address.

RECEIVED  
 B.L.M. AZ STATE OFFICE  
 2005 AUG 24 P 12: 3  
 PHOENIX, ARIZONA

BLM  
 Date  
 Stamp

LINE NO.	AMC NUMBER	CLAIM/SITE NAME	COUNTY RECORDER DATA (If available)	TWP	RNG	SEC
1	356003	Blue Rock 20				
2	356004	21				
3	356005	22				
4	356059	23				
5	356060	24				
6	356061	25				
7	356062	26				
8	356063	27				
9	356064	28				
10	356065	29				

List additional claims on Form MCF114.

Bureau of Land Management  
 Arizona State Office  
[www.az.blm.gov](http://www.az.blm.gov)

No. of Claims: 10 x \$125 = 1,250  
 Check No: 1176 Init. JMC  
 Receipt No.: 1136368  
 For BLM Use Only

Form: MCF112  
 Revised July 2005

This form is available from the Arizona Department of Mines and Mineral Resources and may be reproduced.

ENTERED IN COMPUTER  
 RE 8/31/06

**MAINTENANCE FEE PAYMENT**

Claimant Name: CHUCK HEISLER  
 Address: PO BOX 1169  
 City: FLORENCE State: AZ Zip: 85232  
 Telephone: 602 722 0861  
 E-mail address: \_\_\_\_\_  
 Signature: Clark Heisler

Check here if this is a change of address.

RECEIVED  
 B.L.M. AZ STATE OFFICE  
 2005 AUG 24 P 12:13  
 PHOENIX, ARIZONA  
 BLM  
 Date  
 Stamp

LINE NO.	AMC NUMBER	CLAIM/SITE NAME	COUNTY RECORDER DATA (if available)	TWP	RNG	SEC
1	336106	BLUEROCK 1		33	4S	R11E
2	336107	2				
3	336108	3				
4	336109	4				
5	336110	5				
6	336114	9				
7	336116	11				
8	336121	16				
9						
10						

List additional claims on Form MCF114.

Bureau of Land Management  
 Arizona State Office  
[www.az.blm.gov](http://www.az.blm.gov)

No. of Claims: 8 x \$125 = 1,000  
 Check No: 1176 Init. JMC  
 Receipt No.: 1136368  
 For BLM Use Only

Form: MCF112  
 Revised July 2005

This form is available from the Arizona Department of Mines and Mineral Resources and may be reproduced.

ENTERED IN COMPUTER

RE 8/31/06



**United States Department of the Interior**  
**Bureau of Land Management**  
 BUSINESS & SUPPORT SVCS DIV  
 222 N CENTRAL AVE  
 PHOENIX, AZ 85004 -2203  
 Phone: (602) 417-9200

## Receipt

No:

1136368

**Transaction #:** 1175506**Date of Transaction:** 08/24/2005

**CUSTOMER:** RED HILLS MINING LLC  
 P. O. BOX 1169  
 FLORENCE, AZ 85232

LINE #	QTY	DESCRIPTION	REMARKS	UNIT PRICE	TOTAL
1	1.00	LOCATABLE MINERALS / MINING CLAIMS-NOT NEW-UNADJUD, ONE AUTH NO. ONLY / MINING CLAIM MONEY RECEIVED (455) CASES: AMC356123/\$5375.00	MAINT 2006/43	- n/a -	5375.00
<b>TOTAL:</b>					<b>\$5,375.00</b>

## PAYMENT INFORMATION

1	AMOUNT:	\$5,375.00	POSTMARKED:	N/A
	TYPE:	CHECK	RECEIVED:	08/24/2005
	CHECK NO:	1176		
	NAME:	RED HILLS MINING LLC P. O. BOX 1169 FLORENCE AZ 85232		

## REMARKS

This receipt was generated by the automated BLM Collections and Billing System and is a paper representation of a portion of the official electronic record contained therein.

AMC 336106  
 AMC 356123  
 AMC 356059  
 AMC 356003

Sc

**MAINTENANCE FEE PAYMENT**

BUREAU OF LAND MANAGEMENT  
 222 N CENTRAL AVENUE  
 PHOENIX, AZ 85004  
 602-417-9200  
 www.az.blm.gov

Mining Claim Maintenance Fee Payment of \$125 per claim/site is due on or before September 1, 20\_\_\_\_, in lieu of assessment work for the upcoming assessment year beginning September 1 of the year noted above.

RECEIVED  
 B.L.M. AZ STATE OFFICE  
 2004 AUG 30 P 2:38  
 PHOENIX, ARIZONA  
 BLM Date Stamp

AMC NUMBER	CLAIM/SITE NAME	COUNTY RECORDER DATA	SEC	TWP	RNG
356003	Blue Rock 20				
356004	Blue Rock 21				
356005	Blue Rock 22				
356059	Blue Rock 23				
356060	Blue Rock 24				
356061	Blue Rock 25				
356062	Blue Rock 26				
356063	Blue Rock 27				
356064	Blue Rock 28				
356065	Blue Rock 29				

List additional claims on the reverse side of this form.

Check here if this is a change of address.

CLAIMANT NAME: Clark Wesley / Red Hills Mining LLC  
 ADDRESS: PO BOX 1169  
 CITY: FLORENCE STATE: AZ ZIP: 85232  
 PHONE: 602 722 0861  
 SIGNATURE: Clark Wesley

No of Claims: 10 x \$125 = 1250.00  
and 25 x \$125 = 3125.00  
 Check No: 984 Init: EC  
 Receipt No: \_\_\_\_\_  
 FOR BLM USE ONLY

Claimant or agent must sign to record with the County.

FORM APPROVED OMB NO. 1004-0114  
 Expires: December 31, 2006

AZ-3850-2  
 (July 2004)

852 9/29/04 Wesley 10/21/04 Sc





**CONTINUATION SHEET  
MAINTENANCE FEE PAYMENT**

AMC NUMBER	CLAIM/SITE NAME	COUNTY RECORDER DATA	SEC	TWP	RNG
356066	BLUEROCK 30				
356067	BLUEROCK 31				
356068	BLUEROCK 32				
356069	BLUEROCK 33				
356070	BLUEROCK 34				
356071	BLUEROCK 35				
356072	BLUEROCK 36				
356073	BLUEROCK 37				
356074	BLUEROCK 38				
356075	BLUEROCK 39				
356123	BLUEROCK 40				
356124	BLUEROCK 41				
356125	BLUEROCK 42				
356126	BLUEROCK 43				
356127	BLUEROCK 44				
356128	BLUEROCK 45				
356129	BLUEROCK 46				
356130	BLUEROCK 47				

Date Entered Into Computer: 9/24/04  
 Initials: RWE Verified: \_\_\_\_\_

RECEIVED  
 B.L.M. AZ STATE OFFICE  
 2004 AUG 30 P 2:38  
 PHOENIX, ARIZONA  
 BLM DATE STAMP

ENTERED IN COMPUTER

RE 9/24/04





**MAINTENANCE FEE PAYMENT**

BUREAU OF LAND MANAGEMENT  
 222 N CENTRAL AVENUE  
 PHOENIX, AZ 85004  
 602-417-9200  
 www.az.blm.gov

Mining Claim Maintenance Fee Payment of \$125 per claim/site is due on or before September 1, 20\_\_\_\_, in lieu of assessment work for the upcoming assessment year beginning September 1 of the year noted above.

RECEIVED  
 B.L.M. AZ STATE OFFICE  
 2004 AUG 30 P 2: 37  
 PHOENIX, ARIZONA  
 BLM Date Stamp

AMC NUMBER	CLAIM/SITE NAME	COUNTY RECORDER DATA	SEC	TWP	RNG
336106	BLUEROCK 1		33	4S	R11E
336107	BLUEROCK 2		33	4S	R11E
336108	BLUEROCK 3		33	4S	R11E
336109	BLUEROCK 4		33	4S	R11E
336110	BLUEROCK 5		33	4S	R11E
336114	BLUEROCK 9		33	4S	R11E
336116	BLUEROCK 11		33	4S	R11E
336121	BLUEROCK 16		33	4S	R11E

List additional claims on the reverse side of this form.

Check here if this is a change of address.

CLAIMANT NAME: CLARK HENSLER / RED HILLS MINING  
 ADDRESS: PO BOX 1169  
 CITY: FLORENCE STATE: AZ ZIP: 85232  
 PHONE: 602 722 0861  
 SIGNATURE: Clark Hensler

No of Claims: 8 x \$125 = 1000.00  
 Check No: \_\_\_\_\_ Init: \_\_\_\_\_  
 Receipt No: \_\_\_\_\_  
**FOR BLM USE ONLY**

Claimant or agent must sign to record with the County.  
 ENTERED IN COMPUTER  
 8c a 12464



**United States Department of the Interior**  
**Bureau of Land Management**  
 BUSINESS & SUPPORT SVCS DIV  
 222 N CENTRAL AVE  
 PHOENIX, AZ 85004 -2203  
 Phone: (602) 417-9200

Receipt	
No:	941588

**Transaction #:** 975958  
**Date of Transaction:** 08/30/2004

<b>CUSTOMER:</b>	RED HILLS MINING LLC P. O. BOX 1169 FLORENCE, AZ 85232
------------------	--

LINE #	QTY	DESCRIPTION	REMARKS	UNIT PRICE	TOTAL
1	1.00	LOCATABLE MINERALS / MINING CLAIMS-NOT NEW-UNADJUD, ONE AUTH NO. ONLY / MINING CLAIM MONEY RECEIVED (455) <b>CASES: AMC356003/\$5375.00</b>	MAINT 2005 (43)	- n/a -	5375.00
<b>TOTAL:</b>					<b>\$5,375.00</b>

PAYMENT INFORMATION			
1	<b>AMOUNT:</b>	\$5,375.00	<b>POSTMARKED:</b> N/A
	<b>TYPE:</b>	CHECK	<b>RECEIVED:</b> 08/30/2004
	<b>CHECK NO:</b>	984	
	<b>NAME:</b>	RED HILLS MINING LLC P. O. BOX 1169 FLORENCE AZ 85232	

REMARKS

This receipt was generated by the automated BLM Collections and Billing System and is a paper representation of a portion of the official electronic record contained therein.



Amc 356003  
Amc 356059  
Amc 356123

### MAINTENANCE FEE PAYMENT

Mining Claim Maintenance Fee Payment of \$100 per claim or site is due on or before September 1, 2003, in lieu of assessment work for the upcoming assessment year beginning September 1 of the year noted above.

BUREAU OF LAND MANAGEMENT  
ARIZONA STATE OFFICE  
222 NORTH CENTRAL AVENUE  
PHOENIX, AZ 85004  
602-417-9200  
www.az.blm.gov

<b>FOR BLM USE ONLY</b>	
NO. OF CLAIMS: <u>35</u>	X \$100 = \$ <u>3,500<sup>00</sup></u>
RECEIPT NO.: _____	CHECK NO.: <u>1083</u>
INIT: <u>TR</u>	

BLM SERIAL  
NUMBERS

NAME OF CLAIMS/SITES

1. AMC <u>356003-356005</u>	<u>Blue rock 20-22</u>
2. AMC <u>356059-356075</u>	<u>Blue rock 23-39</u>
3. AMC <u>356123-356137</u>	<u>Blue rock 40-54</u>
4. AMC _____	_____
5. AMC _____	_____
6. AMC _____	_____
7. AMC _____	_____
8. AMC _____	_____
9. AMC _____	_____
10. AMC _____	_____

List additional claims on the reverse side of this form.

CHECK HERE IF THIS IS A CHANGE OF ADDRESS

CLAIMANT'S NAME: Red Hills Mining LLC  
Ejo Martin McKenna  
ADDRESS: 4101 E. Tamiya St  
CITY: Phoenix STATE: AZ ZIP: 85044  
PHONE: 602-291-9779

Signature: [Signature]  
To record with the County, one claimant or an agent must sign.

RECEIVED  
BLM AZ STATE OFFICE  
2008 AUG 13 P 2:02  
PHOENIX, ARIZONA  
BLM DATE STAMP

ENTERED INTO COMPUTER

8/21/08  
TES

NAME: Clark Heisler ADDRESS: P.O. Box 1169  
CITY: Florence STATE: AZ ZIP: 85232 IS THIS A NEW ADDRESS

NAME: Larry Farnsworth ADDRESS: 6502 E. Heather Lane  
CITY: Mesa STATE: AZ ZIP: 85219 IS THIS A NEW ADDRESS

NAME: \_\_\_\_\_ ADDRESS: \_\_\_\_\_  
CITY: \_\_\_\_\_ STATE: \_\_\_\_\_ ZIP: \_\_\_\_\_ IS THIS A NEW ADDRESS

NAME: \_\_\_\_\_ ADDRESS: \_\_\_\_\_  
CITY: \_\_\_\_\_ STATE: \_\_\_\_\_ ZIP: \_\_\_\_\_ IS THIS A NEW ADDRESS

NAME: \_\_\_\_\_ ADDRESS: \_\_\_\_\_  
CITY: \_\_\_\_\_ STATE: \_\_\_\_\_ ZIP: \_\_\_\_\_ IS THIS A NEW ADDRESS

NAME: \_\_\_\_\_ ADDRESS: \_\_\_\_\_  
CITY: \_\_\_\_\_ STATE: \_\_\_\_\_ ZIP: \_\_\_\_\_ IS THIS A NEW ADDRESS

NAME: \_\_\_\_\_ ADDRESS: \_\_\_\_\_  
CITY: \_\_\_\_\_ STATE: \_\_\_\_\_ ZIP: \_\_\_\_\_ IS THIS A NEW ADDRESS

NAME: \_\_\_\_\_ ADDRESS: \_\_\_\_\_  
CITY: \_\_\_\_\_ STATE: \_\_\_\_\_ ZIP: \_\_\_\_\_ IS THIS A NEW ADDRESS

FOR BLM USE ONLY	
DATE ENTERED INTO COMPUTER:	_____
INITIALS:	_____ VERIFIED: _____

**United States Department of the Interior  
Bureau of Land Management**

BUSINESS & SUPPORT SVCS DIV  
222 N CENTRAL AVE  
PHOENIX, AZ 85004 -2203  
Phone: (602) 417-9200

Receipt	
No:	729303

**Transaction #:** 758685  
**Date of Transaction:** 08/13/2003

**CUSTOMER:** MARTIN J MCKENNA  
RED HILLS MINING, LLC  
4101 E. TAMAYA STREET  
PHOENIX, AZ 85044

LINE #	QTY	DESCRIPTION	REMARKS	UNIT PRICE	TOTAL
1	1.00	LOCATABLE MINERALS / MINING CLAIMS-NOT NEW-UNADJUD, ONE AUTH NO. ONLY / MINING CLAIM MONEY RECEIVED (455) <b>CASES:</b> AMC356003/\$3500.00	MAINT 2004 (35)	- n/a -	3500.00
<b>TOTAL:</b>					<b>\$3,500.00</b>

PAYMENT INFORMATION					
1	AMOUNT:	\$3,500.00	POSTMARKED:	N/A	
	TYPE:	CHECK	RECEIVED:	08/13/2003	
	CHECK NO:	1083			
	NAME:	RED HILLS MINING, LLC MCKENNA, MARTIN J 4101 E. TAMAYA STREET PHOENIX AZ 85044			

REMARKS

This receipt was generated by the automated BLM Collections and Billing System and is a paper representation of a portion of the official electronic record contained therein.







**MAINTENANCE FEE PAYMENT**

Mining Claim Maintenance Fee Payment of \$100 per claim or site is due on or before September 1, 2002, in lieu of assessment work for the upcoming assessment year beginning September 1 of the year noted above.

BUREAU OF LAND MANAGEMENT  
 ARIZONA STATE OFFICE  
 222 NORTH CENTRAL AVENUE  
 PHOENIX, AZ 85004  
 602-417-9200  
 www.az.blm.gov

<b>FOR BLM USE ONLY</b>	
NO. OF CLAIMS: <u>35</u>	X \$100 = \$ <u>3,500</u>
RECEIPT NO.: <u>3551679</u>	CHECK NO.: <u>1069</u>
INIT: <u>TR</u>	

BLM SERIAL  
 NUMBERS

NAME OF CLAIMS/SITES

- |                             |                       |
|-----------------------------|-----------------------|
| 1. AMC <u>356003-356005</u> | <u>Bluerock 20-22</u> |
| 2. AMC <u>356059-356075</u> | <u>Bluerock 23-39</u> |
| 3. AMC <u>356123-356137</u> | <u>Bluerock 40-54</u> |
| 4. AMC _____                | _____                 |
| 5. AMC _____                | _____                 |
| 6. AMC _____                | _____                 |
| 7. AMC _____                | _____                 |
| 8. AMC _____                | _____                 |
| 9. AMC _____                | _____                 |
| 10. AMC _____               | _____                 |

List additional claims on the reverse side of this form.

CHECK HERE IF THIS IS A CHANGE OF ADDRESS

CLAIMANT'S NAME: Red Hills Mining LLC  
% Martin McKenna  
 ADDRESS: 4101 E. Tama Ya St.  
 CITY: Phoenix STATE: AZ ZIP: 85044  
 PHONE: 602-291-9779

Signature: Martin McKenna  
 To record with the County, one claimant or an agent must sign.

RECEIVED  
 B.L.M. AZ STATE OFFICE  
 2002 AUG 29 A 11:18  
 PHOENIX, ARIZONA  
 BLM DATE STAMP

ENTERED IN COMPUTER  
RS 9/19/2002  
 VERIFIED 10/23/02TK

**MAINTENANCE FEE PAYMENT**

Mining Claim Maintenance Fee Payment of \$100 per claim or site is due on or before September 1, 2002, in lieu of assessment work for the upcoming assessment year beginning September 1 of the year noted above.

BUREAU OF LAND MANAGEMENT  
ARIZONA STATE OFFICE  
222 NORTH CENTRAL AVENUE  
PHOENIX, AZ 85004  
602-417-9200  
www.az.blm.gov

FOR BLM USE ONLY	
NO. OF CLAIMS: <u>8</u>	X \$100 = \$ <u>800</u>
RECEIPT NO.: <u>551679</u>	CHECK NO.: <u>1068, #009</u>
INIT: <u>TR</u>	

BLM SERIAL  
NUMBERS

NAME OF CLAIMS/SITES

- |                             |                     |
|-----------------------------|---------------------|
| 1. AMC <u>336106-336110</u> | <u>Bluerock 1-5</u> |
| 2. AMC <u>336114</u>        | <u>Bluerock #9</u>  |
| 3. AMC <u>336116</u>        | <u>Bluerock #11</u> |
| 4. AMC <u>336121</u>        | <u>Bluerock #16</u> |
| 5. AMC _____                | _____               |
| 6. AMC _____                | _____               |
| 7. AMC _____                | _____               |
| 8. AMC _____                | _____               |
| 9. AMC _____                | _____               |
| 10. AMC _____               | _____               |

List additional claims on the reverse side of this form.

CHECK HERE IF THIS IS A CHANGE OF ADDRESS

CLAIMANT'S NAME: Martin J. McKenna  
ADDRESS: 4101 E. Tamaya St.  
CITY: Phoenix STATE: AZ ZIP: 85044  
PHONE: 602-291-9749

Signature: Martin J. McKenna  
To record with the County, one claimant or an agent must sign.

RECEIVED  
B.L.M. AZ STATE OFFICE  
2002 AUG 29 A 11:18  
PHOENIX, ARIZONA  
BLM DATE STAMP

ENTERED IN COMPUTER  
RE 9/19/2002

**United States Department of the Interior**  
**Bureau of Land Management**  
 BUSINESS & SUPPORT SVCS DIV  
 222 N CENTRAL AVE  
 PHOENIX, AZ 85004 -2203  
 Phone: (602) 417-9200

Receipt	
No:	551679

<b>Transaction #:</b> 576406
<b>Date of Transaction:</b> 08/29/2002
<b>CUSTOMER:</b> RED HILLS MIMING LLC 4101 E TAMAYA ST PHOENIX, AZ 85044

LINE #	QTY	DESCRIPTION	REMARKS	UNIT PRICE	TOTAL
1	1.00	LOCATABLE MINERALS / MINING CLAIMS-NOT NEW-UNADJUD, ONE AUTH NO. ONLY / MINING CLAIM MONEY RECEIVED (455) <b>CASES: AMC336106/\$4300.00</b>	MAINT 2003 (43)	- n/a -	4300.00
<b>TOTAL:</b>					<b>\$4,300.00</b>

PAYMENT INFORMATION			
1	AMOUNT:	\$3,500.00	POSTMARKED: N/A
	TYPE:	CHECK	RECEIVED: 08/29/2002
	CHECK NO:	1069	
	NAME:	RED HILLS MIMING LLC 4101 E TAMAYA ST PHOENIX AZ 85044	
2	AMOUNT:	\$800.00	POSTMARKED: N/A
	TYPE:	CHECK	RECEIVED: 08/29/2002
	CHECK NO:	1068	
	NAME:	RED HILLS MIMING LLC 4101 E TAMAYA ST PHOENIX AZ 85044	

REMARKS

This receipt was generated by the automated BLM Collections and Billing System and is a paper representation of a portion of the official electronic record contained therein.



**NOTICE!!**

**These documents have been scanned!**

**Do not place un-scanned documents beneath this notice!**

**Do not remove this notice from this file!**

GPO Jacket No. 560-102  
Print Order 61540  
Rise Business Services, LLC  
Job=AZ15 6/26/2019



Box Number= AZ15134



Claim Begin-End: AMC356059-AMC356059

**5 Miscellaneous**



AZ15134-5

AMC356454-AMC363464



**NO  
DOCUMENTS  
FOUND**

NO DOCUMENTS FOUND  
NO DOCUMENTS FOUND

**NOTICE!!**

**These documents have been scanned!**

**Do not place un-scanned documents beneath this notice!**

**Do not remove this notice from this file!**

GPO Jacket No. 560-102  
Print Order 61540  
Rise Business Services, LLC  
Job=AZ15 6/26/2019



Box Number= AZ15134



Claim Begin-End: AMC356059-AMC356059

**6 Location Notices-Amendments and Supporting Documents**



AZ15134-5

AMC356454-AMC363464





OFFICIAL RECORDS OF  
PINAL COUNTY RECORDER  
LAURA DEAN-LYTLE

DATE: 12/31/01 TIME: 1452  
FEE : 10.00  
PAGES: 2  
FEE NO: 2001-060453

STATE OF \_\_\_\_\_ } ss. I hereby certify that the within instrument  
COUNTY OF \_\_\_\_\_ } filed for record in \_\_\_\_\_ Co  
Witness my hand and Official Seal. State of \_\_\_\_\_  
Indexed Paged Blotted \_\_\_\_\_  
County Recorder  
By \_\_\_\_\_ Deputy

When recorded, mail to: Martin J. McKenna 4101 E. Tamaya St., Phoenix, AZ 85044

### NOTICE OF MINING CLAIM

1. TYPE OF NOTICE:  Location  Amendment  Relocation
2. TYPE OF CLAIM:  Placer  Lode  Millsite  Tunnelsite
3. The name and address of the Locator is

Red Hills Mining LLC

4101 E. Tamaya St. NAME

Phoenix Arizona 85044 ADDRESS  
CITY STATE ZIP

4. The name of the claim is Bluerock 23 STATE
5. The date of the location is 23 December 2001
6. The claim is 1500 feet long and 600 feet wide. The distance from the Location monument to each end of the claim is 10 feet in a west direction and 1490 feet in a east direction.
7. The general course of the claim is from the east to the west
8. The location of the claim is in Section Gila and Salt River, Township 4S Range 11E Base and Meridian, Red Hills Mining District, Pinal County, State of Arizona
9. If amending or relocating, the previous claim name was Redbird 29 recorded in Docket(Book) 1754 page(s) 785 of Red Hills Mining District, Pinal County, State of Arizona
10. The location of the claim with reference to a natural object or permanent monument is The SW corner of the claim is 1200 feet in a north direction from the survey marker marking the SE corner of Section 33, T4S R11E

Date 23 December 2001

Martin J. McKenna  
(signature)  
4101 E. Tamaya St.  
(address)  
Phoenix, AZ 85044  
(city/state/zip)

91-15962

FILE 356059



# MAP OF MINING CLAIM LOCATION

1. The name of the claim is Bluerock 23
2. The SW corner of the claim is 1200 feet in a north direction to a survey monument or permanent natural object described as The survey marker marking the SE corner of Section 33 T4S R 11E
3. The type of location monument is Stones and a wooden post  
The type of corner and end monuments are stones and a wooden post
4. The bearing and distance between the corners of the claim are beginning at the SW corner of the claim, 1500 feet in a East direction to the SE corner, then 600 feet in a north direction to the NE corner, then 1500 feet in a west direction to the NW corner, then 600 feet in a south direction to the point of beginning.

## MAP

One inch = One thousand feet

North Arrow



ONE MILE

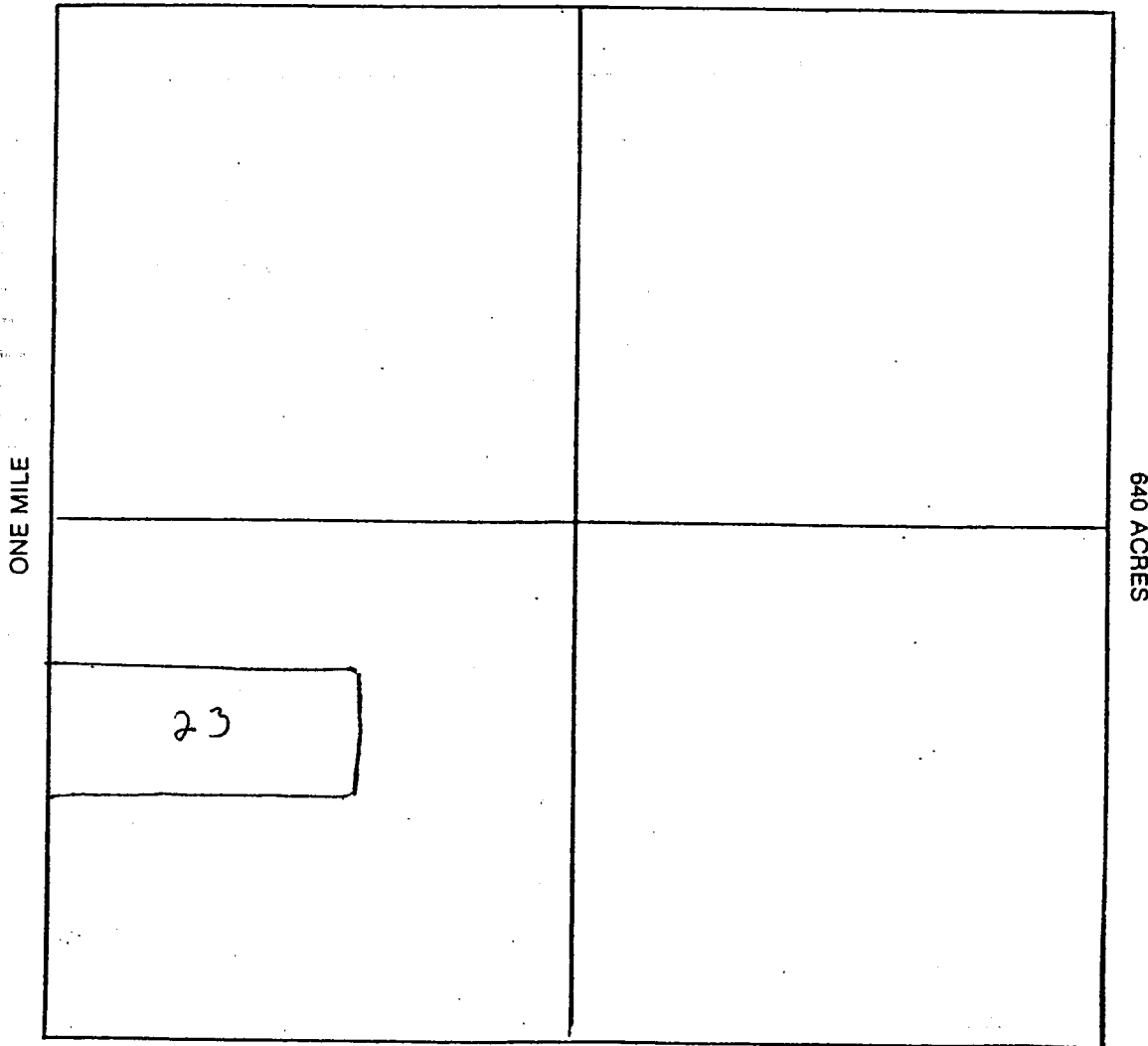

Section 11 E Range Gila and Salt River Township 4S Base and Meridian.

Date 23 December 2001

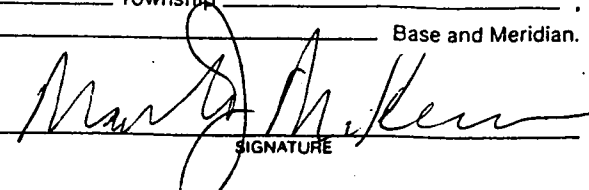
  
SIGNATURE



OFFICIAL RECORDS OF  
PINAL COUNTY RECORDER  
LAURA DEAN-LYTTLE

DATE: 12/31/01 TIME: 1452  
FEE : 10.00  
PAGES: 2  
FEE NO: 2001-060454

STATE OF \_\_\_\_\_ }  
COUNTY OF \_\_\_\_\_ } ss.  
Witness my hand and Official Seal.  
Indexed Paged Blotted

I hereby certify that the within instrument  
filed for record in \_\_\_\_\_ Cou  
State of \_\_\_\_\_  
County Recorder  
By \_\_\_\_\_  
Deputy

When recorded, mail to: Martin J. McKenna 4101 E. Tamaya St., Phoenix, AZ 85044

### NOTICE OF MINING CLAIM

- 1. TYPE OF NOTICE:  Location  Amendment  Relocation
- 2. TYPE OF CLAIM:  Placer  Lode  Millsite  Tunnelsite
- 3. The name and address of the Locator is

Red Hills Mining LLC

4101 E. Tamaya St. NAME

Phoenix Arizona ADDRESS

85044 ZIP

CITY Bluerock 24 STATE

ZIP

- 4. The name of the claim is \_\_\_\_\_
- 5. The date of the location is 23 December 2001
- 6. The claim is 1500 feet long and 600 feet wide. The distance from the Location monument to each end of the claim is 1490 feet in a west direction and 10 feet in a east direction.
- 7. The general course of the claim is from the east to the west
- 8. The location of the claim is in Section 4S Township, Range 11E, Gila and Salt River Base and Meridian, Red Hills Mining District, Pinal County, State of Arizona
- 9. If amending or relocating, the previous claim name was Redbird 24 recorded in Docket(Book) 1754 page(s) 775 of Red Hills Mining District, Pinal County, State of Arizona
- 10. The location of the claim, with reference to a natural object or permanent monument is The SW corner of the claim is 600 feet in anorth direction from the survey marker marking the SE corner of Section 33, T4S R11E

23 December 2001

Date \_\_\_\_\_

*Martin J. McKenna*  
(signature)

4101 E. Tamaya St.

Phoenix, AZ 85044 (address)

(city/state/zip)

91-15957

AMC 356060

# MAP OF MINING CLAIM LOCATION

1. The name of the claim is Bluerock 24
2. The SW corner of the claim is 600 feet in a north direction to a survey monument or permanent natural object described as The survey marker marking the SE corner of Section 33 T4S R 11E
3. The type of location monument is Stones and a wooden post  
The type of corner and end monuments are stones and a wooden post
4. The bearing and distance between the corners of the claim are beginning at the SW corner of the claim, 1500 feet in a East direction to the SE corner, then 600 feet in a north direction to the NE corner, then 1500 feet in a west direction to the NW corner, then 600 feet in a south direction to the point of beginning.

## MAP

One inch = One thousand feet

North Arrow



ONE MILE

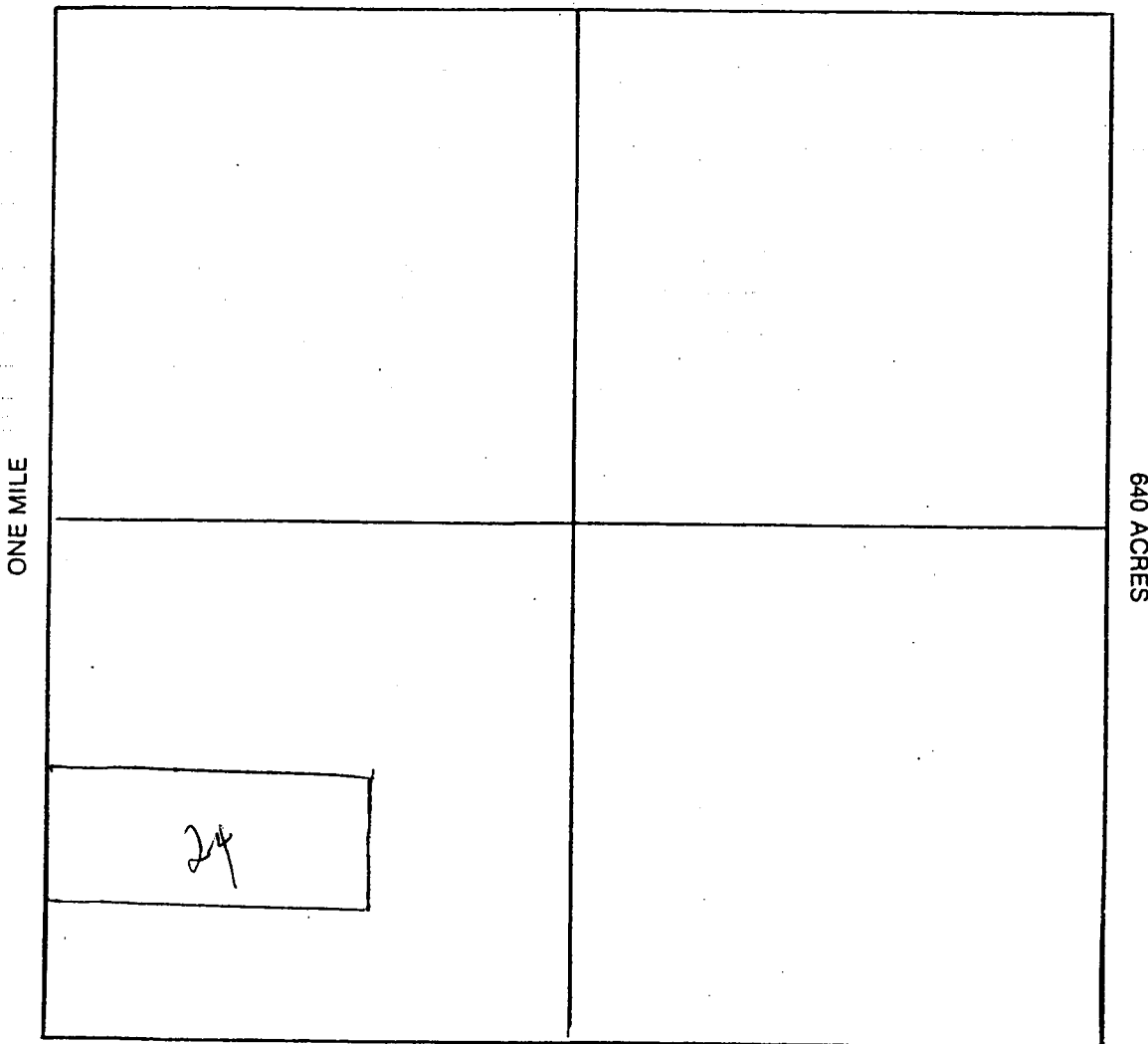

Section 34 Range 11 E Township 4S  
Gila and Salt River Base and Meridian.

Date 23 December 2001

  
SIGNATURE



OFFICIAL RECORDS OF  
 PINAL COUNTY RECORDER  
 LAURA DEAN-LYTLE

STATE OF \_\_\_\_\_ }  
 COUNTY OF \_\_\_\_\_ } ss.  
 Witness my hand and Official Seal.

I hereby certify that the within instrument was  
 filed for record in \_\_\_\_\_ Court  
 State of \_\_\_\_\_

County Recorder

By \_\_\_\_\_  
 Deputy

DATE: 12/31/01 TIME: 1452  
 FEE: 10.00  
 PAGES: 2  
 FEE NO: 2001-060455

When recorded, mail to: Martin J. McKenna 4101 E. Tamaya St., Phoenix, AZ 85044

### NOTICE OF MINING CLAIM

1. TYPE OF NOTICE:  Location  Amendment  Relocation
2. TYPE OF CLAIM:  Placer  Lode  Millsite  Tunnelsite
3. The name and address of the Locator is

Red Hills Mining LLC

4101 E. Tamaya St. NAME

Phoenix Arizona ADDRESS

85044

CITY Bluerock 25 STATE ZIP

4. The name of the claim is \_\_\_\_\_
5. The date of the location is 23 December 2001
6. The claim is 1500 feet long and 600 feet wide. The distance from the Location monument to each end of the claim is 1490 feet in a west direction and 10 feet in a east direction.
7. The general course of the claim is from the east to the west
8. The location of the claim is in Section 4S Township, Range 11E, Gila and Salt River Base and Meridian, Red Hills Mining District, Pinal County, State of Arizona
9. If amending or relocating, the previous claim name was Redbird recorded in Docket(Book) 1754 page(s) 765 of Arizona Mining District, Pinal County, State of \_\_\_\_\_
10. The location of the claim, with reference to a natural object or permanent monument is The SW corner of the claim is congruent with the survey marker marking the SE corner of Section 33, T4S R11E

2002 MAR 25 A 9 35  
 LAND RECORDS DIVISION  
 STATE OF ARIZONA

AME 356061

Date 23 December 2001

(signature)  
 4101 E. Tamaya St.  
 (address)  
 Phoenix, AZ 85044  
 (city/state/zip)

91-15952



# MAP OF MINING CLAIM LOCATION

1. The name of the claim is Bluerock 25
2. The SW corner of the claim is congruent with  
a survey monument or permanent natural object described as The survey marker marking the  
SE corner of Section 33 T4S R 11E
3. The type of location monument is Stones and a wooden post  
 The type of corner and end monuments are stones and a wooden post
4. The bearing and distance between the corners of the claim are beginning at the SW  
 corner of the claim, 1500 feet in a East direction to the SE  
 corner, then 600 feet in a north direction to the NE  
 corner, then 1500 feet in a west direction to the NW  
 corner, then 600 feet in a south direction to the point of beginning.

## MAP

One inch = One thousand feet

North Arrow



ONE MILE

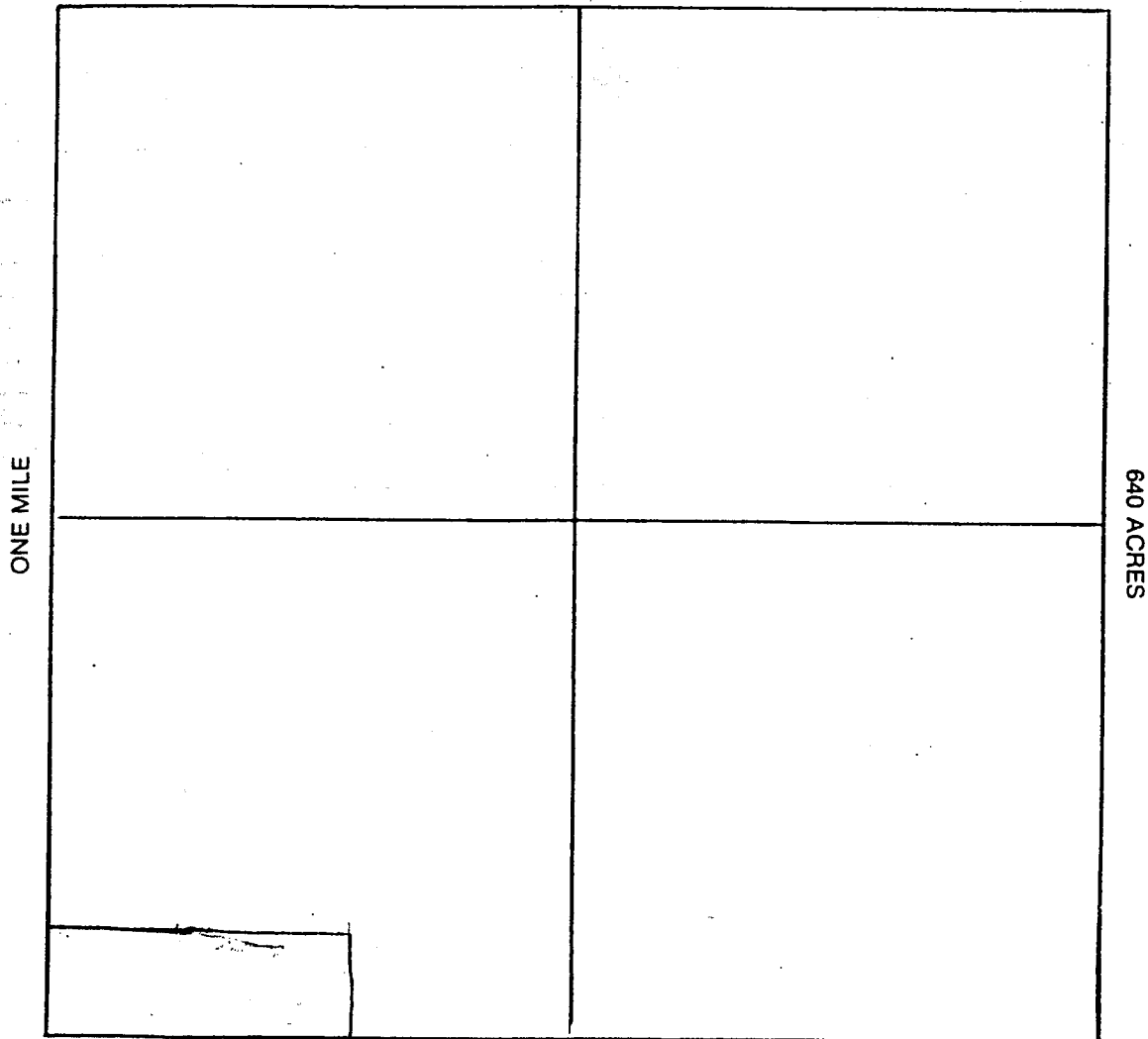

Section 34 Range 11 E Township 4S  
Gila and Salt River Base and Meridian.

Date 23 December 2001

*Mary J. Miller*  
 SIGNATURE

2



OFFICIAL RECORDS OF  
PINAL COUNTY RECORDER  
LAURA DEAN-LYTLE

STATE OF \_\_\_\_\_ }  
COUNTY OF \_\_\_\_\_ } ss.  
Witness my hand and Official Seal.

I hereby certify that the within instrument  
filed for record in \_\_\_\_\_ Cou  
State of \_\_\_\_\_

County Recorder

By \_\_\_\_\_  
Deputy

DATE: 12/31/01 TIME: 1452  
FEE : 10.00  
PAGES: 2  
FEE NO: 2001-060456

When recorded, mail to: Martin J. McKenna 4101 E. Tamaya St., Phoenix, AZ 85044

### NOTICE OF MINING CLAIM

- 1. TYPE OF NOTICE:  Location  Amendment  Relocation
- 2. TYPE OF CLAIM:  Placer  Lode  Millsite  Tunnelsite
- 3. The name and address of the Locator is

Red Hills Mining LLC

4101 E. Tamaya St. NAME

Phoenix Arizona ADDRESS 85044

CITY Bluerock 26 STATE ZIP

- 4. The name of the claim is \_\_\_\_\_
- 5. The date of the location is 23 December 2001
- 6. The claim is 1500 feet long and 600 feet wide. The distance from the Location monument to each end of the claim is 1490 feet in a east direction and 10 feet in a east direction.
- 7. The general course of the claim is from the east to the west
- 8. The location of the claim is in Section 34, Township 4S Range 11E  
Gila and Salt River Base and Meridian, Red Hills Mining District,  
Pinal County, State of Arizona
- 9. If amending or relocating, the previous claim name was Redbird 25  
Red Hills recorded in Docket(Book) 1754 page(s) 1777  
of Arizona Mining District, Pinal County, State
- 10. The location of the claim with reference to a natural object or permanent monument is The SW corner of the claim is 1500 feet in an east direction from the survey marker marking the SE corner of Section 33, T4S R11E and then 600 feet north.

RECEIVED  
PINAL COUNTY RECORDER  
2002 MAR 25 A 9:35

AMC 356062

Date 23 December 2001

Martin J. McKenna  
(signature)

4101 E. Tamaya St.  
(address)  
Phoenix, AZ 85044

(city/state/zip)

# MAP OF MINING CLAIM LOCATION

1. The name of the claim is Bluerock 26
2. The SW corner of the claim is 1500 feet in a east direction to a survey monument or permanent natural object described as The survey marker marking the SE corner of Section 33 T4S R 11E and then 600 feet north.
3. The type of location monument is Stones and a wooden post  
The type of corner and end monuments are stones and a wooden post
4. The bearing and distance between the corners of the claim are beginning at the SW corner of the claim, 1500 feet in a East direction to the SE corner, then 600 feet in a north direction to the NE corner, then 1500 feet in a west direction to the NW corner, then 600 feet in a south direction to the point of beginning.

## MAP

One inch = One thousand feet

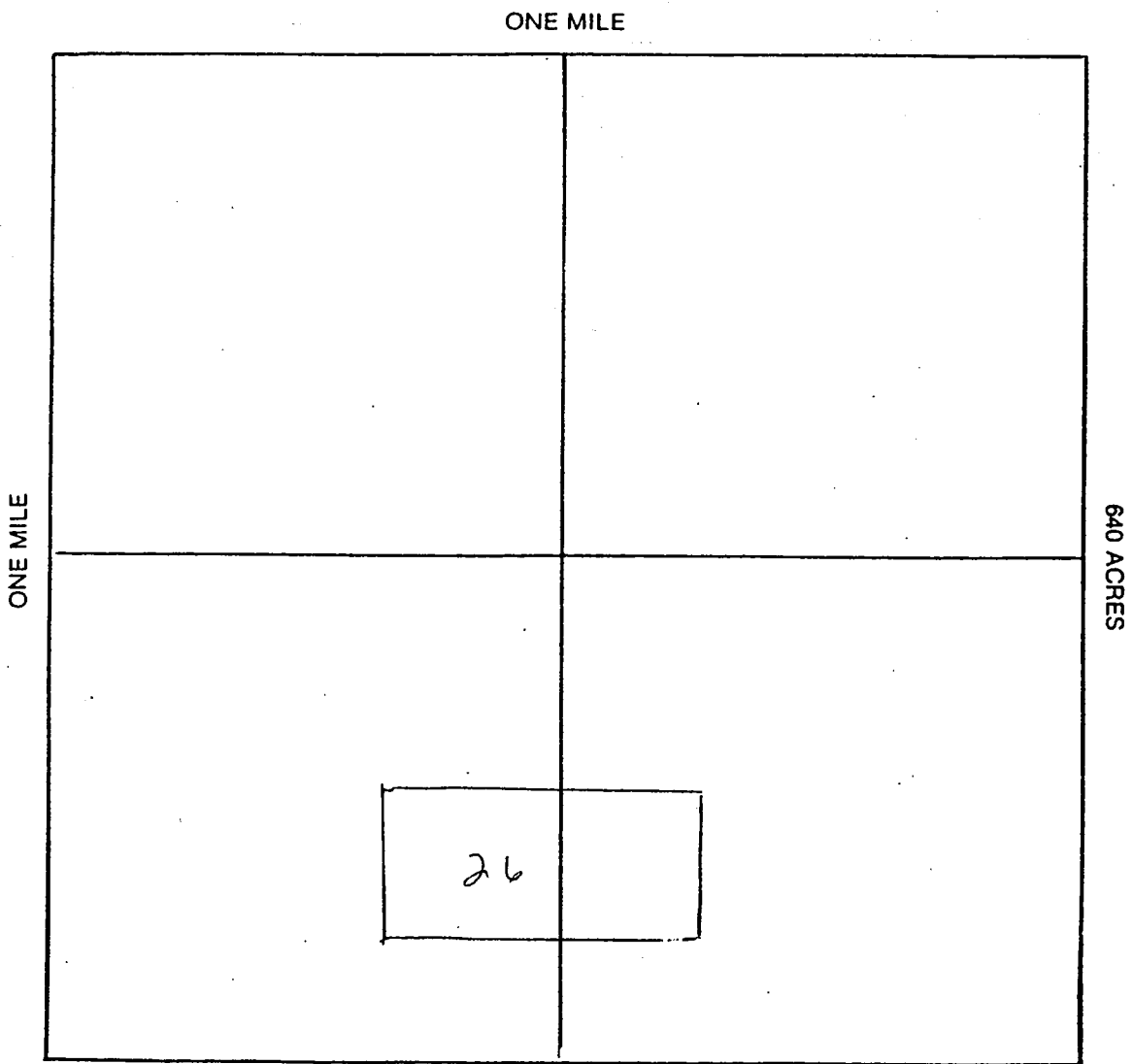
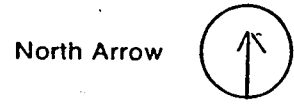

Section 34 Range 11 E Township 4S  
Gila and Salt River Base and Meridian.

Date 23 December 2001

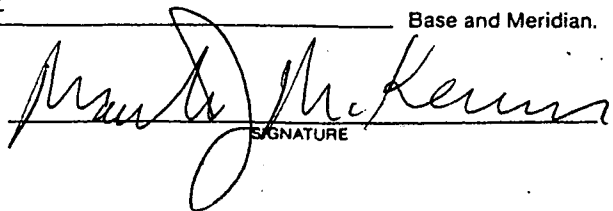
  
SIGNATURE

2

STATE OF  
COUNTY OF

Witness my hand and Official Seal.

Indexed Paged Blotted

} ss. I hereby certify that the within instrument  
filed for record in \_\_\_\_\_  
State of \_\_\_\_\_

County Recorder

By \_\_\_\_\_  
Deputy



OFFICIAL RECORDS OF  
PINAL COUNTY RECORDER  
LAURA DEAN-LYTLE

DATE: 12/31/01 TIME: 1452  
FEE : 10.00  
PAGES: 2  
FEE NO: 2001-060457

When recorded, mail to: Martin J. McKenna 4101 E. Tamaya St., Phoenix, AZ 85044

### NOTICE OF MINING CLAIM

1. TYPE OF NOTICE:  Location  Amendment  Relocation
2. TYPE OF CLAIM:  Placer  Lode  Millsite  Tunnelsite
3. The name and address of the Locator is

Red Hills Mining LLC

4101 E. Tamaya St. NAME

Phoenix Arizona ADDRESS 85044

CITY Bluerock 27 STATE ZIP

4. The name of the claim is \_\_\_\_\_
5. The date of the location is 23 December 2001
6. The claim is 1500 feet long and 600 feet wide. The distance from the Location monument to each end of the claim is 1490 feet in a east direction and 10 feet in a west direction.
7. The general course of the claim is from the east to the west
8. The location of the claim is in Section 34, Township 4S, Range 11E, Gila and Salt River Base and Meridian, Red Hills Mining District, Pinal County, State of Arizona
9. If amending or relocating, the previous claim name was Redbird 26 recorded in Docket(Book) 1754, Pinal page(s) 779 of Red Hills Mining District, Pinal County, State of Arizona
10. The location of the claim, with reference to a natural object or permanent monument is The SW corner of the claim is 3000 feet in an east direction from the survey marker marking the SE corner of Section 33, T4S R11E and then 600 feet north

23 December 2001

Date \_\_\_\_\_

*Martin J. McKenna*  
(signature)

4101 E. Tamaya St.

Phoenix, AZ 85044  
(address)

(city/state/zip)

2002 MAR 25 A 9:35  
STATE OF ARIZONA  
OFFICE OF THE REGISTRAR OF TITLES  
PINAL COUNTY RECORDER

AMC 356063

91-15959



# MAP OF MINING CLAIM LOCATION

Bluerock 27

- The name of the claim is \_\_\_\_\_
- The SW corner of the claim is 3000 feet in a east direction to a survey monument or permanent natural object described as The survey marker marking the SE corner of Section 33 T4S R 11E and then 600 feet north.  
Stones and a wooden post
- The type of location monument is \_\_\_\_\_  
The type of corner and end monuments are stones and a wooden post SW
- The bearing and distance between the corners of the claim are beginning at the corner of the claim, 1500 feet in a East direction to the SE corner, then 600 feet in a north direction to the NE corner, then 1500 feet in a west direction to the NW corner, then 600 feet in a south direction to the point of beginning.

## MAP

One inch = One thousand feet

North Arrow



ONE MILE

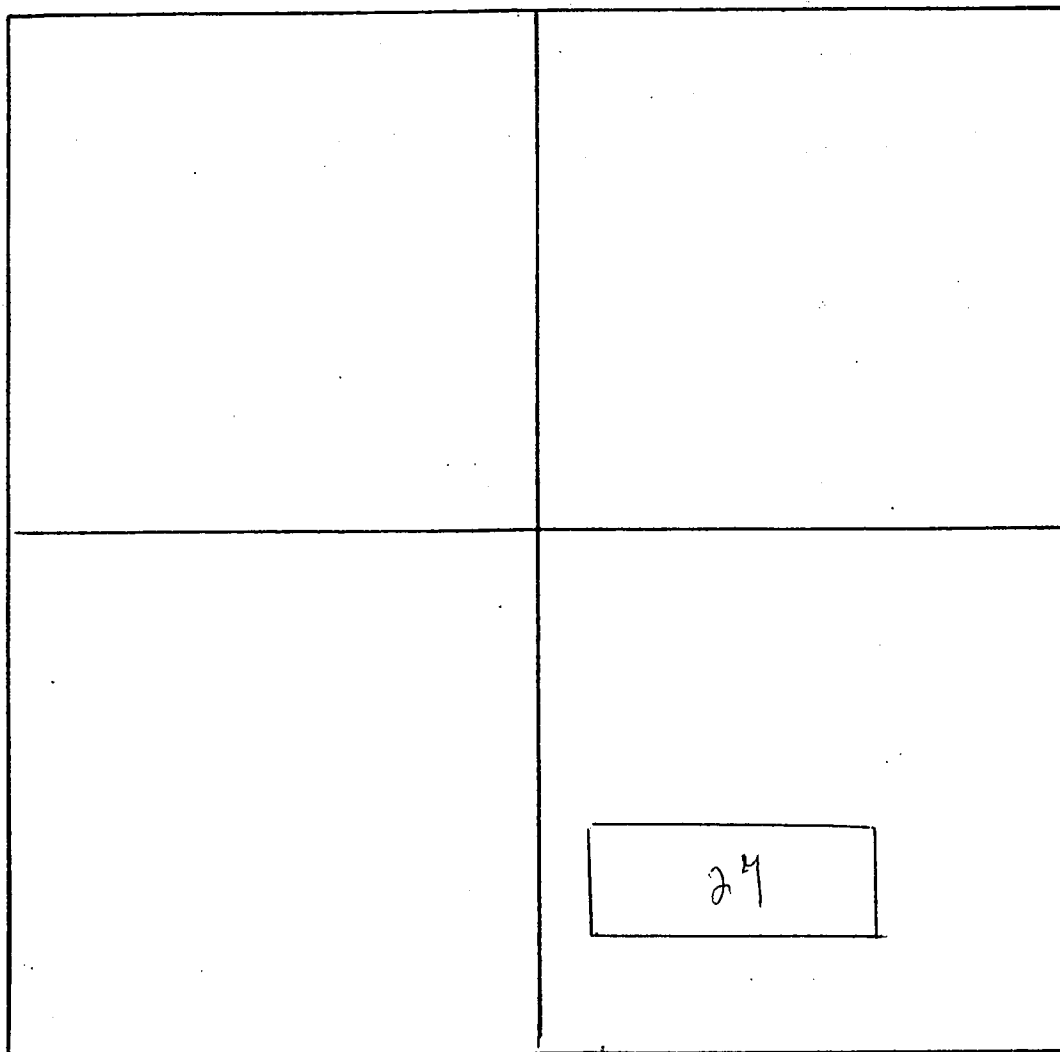

Section 34 Range 11 E Township 4S  
Gila and Salt River Base and Meridian.

Date 23 December 2001

*Mark J. Keenan*  
SIGNATURE

2

STATE OF \_\_\_\_\_ } ss.  
COUNTY OF \_\_\_\_\_ }  
Witness my hand and Official Seal.  
Indexed Paged Blotted

I hereby certify that the within instrument  
filed for record in \_\_\_\_\_  
State of \_\_\_\_\_  
County Recorder  
By \_\_\_\_\_  
Deputy



OFFICIAL RECORDS OF  
PINAL COUNTY RECORDER  
LAURA DEAN-LYTTLE

DATE: 12/31/01 TIME: 1452  
FEE : 10.00  
PAGES: 2  
FEE NO: 2001-060458

When recorded, mail to: Martin J. McKenna 4101 E. Tamaya St., Phoenix, AZ 85044

### NOTICE OF MINING CLAIM

- 1. TYPE OF NOTICE:  Location  Amendment  Relocation
- 2. TYPE OF CLAIM:  Placer  Lode  Millsite  Tunnelsite
- 3. The name and address of the Locator is

Red Hills Mining LLC

4101 E. Tamaya St. NAME

Phoenix Arizona ADDRESS

85044

CITY Bluerock 28 STATE ZIP

- 4. The name of the claim is \_\_\_\_\_
- 5. The date of the location is 23 December 2001
- 6. The claim is 1500 feet long and 600 feet wide. The distance from the Location monument to each end of the claim is 1490 feet in a west direction and 10 feet in a east direction.
- 7. The general course of the claim is from the east to the west
- 8. The location of the claim is in Section 34, Township 4S, Range 11E, Gila and Salt River Base and Meridian, Red Hills Mining District, Pinal County, State of Arizona
- 9. If amending or relocating, the previous claim name was Redbird 30 recorded in Docket(Book) 1754 page(s) 787 of Red Hills Mining District, Pinal County, State of Arizona
- 10. The location of the claim with reference to a natural object or permanent monument is The SW corner of the claim is 1500 feet in an east direction from the survey marker marking the SE corner of Section 33, T4S R11E and then 1200 feet north.

RECEIVED  
PINAL COUNTY RECORDER  
LAURA DEAN-LYTTLE  
2002 MAR 25 A 9:35  
PHOENIX, ARIZONA

AMC 356064

Date 23 December 2001

(signature)  
4101 E. Tamaya St.  
(address)  
Phoenix, AZ 85044  
(city/state/zip)

91-15963

# MAP OF MINING CLAIM LOCATION

Bluerock 28

- The name of the claim is Bluerock 28
- The SW corner of the claim is 1500 feet in a east direction to a survey monument or permanent natural object described as The survey marker marking the SE corner of Section 33 T4S R 11E and then 1200 feet north.
- The type of location monument is Stones and a wooden post  
The type of corner and end monuments are stones and a wooden post
- The bearing and distance between the corners of the claim are beginning at the SW corner of the claim, 1500 feet in a East direction to the SE corner, then 600 feet in a north direction to the NE corner, then 1500 feet in a west direction to the NW corner, then 600 feet in a south direction to the point of beginning.

## MAP

One inch = One thousand feet

North Arrow



ONE MILE

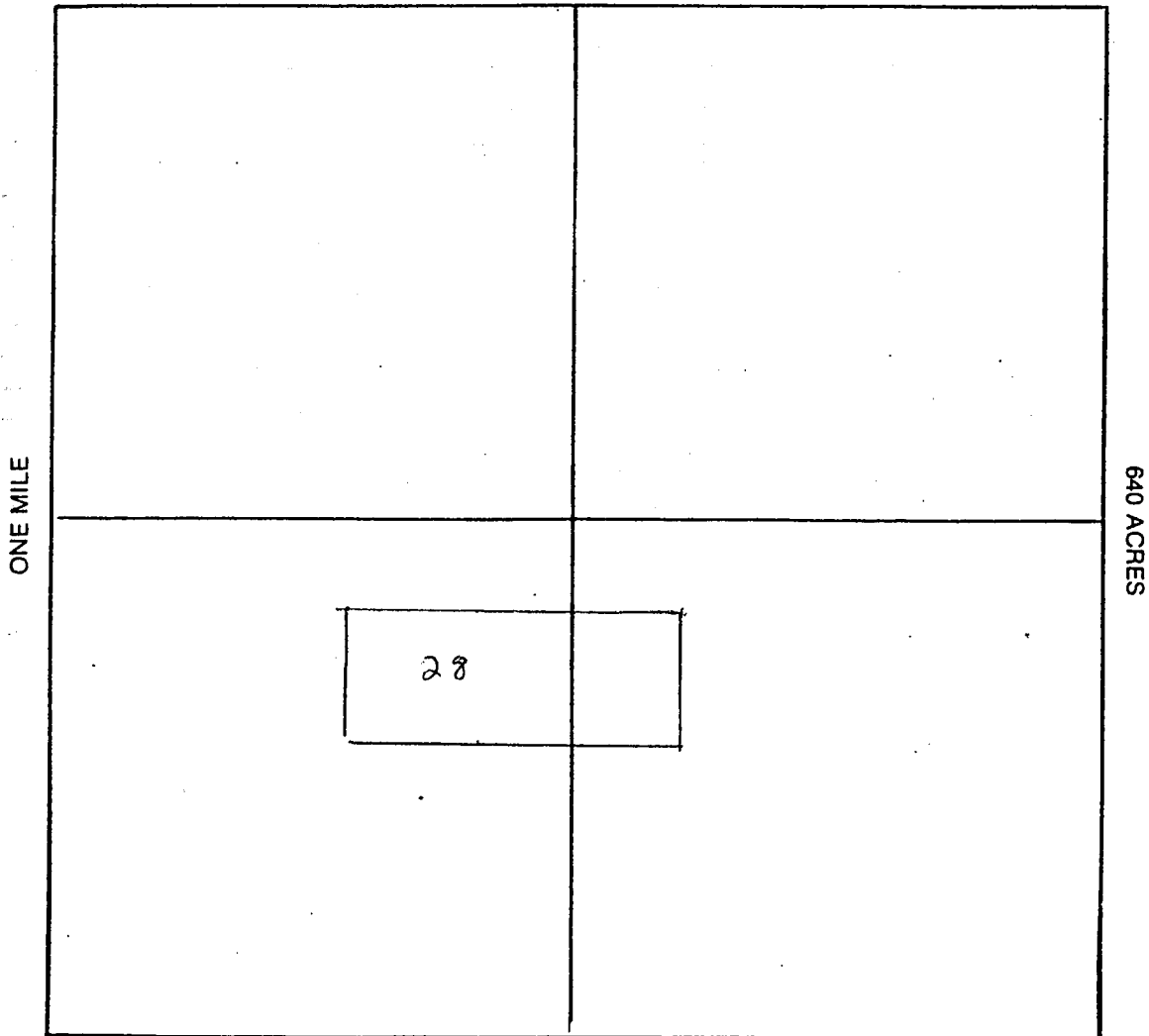

Section 34 Range 11 E Township 4S  
Gila and Salt River Base and Meridian.

Date 23 December 2001

Mandy McKeen  
SIGNATURE

STATE OF \_\_\_\_\_ } ss.  
COUNTY OF \_\_\_\_\_  
Witness my hand and Official Seal.  
Indexed Paged Blotted

\_\_\_\_\_ hereby certify that the within instru  
filed for record in \_\_\_\_\_  
State of \_\_\_\_\_  
\_\_\_\_\_  
County Recorder  
By \_\_\_\_\_  
Deputy



OFFICIAL RECORDS OF  
PINAL COUNTY RECORDER  
LAURA DEAN-LYTLLE

DATE: 12/31/01 TIME: 1452  
FEE : 10.00  
PAGES: 2  
FEE NO: 2001-060459

When recorded, mail to: Martin J. McKenna 4101 E. Tamaya St., Phoenix, AZ 85044

### NOTICE OF MINING CLAIM

1. TYPE OF NOTICE:  Location  Amendment  Relocation
2. TYPE OF CLAIM:  Placer  Lode  Millsite  Tunnelsite
3. The name and address of the Locator is

Red Hills Mining LLC

4101 E. Tamaya St. NAME

Phoenix Arizona ADDRESS

85044

CITY Bluerock 29 STATE ZIP

4. The name of the claim is \_\_\_\_\_
5. The date of the location is 23 December 2001
6. The claim is 1500 feet long and 600 feet wide. The distance from the Location monument to each end of the claim is 1490 feet in a east direction and 10 feet in a west direction.
7. The general course of the claim is from the east to the west
8. The location of the claim is in Section 34, Township 4S, Range 11E, Gila and Salt River Base and Meridian, Red Hills Mining District, Pinal County, State of Arizona
9. If amending or relocating, the previous claim name was Redbird 31 recorded in Docket(Book) 1754 page(s) 789 of Red Hills Mining District, Pinal County, State of Arizona
10. The location of the claim, with reference to a natural object or permanent monument is The SW corner of the claim is 3000 feet in an east direction from the survey marker marking the SE corner of Section 33, T4S R11E and then 1200 feet north

2002 MAR 25 A 9:35  
STATE OF ARIZONA  
PINAL COUNTY RECORDER  
LAURA DEAN-LYTLLE

AMC 356065

23 December 2001

Date \_\_\_\_\_

*Martin J. McKenna*  
(signature)

4101 E. Tamaya St.

Phoenix, AZ 85044  
(address)

(city/state/zip)

91-15964

# MAP OF MINING CLAIM LOCATION

Bluerock 29

- The name of the claim is \_\_\_\_\_
- The SW corner of the claim is 3000 feet in a east direction to a survey monument or permanent natural object described as The survey marker marking the SE corner of Section 33 T4S R 11E and then 1200 feet north.
- The type of location monument is Stones and a wooden post  
The type of corner and end monuments are stones and a wooden post
- The bearing and distance between the corners of the claim are beginning at the SW corner of the claim, 1500 feet in a East direction to the SE corner, then 600 feet in a north direction to the NE corner, then 1500 feet in a west direction to the NW corner, then 600 feet in a south direction to the point of beginning.

## MAP

One inch = One thousand feet

North Arrow



ONE MILE

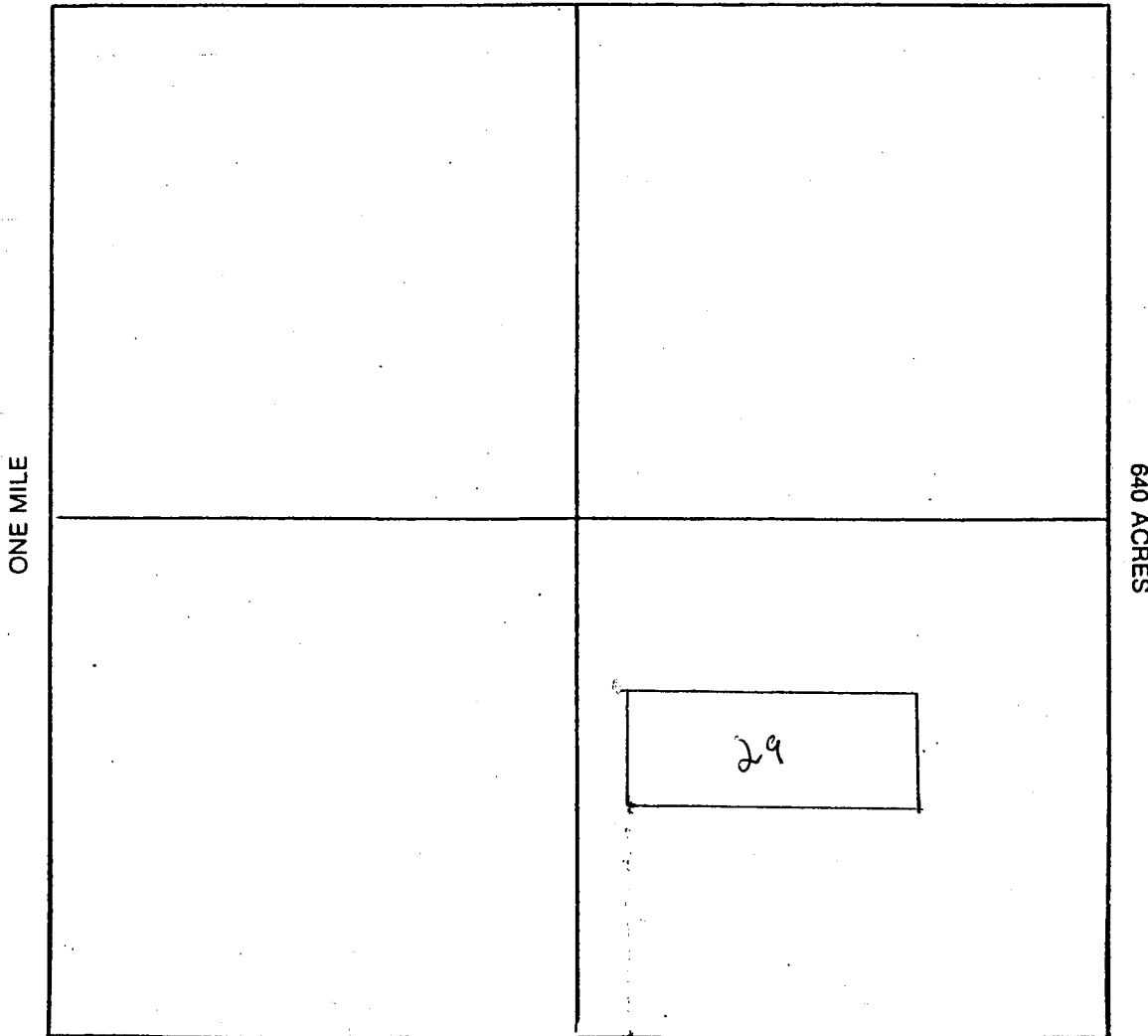

Section 34 Range 11 E Township 4S  
Gila and Salt River Base and Meridian.

Date 23 December 2001

*Mandy McKern*  
 SIGNATURE



2

STATE OF \_\_\_\_\_ } ss.  
COUNTY OF \_\_\_\_\_  
Witness my hand and Official Seal.  
Indexed Paged Blotted

I hereby certify that the within instrument  
filed for record in \_\_\_\_\_  
State of \_\_\_\_\_  
County Recorder  
By \_\_\_\_\_  
Deputy



OFFICIAL RECORDS OF  
PINAL COUNTY RECORDER  
LAURA DEAN-LYTTLE

DATE: 12/31/01 TIME: 1452  
FEE : 10.00  
PAGES: 2  
FEE NO: 2001-060460

When recorded, mail to: Martin J. McKenna 4101 E. Tamaya St., Phoenix, AZ 85044

### NOTICE OF MINING CLAIM

- 1. TYPE OF NOTICE:  Location  Amendment  Relocation
- 2. TYPE OF CLAIM:  Placer  Lode  Millsite  Tunnelsite
- 3. The name and address of the Locator is

Red Hills Mining LLC

4101 E. Tamaya St. NAME

Phoenix Arizona ADDRESS 85044

CITY Bluerock 30 STATE ZIP

- 4. The name of the claim is \_\_\_\_\_
- 5. The date of the location is 23 December 2001
- 6. The claim is 1500 feet long and 600 feet wide. The distance from the Location monument to each end of the claim is 1490 feet in a west direction and 10 feet in a east direction.
- 7. The general course of the claim is from the east to the west
- 8. The location of the claim is in Section 34, Township 4S, Range 11E, Gila and Salt River Base and Meridian, Red Hills Mining District, Pinal County, State of Arizona
- 9. If amending or relocating, the previous claim name was Redbird 34 recorded in Docket(Book) 1754 page(s) 795 of Red Hills Mining District, Pinal County, State of Arizona
- 10. The location of the claim, with reference to a natural object or permanent monument is The SW corner of the claim is 1500 feet in an east direction from the survey marker marking the SE corner of Section 33, T4S R11E and then 1800 feet north.

RECEIVED  
DEPARTMENT OF  
LAND MANAGEMENT  
2002 MAR 25 A 9:35

ANR 356066

Date 23 December 2001

(signature)  
4101 E. Tamaya St.  
(address)  
Phoenix, AZ 85044  
(city/state/zip)

91-15967

# MAP OF MINING CLAIM LOCATION

- Bluerock 30
1. The name of the claim is \_\_\_\_\_
  2. The SW corner of the claim is 1500 feet in a east direction to a survey monument or permanent natural object described as The survey marker marking the SE corner of Section 33 T4S R 11E and then 1800 feet north.
  3. The type of location monument is Stones and a wooden post  
The type of corner and end monuments are stones and a wooden post
  4. The bearing and distance between the corners of the claim are beginning at the SW corner of the claim, 1500 feet in a East direction to the SE corner, then 600 feet in a north direction to the NE corner, then 1500 feet in a west direction to the NW corner, then 600 feet in a south direction to the point of beginning.

## MAP

One inch = One thousand feet

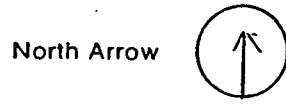

ONE MILE

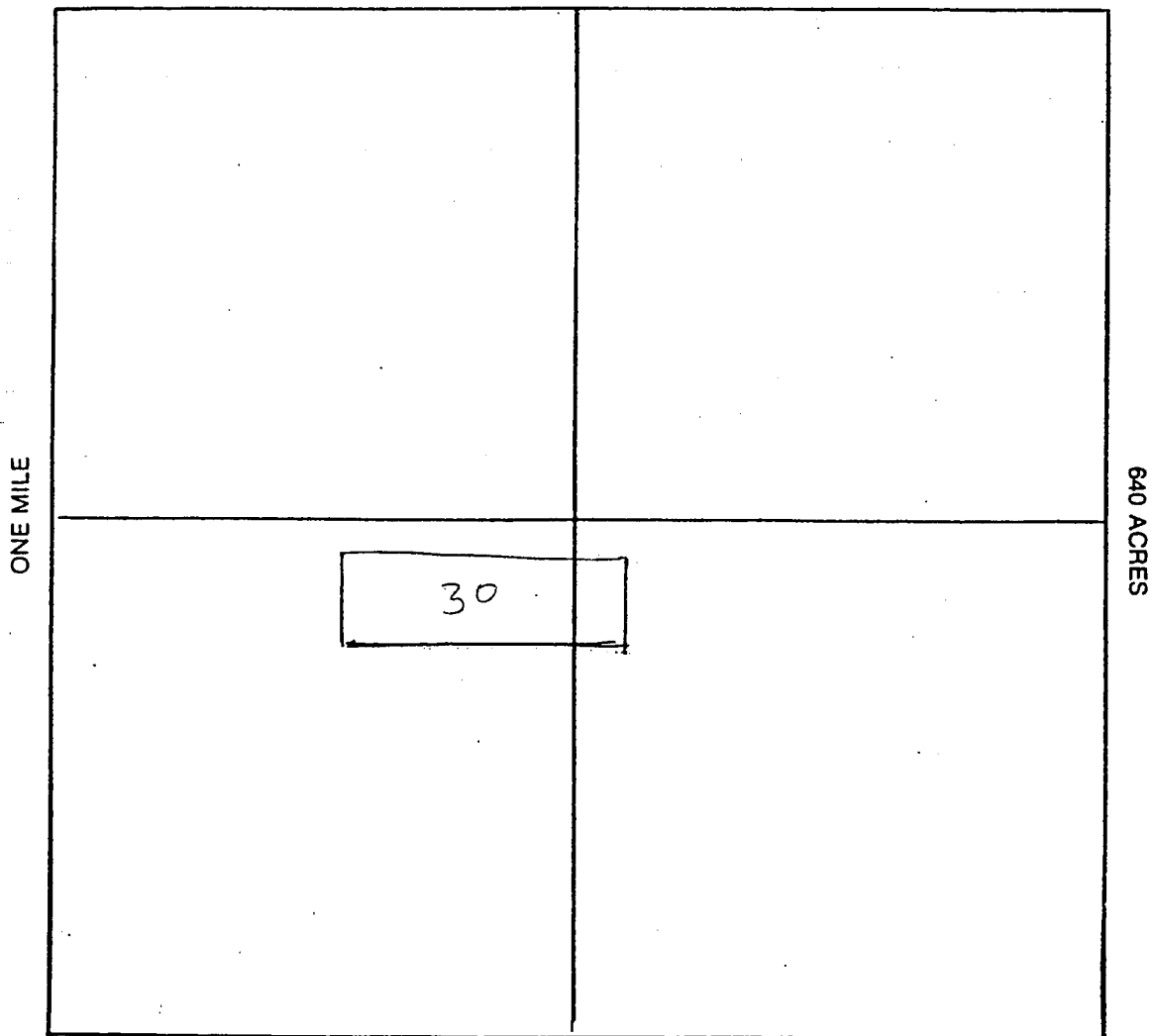

Section 34 Range 11 E Township 4S  
Gila and Salt River Base and Meridian.

Date 23 December 2001

*Nancy M. Kerner*  
 SIGNATURE

STATE OF  
COUNTY OF

ss.

I hereby certify that the within instru  
filed for record in \_\_\_\_\_  
State of \_\_\_\_\_

Witness my hand and Official Seal.

Indexed Paged Blotted

County Recorder

By \_\_\_\_\_  
Deputy



OFFICIAL RECORDS OF  
PINAL COUNTY RECORDER  
LAURA DEAN-LYTTLE

DATE: 12/31/01 TIME: 1452  
FEE : 10.00  
PAGES: 2  
FEE NO: 2001-060461

When recorded, mail to: Martin J. McKenna 4101 E. Tamaya St., Phoenix, AZ 85044

### NOTICE OF MINING CLAIM

- 1. TYPE OF NOTICE:  Location  Amendment  Relocation
- 2. TYPE OF CLAIM:  Placer  Lode  Millsite  Tunnelsite
- 3. The name and address of the Locator is

Red Hills Mining LLC

4101 E. Tamaya St. NAME

Phoenix Arizona ADDRESS 85044

CITY Bluerock 31 STATE ZIP

- 4. The name of the claim is \_\_\_\_\_
- 5. The date of the location is 23 December 2001
- 6. The claim is 1500 feet long and 600 feet wide. The distance from the Location monument to each end of the claim is 1490 feet in a east direction and 10 feet in a west direction.
- 7. The general course of the claim is from the east to the west
- 8. The location of the claim is in Section 34, Township 4S, Range 11E, Gila and Salt River Base and Meridian, Red Hills Mining District, Pinal County, State of Arizona
- 9. If amending or relocating, the previous claim name was Redbird<sup>35</sup> recorded in Docket(Book) 1754 page(s) 797 of Red Hills Mining District, Pinal County, State of Arizona
- 10. The location of the claim, with reference to a natural object or permanent monument is The SW corner of the claim is 3000 feet in an east direction from the survey marker marking the SE corner of Section 33, T4S R11E and then 1800 feet north

23 December 2001

Date \_\_\_\_\_

*Martin J. McKenna*  
(signature)

4101 E. Tamaya St.

Phoenix, AZ 85044  
(address)

(city/state/zip)

RECEIVED  
 COUNTY OF PINAL  
 OFFICE OF THE RECORDER  
 2002 MAR 25 A 9:35  
 LAMAR CAMPBELL

ANL 356067

91-15968

# MAP OF MINING CLAIM LOCAT

Bluerock 31

- The name of the claim is Bluerock 31
- The SW corner of the claim is 3000 feet in a east direction to a survey monument or permanent natural object described as The survey marker marking the SE corner of Section 33 T4S R 11E and then 1800 feet north.
- The type of location monument is Stones and a wooden post  
The type of corner and end monuments are stones and a wooden post
- The bearing and distance between the corners of the claim are beginning at the SW corner of the claim, 1500 feet in a East direction to the SE corner, then 600 feet in a north direction to the NE corner, then 1500 feet in a west direction to the NW corner, then 600 feet in a south direction to the point of beginning.

## MAP

One inch = One thousand feet

North Arrow



ONE MILE

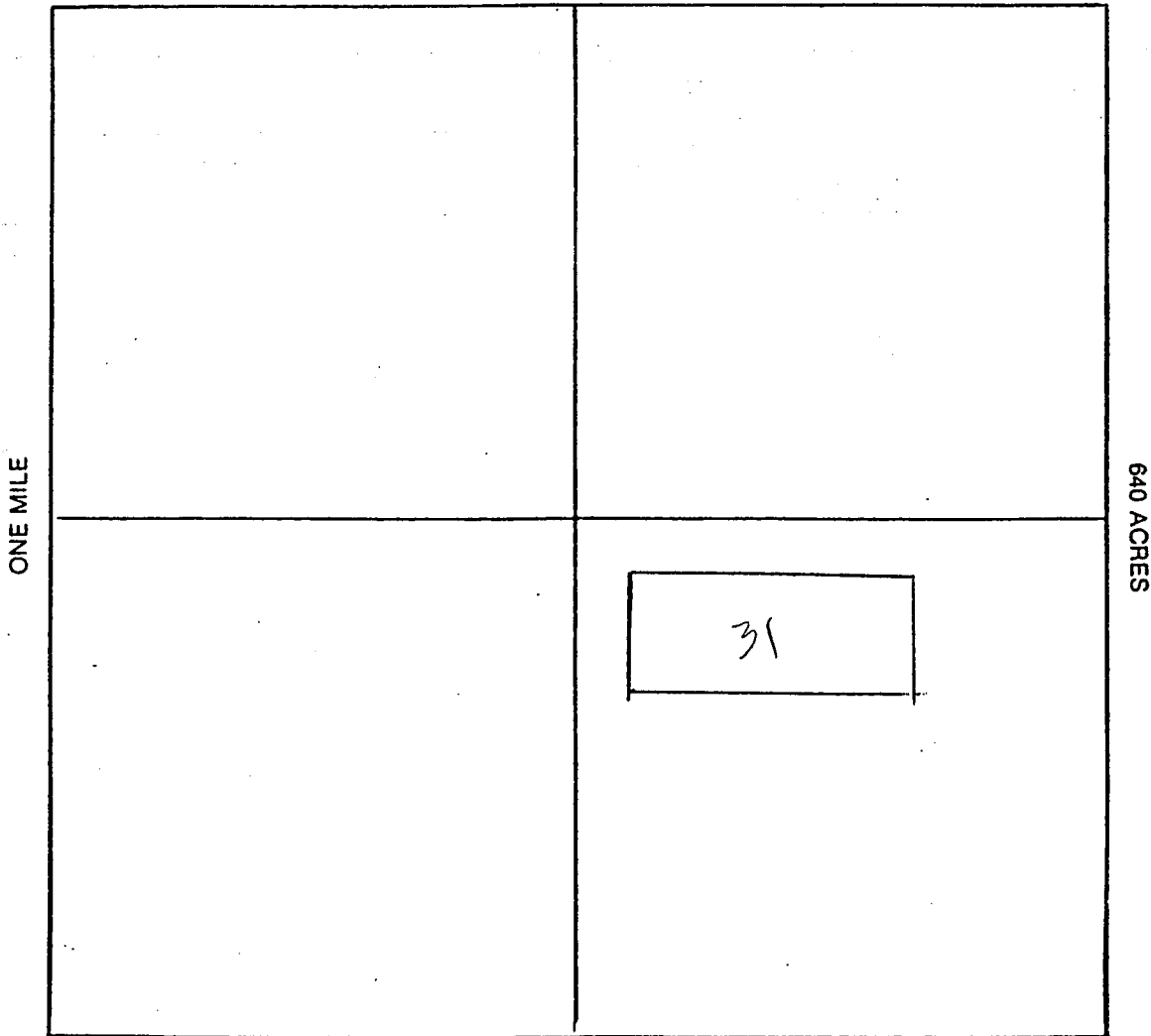

Section 34 Range 11 E Township 4S  
Gila and Salt River Base and Meridian.

Date 23 December 2001

Marty McKenna  
SIGNATURE

STATE OF \_\_\_\_\_ }  
COUNTY OF \_\_\_\_\_ } ss.  
Witness my hand and Official Seal.  
Indexed Paged Blotted

I hereby certify that the within instru  
filed for record in \_\_\_\_\_  
State of \_\_\_\_\_  
County Recorder  
By \_\_\_\_\_ Deputy



OFFICIAL RECORDS OF  
PINAL COUNTY RECORDER  
LAURA DEAN-LYTLLE

DATE: 12/31/01 TIME: 1452  
FEE : 10.00  
PAGES: 2  
FEE NO: 2001-060462

When recorded, mail to: Martin J. McKenna 4101 E. Tamaya St., Phoenix, AZ 85044

### NOTICE OF MINING CLAIM

1. TYPE OF NOTICE:  Location  Amendment  Relocation
2. TYPE OF CLAIM:  Placer  Lode  Millsite  Tunnelsite
3. The name and address of the Locator is

Red Hills Mining LLC

4101 E. Tamaya St. NAME

Phoenix Arizona ADDRESS 85044

CITY STATE ZIP  
Bluerock 32

4. The name of the claim is \_\_\_\_\_
5. The date of the location is 23 December 2001
6. The claim is 1500 feet long and 600 feet wide. The distance from the Location monument to each end of the claim is 1490 feet in an east west direction and 10 feet in a east direction.
7. The general course of the claim is from the east to the west
8. The location of the claim is in Section 34, Township 4S, Range 11E, Gila and Salt River Base and Meridian, Red Hills Mining District, Pinal County, State of Arizona
9. If amending or relocating, the previous claim name was Redbird 38 recorded in Docket(Book) 1754 page(s) 803 of Red Hills Mining District, Pinal County, State of Arizona
10. The location of the claim, with reference to a natural object or permanent monument is The SW corner of the claim is 1500 feet in an east direction from the survey marker marking the SE corner of Section 33, T4S R11E and then 2400 feet north.

RECORDED  
STATE OFFICE  
PHOENIX, ARIZONA  
2002 MAR 25 A 9:35  
LAND MANAGEMENT

Date 23 December 2001

*Martin J. McKenna*  
(signature)  
4101 E. Tamaya St.  
(address)  
Phoenix, AZ 85044  
(city/state/zip)

ANC 356068

91-15971



# MAP OF MINING CLAIM LOCATION

1. The name of the claim is Bluerock 32
2. The SW corner of the claim is 1500 feet in a east direction to a survey monument or permanent natural object described as The survey marker marking the SE corner of Section 33 T4S R 11E and then 2400 feet north.
3. The type of location monument is Stones and a wooden post  
The type of corner and end monuments are stones and a wooden post
4. The bearing and distance between the corners of the claim are beginning at the SW corner of the claim, 1500 feet in a East direction to the SE corner, then 600 feet in a north direction to the NE corner, then 1500 feet in a west direction to the NW corner, then 600 feet in a south direction to the point of beginning.

## MAP

One inch = One thousand feet

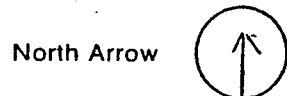

ONE MILE

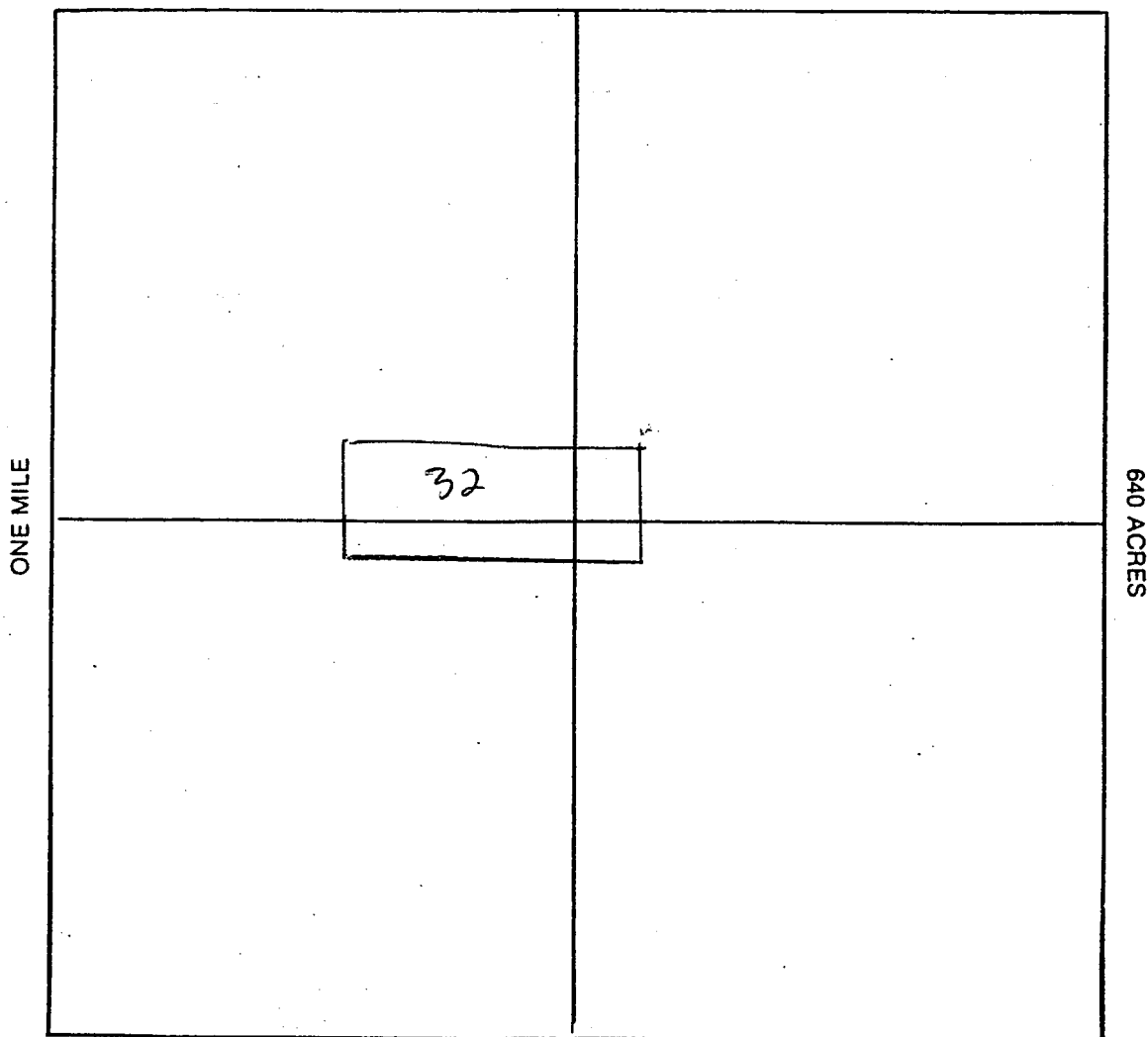

Section 34 Range 11 E Township 4S  
Gila and Salt River Base and Meridian.

Date 23 December 2001

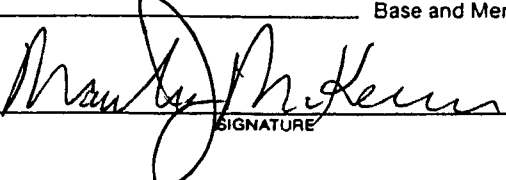
  
SIGNATURE

2

STATE OF \_\_\_\_\_ }  
COUNTY OF \_\_\_\_\_ } ss.  
Witness my hand and Official Seal.  
Indexed Paged Blotted

by certify that the within instr  
filed for record in \_\_\_\_\_  
State of \_\_\_\_\_  
County Recorder  
By \_\_\_\_\_  
Deputy



OFFICIAL RECORDS OF  
PINAL COUNTY RECORDER  
LAURA DEAN-LYTTLE

DATE: 12/31/01 TIME: 1452  
FEE : 10.00  
PAGES: 2  
FEE NO: 2001-060463

When recorded, mail to: Martin J. McKenna 4101 E. Tamaya St., Phoenix, AZ 85044

### NOTICE OF MINING CLAIM

- 1. TYPE OF NOTICE:  Location  Amendment  Relocation
- 2. TYPE OF CLAIM:  Placer  Lode  Millsite  Tunnelsite
- 3. The name and address of the Locator is

Red Hills Mining LLC

4101 E. Tamaya St. NAME

Phoenix Arizona ADDRESS

85044

CITY Bluerock 33 STATE ZIP

- 4. The name of the claim is \_\_\_\_\_
- 5. The date of the location is 23 December 2001
- 6. The claim is 1500 feet long and 600 feet wide. The distance from the Location monument to each end of the claim is 1490 feet in a east direction and 10 feet in a west direction.
- 7. The general course of the claim is from the east to the west
- 8. The location of the claim is in Section 34, Township 4S, Range 11E, Gila and Salt River Base and Meridian, Red Hills Mining District, Pinal County, State of Arizona
- 9. If amending or relocating, the previous claim name was Redbird 39 recorded in Docket(Book) 1754 page(s) 805 of Red Hills Mining District, Pinal County, State of Arizona
- 10. The location of the claim, with reference to a natural object or permanent monument is The SW corner of the claim is 3000 feet in an east direction from the survey marker marking the SE corner of Section 33, T4S R11E and then 2400 feet north

2002 MAR 29 A 9:35  
RECORDED  
INDEXED  
LANSING OFFICE

23 December 2001

Date \_\_\_\_\_

*Martin J. McKenna*  
(Signature)

4101 E. Tamaya St.

Phoenix, AZ 85044  
(address)

(city/state/zip)

ANL 356064

91-15972

# MAP OF MINING CLAIM LOCATION

Bluerock 33

1. The name of the claim is \_\_\_\_\_
2. The SW corner of the claim is 3000 feet in a east direction to a survey monument or permanent natural object described as The survey marker marking the SE corner of Section 33 T4S R 11E and then 2400 feet north.
3. The type of location monument is Stones and a wooden post  
The type of corner and end monuments are stones and a wooden post
4. The bearing and distance between the corners of the claim are beginning at the SW corner of the claim, 1500 feet in a East direction to the SE corner, then 600 feet in a north direction to the NE corner, then 1500 feet in a west direction to the NW corner, then 600 feet in a south direction to the point of beginning.

## MAP

One inch = One thousand feet

North Arrow



ONE MILE

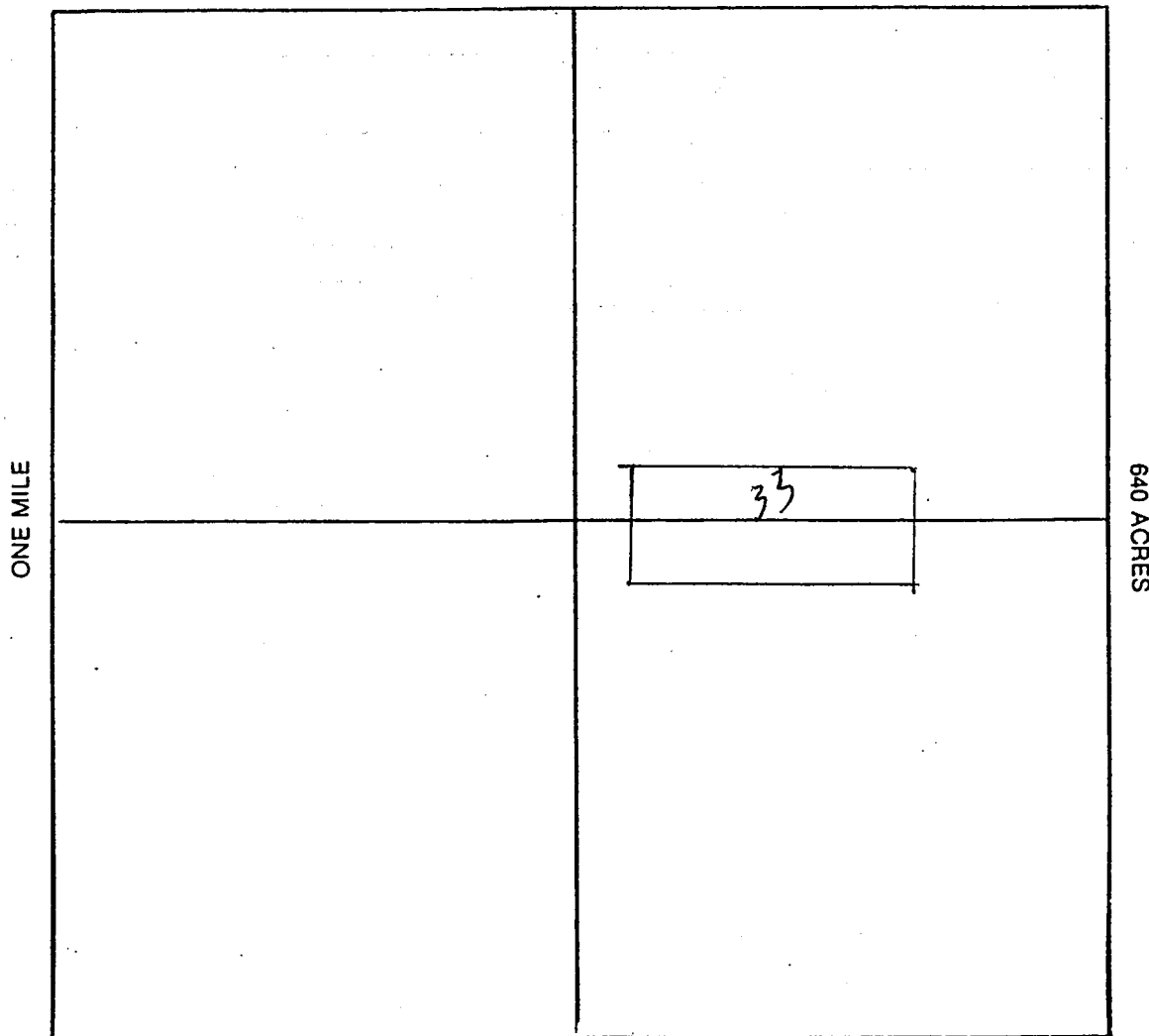

Section 34 Range 11 E Township 4S  
Gila and Salt River Base and Meridian.

Date 23 December 2001

*Walter H. Kern*  
 SIGNATURE

2

STATE OF \_\_\_\_\_ } ss.  
COUNTY OF \_\_\_\_\_ }  
Witness my hand and Official Seal.  
Indexed Paged Blotted

I hereby certify that the within instrument  
filed for record in \_\_\_\_\_  
State of \_\_\_\_\_  
County Recorder  
By \_\_\_\_\_  
Deputy



OFFICIAL RECORDS OF  
PINAL COUNTY RECORDER  
LAURA DEAN-LYTLLE

DATE: 12/31/01 TIME: 1452  
FEE : 10.00  
PAGES: 2  
FEE NO: 2001-060464

When recorded, mail to: Martin J. McKenna 4101 E. Tamaya St., Phoenix, AZ 85044

### NOTICE OF MINING CLAIM

- 1. TYPE OF NOTICE:  Location  Amendment  Relocation
- 2. TYPE OF CLAIM:  Placer  Lode  Millsite  Tunnelsite
- 3. The name and address of the Locator is

Red Hills Mining LLC

4101 E. Tamaya St.

Phoenix

Arizona

85044

CITY

Bluerock 34

STATE

ZIP

- 4. The name of the claim is \_\_\_\_\_
- 5. The date of the location is 23 December 2001
- 6. The claim is 1500 feet long and 600 feet wide. The distance from the Location monument to each end of the claim is 10 feet in a east direction and 1490 feet in a west direction.
- 7. The general course of the claim is from the east to the west
- 8. The location of the claim is in Section 34, Township 4S Range 11E  
Gila and Salt River Base and Meridian, Red Hills Mining District,  
Pinal County, State of Arizona
- 9. If amending or relocating, the previous claim name was Redbird 43  
Red Hills recorded in Docket(Book) 1754 page(s) 813  
Arizona Mining District, Pinal County, State of \_\_\_\_\_
- 10. The location of the claim with reference to a natural object or permanent monument is The SW corner of the claim is 1500 feet in an east direction from the survey marker marking the SE corner of Section 33, T4S R11E and then 3000 feet north.

RECORDED  
STATE OF ARIZONA  
2002 MAR 25 A 9:35  
LAND MANAGEMENT

AME 356070

23 December 2001

Date \_\_\_\_\_

*Martin J. McKenna*  
(signature)

4101 E. Tamaya St.

Phoenix, AZ 85044

(city/state/zip)

91-15976

# MAP OF MINING CLAIM LOCATION

Bluerock 34

1. The name of the claim is \_\_\_\_\_
2. The SW corner of the claim is 1500 feet in a east direction to a survey monument or permanent natural object described as The survey marker marking the SE corner of Section 33 T4S R 11E and then 3000 feet north.
3. The type of location monument is Stones and a wooden post  
The type of corner and end monuments are stones and a wooden post
4. The bearing and distance between the corners of the claim are beginning at the SW corner of the claim, 1500 feet in a East direction to the SE corner, then 600 feet in a north direction to the NE corner, then 1500 feet in a west direction to the NW corner, then 600 feet in a south direction to the point of beginning.

## MAP

One inch = One thousand feet

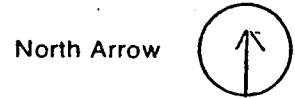

ONE MILE

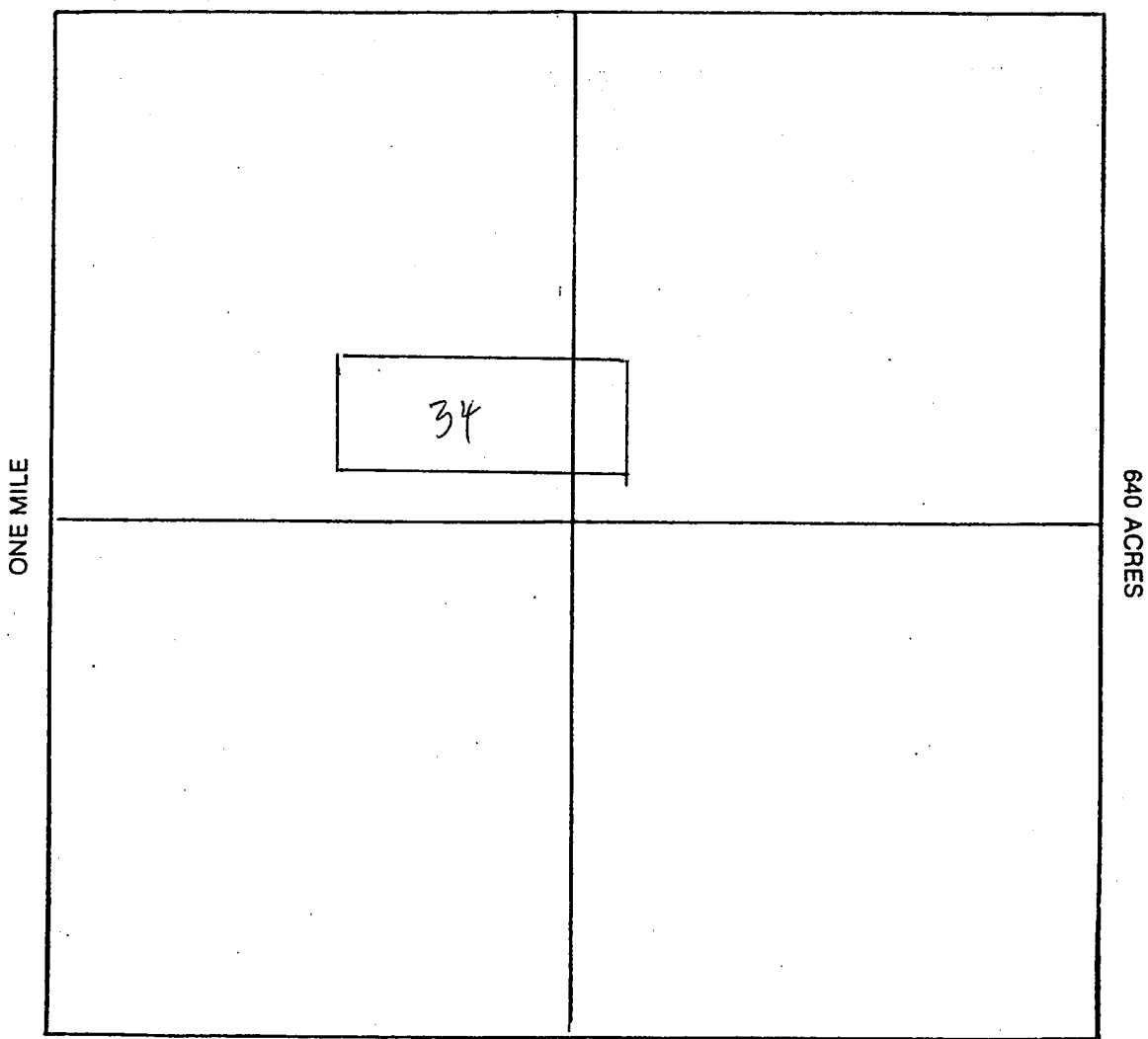

Section 34 Range 11 E Township 4S  
Gila and Salt River Base and Meridian.

Date 23 December 2001

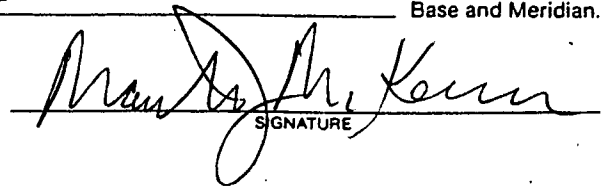
  
SIGNATURE



2

STATE OF  
COUNTY OF

Witness my hand and Official Seal.

Indexed Paged Blotted

by certify that the within instrum  
filed for record in \_\_\_\_\_  
State of \_\_\_\_\_

County Recorder

By \_\_\_\_\_  
Deputy



OFFICIAL RECORDS OF  
PINAL COUNTY RECORDER  
LAURA DEAN-LYTTLE

DATE: 12/31/01 TIME: 1452  
FEE: 10.00  
PAGES: 2  
FEE NO: 2001-060465

When recorded, mail to: Martin J. McKenna 4101 E. Tamaya St., Phoenix, AZ 85044

### NOTICE OF MINING CLAIM

- 1. TYPE OF NOTICE:  Location  Amendment  Relocation
- 2. TYPE OF CLAIM:  Placer  Lode  Millsite  Tunnel site
- 3. The name and address of the Locator is

Red Hills Mining LLC

4101 E. Tamaya St. NAME

Phoenix Arizona ADDRESS

85044

CITY Bluerock 35 STATE ZIP

- 4. The name of the claim is \_\_\_\_\_
- 5. The date of the location is 23 December 2001
- 6. The claim is 1500 feet long and 600 feet wide. The distance from the Location monument to each end of the claim is 1490 feet in a east direction and 10 feet in a west direction.
- 7. The general course of the claim is from the east to the west
- 8. The location of the claim is in Section 34, Township 4S, Range 11E, Gila and Salt River Base and Meridian, Red Hills Mining District, Pinal County, State of Arizona
- 9. If amending or relocating, the previous claim name was Redbird recorded in Docket(Book) 1754 page(s) 815 of Red Hills Mining District, Pinal County, State of Arizona
- 10. The location of the claim with reference to a natural object or permanent monument is The SW corner of the claim is 3000 feet in an east direction from the survey marker marking the SE corner of Section 33, T4S R11E and then 3000 feet north

2002 MAR 25 9 43 AM  
PINAL COUNTY RECORDER  
LAND DIVISION

23 December 2001

Date \_\_\_\_\_

Martin J. McKenna  
(signature)  
4101 E. Tamaya St.

Phoenix, AZ 85044  
(address)

(city/state/zip)

AMC 356071

91-15977

# MAP OF MINING CLAIM LOCATION

Bluerock 35

1. The name of the claim is \_\_\_\_\_
2. The SW corner of the claim is 3000 feet in a east direction to a survey monument or permanent natural object described as The survey marker marking the SE corner of Section 33 T4S R 11E and then 3000 feet north.
3. The type of location monument is Stones and a wooden post  
The type of corner and end monuments are stones and a wooden post
4. The bearing and distance between the corners of the claim are beginning at the SW corner of the claim, 1500 feet in a East direction to the SE corner, then 600 feet in a north direction to the NE corner, then 1500 feet in a west direction to the NW corner, then 600 feet in a south direction to the point of beginning.

## MAP

One inch = One thousand feet

North Arrow



ONE MILE

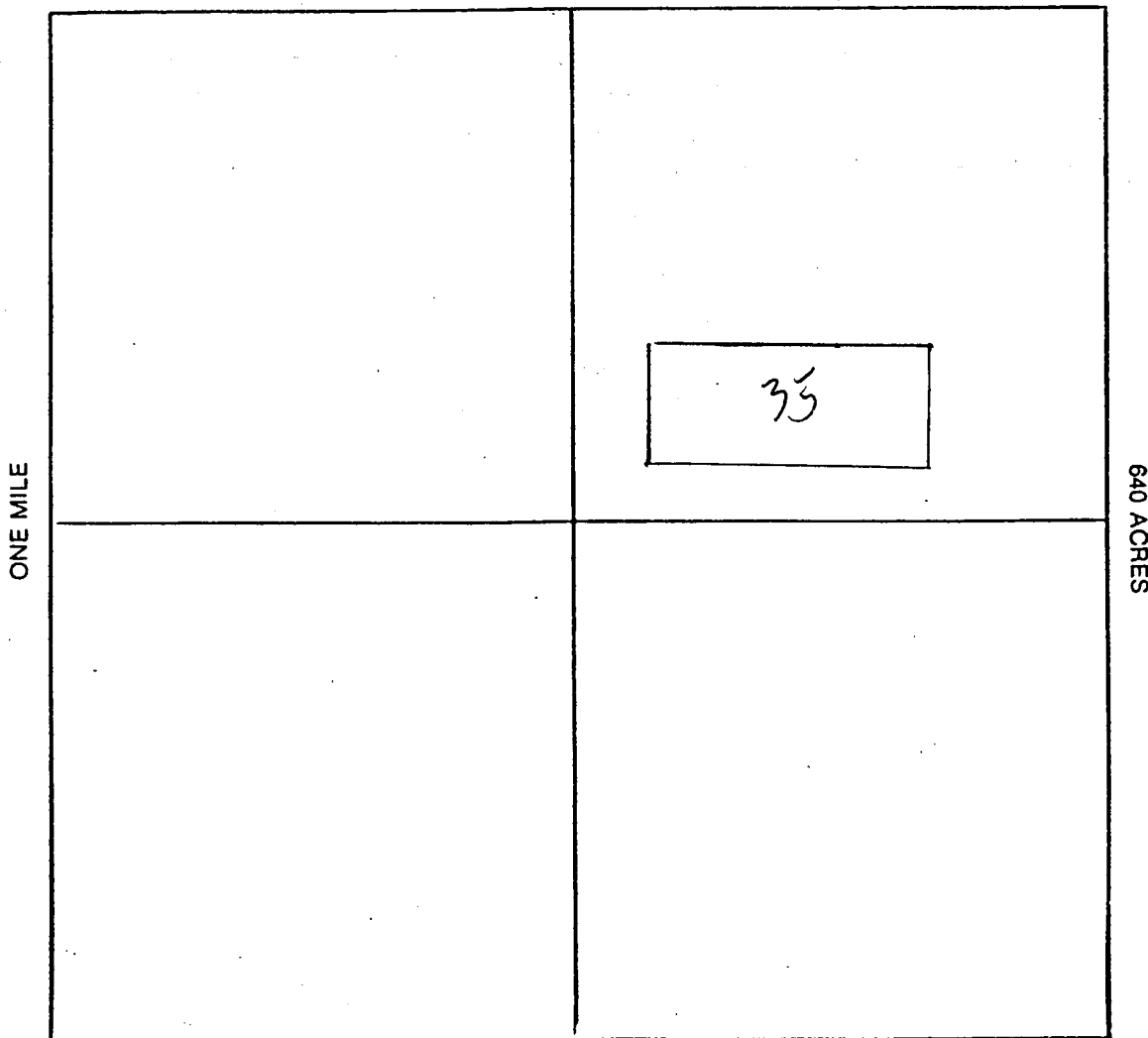

Section 34 Range 11 E Township 4S  
Gila and Salt River Base and Meridian.

Date 23 December 2001

*Mark J. McKee*  
SIGNATURE

STATE OF  
COUNTY OF

ss.

I hereby certify that the within instru  
filed for record in \_\_\_\_\_  
State of \_\_\_\_\_

Witness my hand and Official Seal.



OFFICIAL RECORDS OF  
PINAL COUNTY RECORDER  
LAURA DEAN-LYLTLE

DATE: 12/31/01 TIME: 1452  
FEE : 10.00  
PAGES: 2  
FEE NO: 2001-060466

County Recorder

By \_\_\_\_\_  
Deputy

When recorded, mail to: Martin J. McKenna 4101 E. Tamaya St., Phoenix, AZ 85044

### NOTICE OF MINING CLAIM

- 1. TYPE OF NOTICE:  Location  Amendment  Relocation
- 2. TYPE OF CLAIM:  Placer  Lode  Millsite  Tunnelsite
- 3. The name and address of the Locator is

Red Hills Mining LLC

4101 E. Tamaya St. NAME

Phoenix ADDRESS Arizona

85044

CITY Bluerock 36 STATE ZIP

- 4. The name of the claim is \_\_\_\_\_
- 5. The date of the location is 23 December 2001
- 6. The claim is 1500 feet long and 600 feet wide. The distance from the Location monument to each end of the claim is 1490 feet in a west direction and 10 feet in a east direction.
- 7. The general course of the claim is from the east to the west
- 8. The location of the claim is in Section 34, Township 4S, Range 11E, Gila and Salt River Base and Meridian, Red Hills Mining District, Pinal County, State of Arizona
- 9. If amending or relocating, the previous claim name was Redbird 48 recorded in Docket(Book) 1754 page(s) 823 of Red Hills Mining District, Pinal County, State of Arizona
- 10. The location of the claim with reference to a natural object or permanent monument is The SW corner of the claim is 1500 feet in an east direction from the survey marker marking the SE corner of Section 33, T4S R11E and then 3600 feet north.

2002 MAR 25 A 9 36  
STATE OF ARIZONA  
LAND MANAGEMENT

ARC 356072

23 December 2001

Date \_\_\_\_\_

(signature)  
4101 E. Tamaya St.

(address)  
Phoenix, AZ 85044

(City/state/zip)

91-15981

# MAP OF MINING CLAIM LOCATION

Bluerock 36

1. The name of the claim is Bluerock 36
2. The SW corner of the claim is 1500 feet in a east direction to a survey monument or permanent natural object described as The survey marker marking the SE corner of Section 33 T4S R 11E and then 3600 feet north.
3. The type of location monument is Stones and a wooden post  
The type of corner and end monuments are stones and a wooden post
4. The bearing and distance between the corners of the claim are beginning at the SW corner of the claim, 1500 feet in a East direction to the SE corner, then 600 feet in a north direction to the NE corner, then 1500 feet in a west direction to the NW corner, then 600 feet in a south direction to the point of beginning.

## MAP

One inch = One thousand feet

North Arrow



ONE MILE

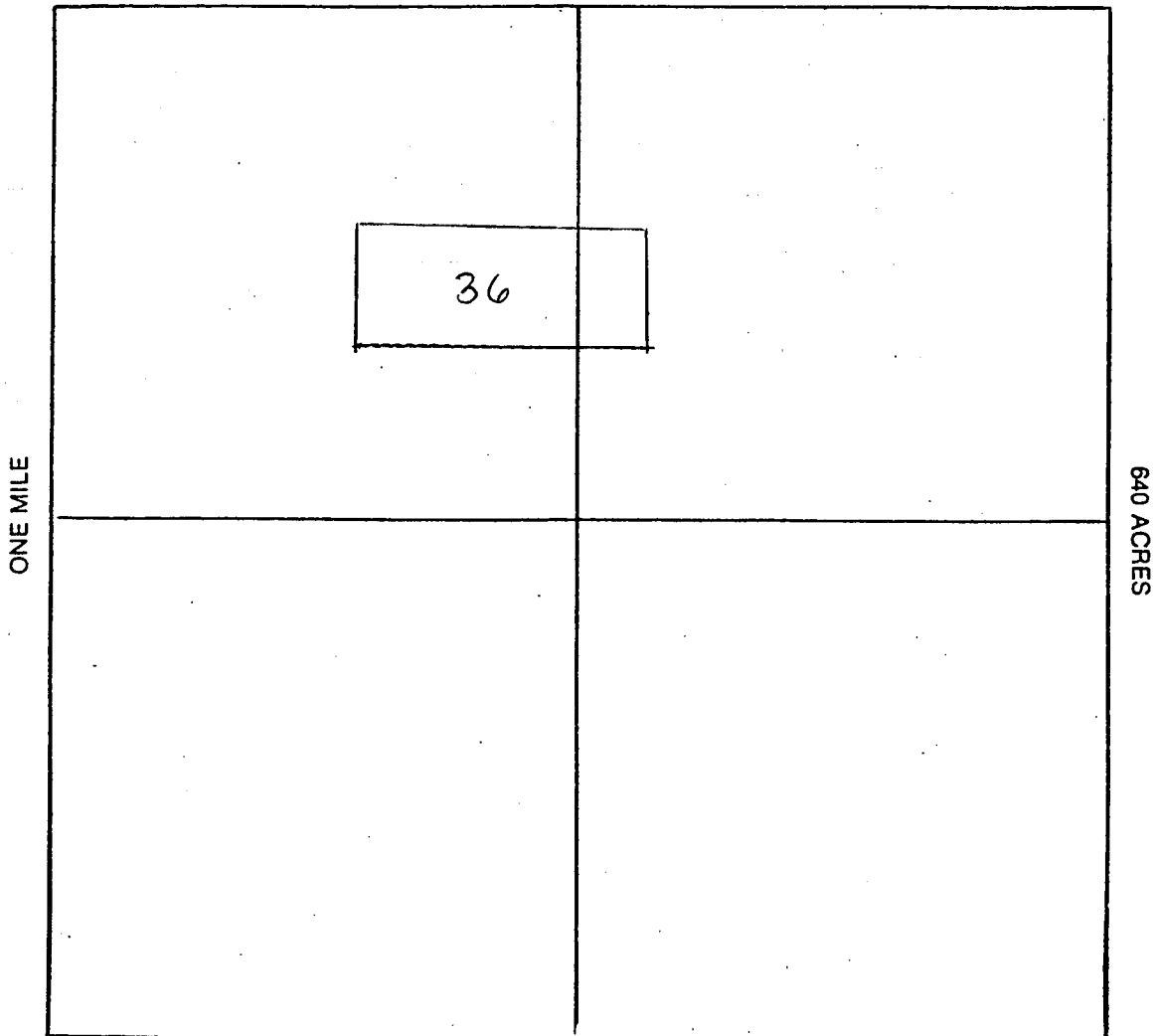

Section 34 Range 11 E Township 4S  
Gila and Salt River Base and Meridian.

Date 23 December 2001

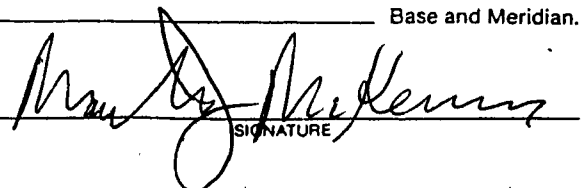
  
SIGNATURE

2

STATE OF \_\_\_\_\_ } ss.  
COUNTY OF \_\_\_\_\_ }  
Witness my hand and Official Seal.  
Indexed Paged Blotted

by certify that the within instrument  
filed for record in \_\_\_\_\_ Co  
State of \_\_\_\_\_  
County Recorder  
By \_\_\_\_\_  
Deputy



OFFICIAL RECORDS OF  
PINAL COUNTY RECORDER  
LAURA DEAN-LYTTLE

DATE: 12/31/01 TIME: 1452  
FEE : 10.00  
PAGES: 2  
FEE NO: 2001-060467

When recorded, mail to: Martin J. McKenna 4101 E. Tamaya St., Phoenix, AZ 85044

### NOTICE OF MINING CLAIM

- 1. TYPE OF NOTICE:  Location  Amendment  Relocation
- 2. TYPE OF CLAIM:  Placer  Lode  Millsite  Tunnelsite
- 3. The name and address of the Locator is

Red Hills Mining LLC

4101 E. Tamaya St. NAME

Phoenix Arizona ADDRESS 85044

CITY Bluerock 37 STATE ZIP

- 4. The name of the claim is \_\_\_\_\_
- 5. The date of the location is 23 December 2001
- 6. The claim is 1500 feet long and 600 feet wide. The distance from the Location monument to each end of the claim is 1490 feet in a east direction and 10 feet in a west direction.
- 7. The general course of the claim is from the east to the west
- 8. The location of the claim is in Section 34, Township 4S, Range 11E, Gila and Salt River Base and Meridian, Red Hills Mining District, Pinal County, State of Arizona
- 9. If amending or relocating, the previous claim name was Redbird 49 recorded in Docket(Book) 1754 page(s) 825 of Red Hills Mining District, Pinal County, State of Arizona
- 10. The location of the claim, with reference to a natural object or permanent monument is The SW corner of the claim is 3000 feet in an east direction from the survey marker marking the SE corner of Section 33, T4S R11E and then 3600 feet north

2002 MAR 25 A 9:36  
LAND MANAGEMENT

AME 356013

23 December 2001

Date \_\_\_\_\_

4101 E. Tamaya St. (signature)  
Phoenix, AZ 85044 (address)  
(city/state/zip)

91-15982



**MAP OF MINING CLAIM LOCATION**

Bluerock 37

- The name of the claim is \_\_\_\_\_
- The SW corner of the claim is 3000 feet in a east direction to a survey monument or permanent natural object described as The survey marker marking the SE corner of Section 33 T4S R 11E and then 3600 feet north.  
Stones and a wooden post
- The type of location monument is \_\_\_\_\_  
The type of corner and end monuments are stones and a wooden post SW
- The bearing and distance between the corners of the claim are beginning at the corner of the claim, 1500 feet in a East direction to the SE corner, then 600 feet in a north direction to the NE corner, then 1500 feet in a west direction to the NW corner, then 600 feet in a south direction to the point of beginning.

**MAP**

One inch = One thousand feet

North Arrow



ONE MILE

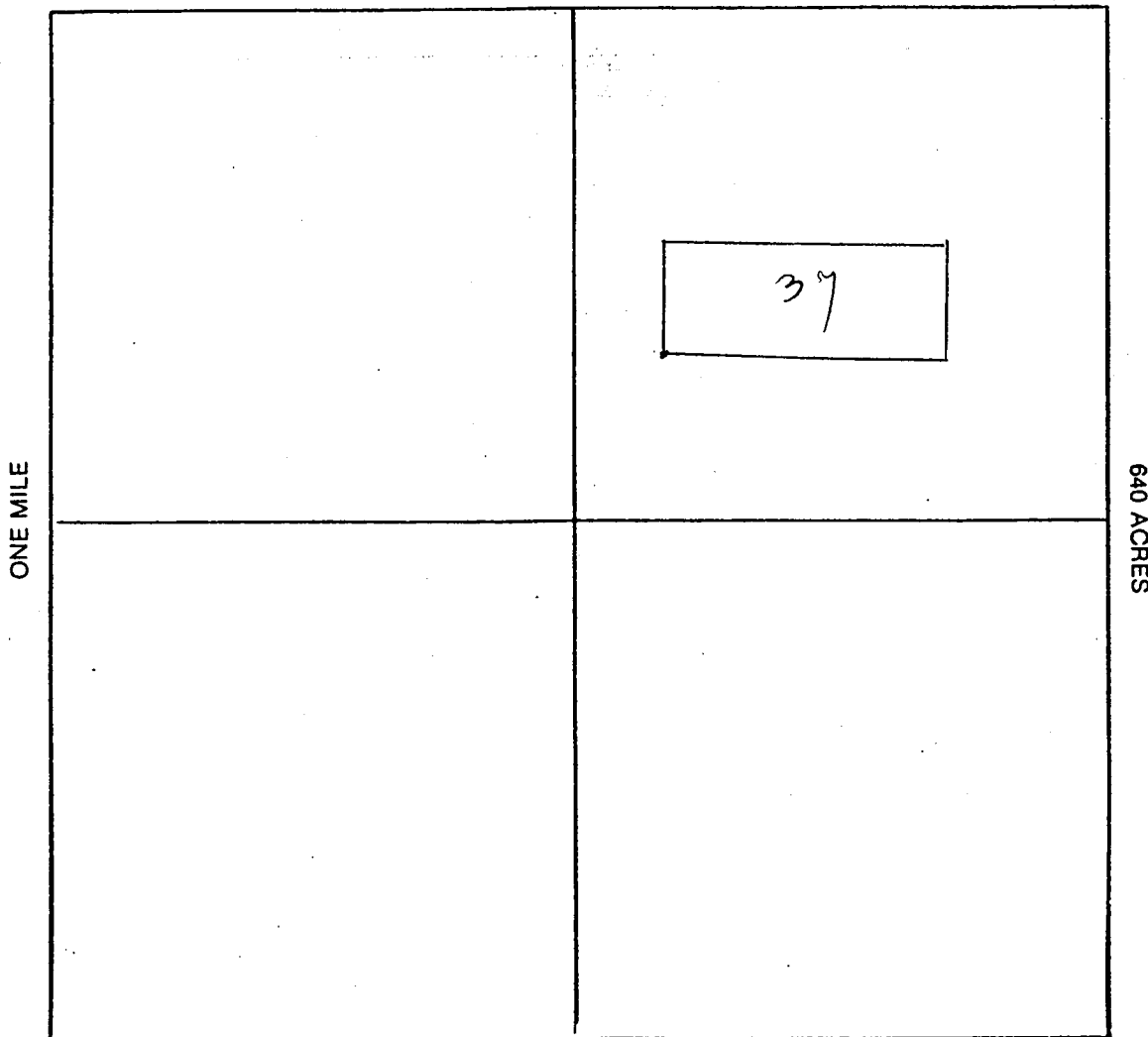

Section 34 Range 11 E Township 4S  
Gila and Salt River Base and Meridian.

Date 23 December 2001

*Mary J. McKee*  
 SIGNATURE

STATE OF  
COUNTY OF

} ss.

I hereby certify that the within instrument  
filed for record in \_\_\_\_\_ C  
State of \_\_\_\_\_

Witness my hand and Official Seal.

Indexed Paged Blotted

County Recorder

By \_\_\_\_\_  
Deputy



OFFICIAL RECORDS OF  
PINAL COUNTY RECORDER  
LAURA DEAN-LYTTLE

DATE: 12/31/01 TIME: 1452  
FEE : 10.00  
PAGES: 2  
FEE NO: 2001-060468

When recorded, mail to: Martin J. McKenna 4101 E. Tamaya St., Phoenix, AZ 85044

### NOTICE OF MINING CLAIM

1. TYPE OF NOTICE:  Location  Amendment  Relocation
2. TYPE OF CLAIM:  Placer  Lode  Millsite  Tunnelsite
3. The name and address of the Locator is

Red Hills Mining LLC

4101 E. Tamaya St. NAME

Phoenix Arizona ADDRESS 85044

CITY Bluerock 38 STATE ZIP

4. The name of the claim is \_\_\_\_\_
5. The date of the location is 23 December 2001
6. The claim is 1500 feet long and 600 feet wide. The distance from the Location monument to each end of the claim is 1490 feet in a west direction and 10 feet in a east direction.
7. The general course of the claim is from the east to the west
8. The location of the claim is in Section 34, Township 4S, Range 11E, Gila and Salt River Base and Meridian, Red Hills Mining District, Pinal County, State of Arizona
9. If amending or relocating, the previous claim name was Redbird 53 recorded in Docket(Book) 1754 page(s) 833 of Red Hills Mining District, Pinal County, State of Arizona
10. The location of the claim with reference to a natural object or permanent monument is The SW corner of the claim is 1500 feet in an east direction from the survey marker marking the SE corner of Section 33, T4S R11E and then 4200 feet north.

2002 MAR 25 A 9:30  
LAND MANAGEMENT  
STATE OF ARIZONA  
PHOENIX, ARIZONA

AMG 356074

Date 23 December 2001

*Martin J. McKenna*  
(signature)  
4101 E. Tamaya St.  
(address)  
Phoenix, AZ 85044  
(city/state/zip)

91-15986

# MAP OF MINING CLAIM LOCATION

Bluerock 38

1. The name of the claim is \_\_\_\_\_
2. The SW corner of the claim is 1500 feet in a east direction to a survey monument or permanent natural object described as The survey marker marking the SE corner of Section 33 T4S R 11E and then 4200 feet north.
3. The type of location monument is Stones and a wooden post  
The type of corner and end monuments are stones and a wooden post
4. The bearing and distance between the corners of the claim are beginning at the SW corner of the claim, 1500 feet in a East direction to the SE corner, then 600 feet in a north direction to the NE corner, then 1500 feet in a west direction to the NW corner, then 600 feet in a south direction to the point of beginning.

## MAP

One inch = One thousand feet

North Arrow



ONE MILE

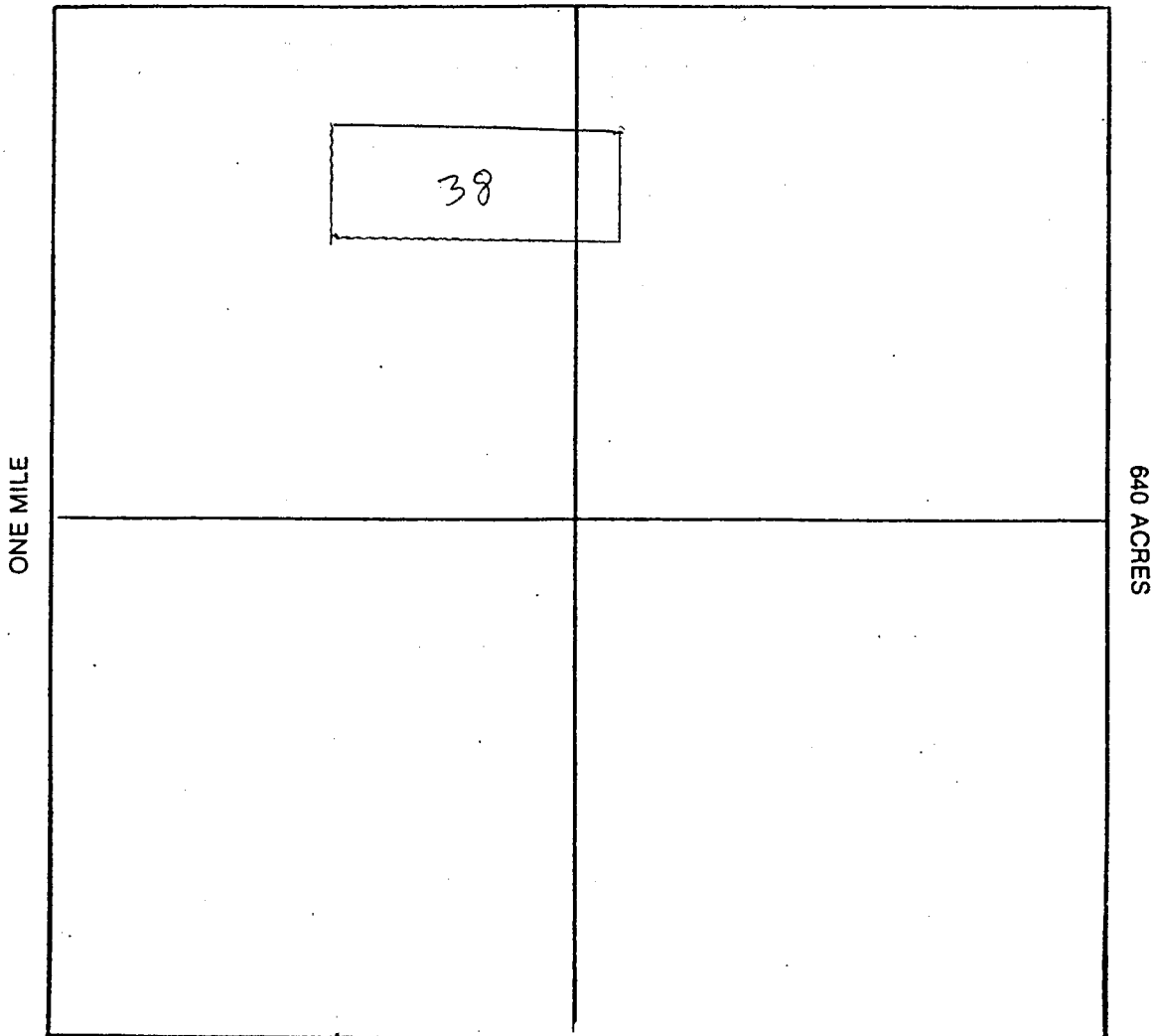

Section 34 Range 11 E Township 4S  
Gila and Salt River Base and Meridian.

Date 23 December 2001

*Manoj Shukla*  
 SIGNATURE

STATE OF \_\_\_\_\_ }  
COUNTY OF \_\_\_\_\_ } ss.  
Witness my hand and Official Seal.  
Indexed Paged Blotted

reby certify that the within instrument  
filed for record in \_\_\_\_\_  
State of \_\_\_\_\_  
County Recorder  
By \_\_\_\_\_  
Deputy



OFFICIAL RECORDS OF  
PINAL COUNTY RECORDER  
LAURA DEAN-LYTTLE

DATE: 12/31/01 TIME: 1452  
FEE : 10.00  
PAGES: 2  
FEE NO: 2001-060469

When recorded, mail to: Martin J. McKenna 4101 E. Tamaya St., Phoenix, AZ 85044

### NOTICE OF MINING CLAIM

- 1. TYPE OF NOTICE:  Location  Amendment  Relocation
- 2. TYPE OF CLAIM:  Placer  Lode  Millsite  Tunnelsite
- 3. The name and address of the Locator is

Red Hills Mining LLC

4101 E. Tamaya St. NAME

Phoenix Arizona ADDRESS 85044

CITY Bluerock 39 STATE ZIP

- 4. The name of the claim is \_\_\_\_\_
- 5. The date of the location is 23 December 2001
- 6. The claim is 1500 feet long and 600 feet wide. The distance from the Location monument to each end of the claim is 1490 feet in a east direction and 10 feet in a west direction.
- 7. The general course of the claim is from the east to the west
- 8. The location of the claim is in Section 34, Township 4S, Range 11E, Gila and Salt River Base and Meridian, Red Hills Mining District, Pinal County, State of Arizona
- 9. If amending or relocating, the previous claim name was Redbird 54 recorded in Docket(Book) 1754 page(s) 835 of Red Hills Mining District, Pinal County, State of Arizona
- 10. The location of the claim with reference to a natural object or permanent monument is The SW corner of the claim is 3000 feet in an east direction from the survey marker marking the SE corner of Section 33, T4S R11E and then 4200 feet north

2002 MAR 25 A 9 36  
LAND MANAGEMENT

23 December 2001

Date \_\_\_\_\_

4101 E. Tamaya St. (signature)  
Phoenix, AZ 85044 (address)  
(city/state/zip)

91-15987

FILE 300013

# MAP OF MINING CLAIM LOCAT

Bluerock 39

- The name of the claim is \_\_\_\_\_
- The SW corner of the claim is 3000 feet in a east direction to a survey monument or permanent natural object described as The survey marker marking the SE corner of Section 33 T4S R 11E and then 4200 feet north.
- The type of location monument is Stones and a wooden post  
The type of corner and end monuments are stones and a wooden post
- The bearing and distance between the corners of the claim are beginning at the corner of the claim, 1500 feet in a East direction to the SE corner, then 600 feet in a north direction to the NE corner, then 1500 feet in a west direction to the NW corner, then 600 feet in a south direction to the point of beginning.

## MAP

One inch = One thousand feet

North Arrow



ONE MILE

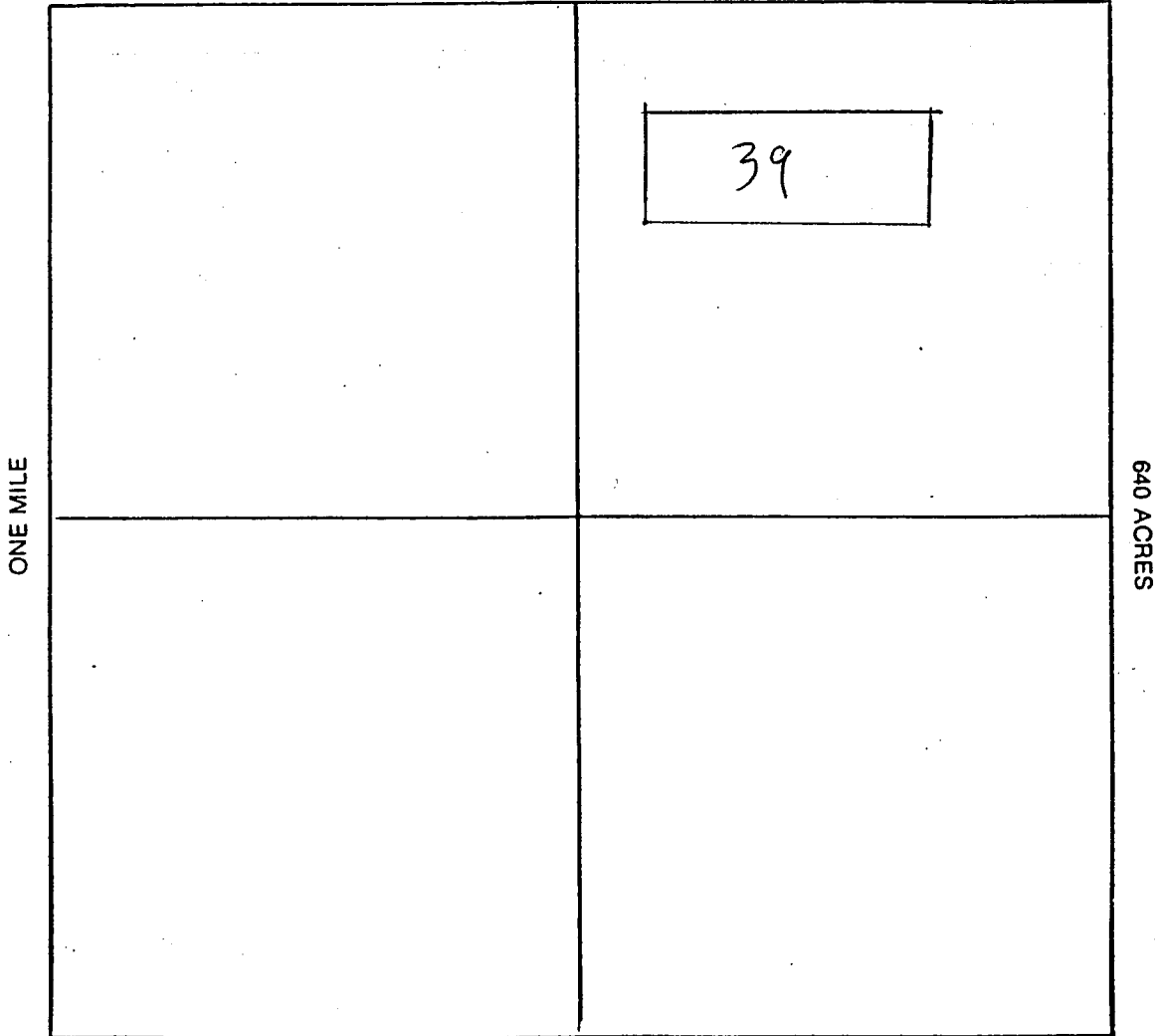

Section 34 Range 11 E Township 4S  
Gila and Salt River Base and Meridian.

Date 23 December 2001

*Mandy M. Keen*  
 SIGNATURE



# The United States of America,

To all to whom these presents shall come, Greeting:

WHEREAS, under the provisions of Section 8 of the Act of June 28, 1934 (48 Stat. 1269), entitled "An Act To stop injury to the public grazing lands by preventing overgrazing and soil deterioration, to provide for their orderly use, improvement, and development, to stabilize the livestock industry dependent upon the public range, and for other purposes," as amended by Section 3 of the Act of June 26, 1936 (49 Stat. 1976), the State of Arizona, in exchange for certain other lands situated in said State, has selected the following described tracts of land;

Gila and Salt River Meridian, Arizona.

Township four south of Range eleven east.

The Sections twenty-eight, twenty-nine, thirty, thirty-one, thirty-three, thirty-four, and thirty-five.

Township four south of Range thirteen east.

The Lots one, two, three, four, five, six, seven, and eight, the south half of the northeast quarter, the southeast quarter of the northwest quarter, the east half of the southwest quarter, and the southeast quarter of Section thirty-one and the Section thirty-four;

Township five south of Range ten east.

The Section one, containing, in the aggregate, six thousand three hundred thirty-six acres and eighty-six hundredths of an acre, according to the Official Plats of the Surveys of the said Lands, on file in the General Land Office;

NOW KNOW YE, That the UNITED STATES OF AMERICA, in consideration of the premises, and in conformity with the said Acts of Congress, HAS GIVEN AND GRANTED, and by these presents DO'S GIVE AND GRANT, unto

1112073



the said State of Arizona, in fee simple, the tracts of land above described; TO HAVE AND TO HOLD the same, together with all the rights, privileges, immunities, and appurtenances, of whatsoever nature thereunto belonging, unto the said State of Arizona, and to its assigns forever; subject to any vested and accrued water rights for mining, agricultural, manufacturing, or other purposes, and rights to ditches and reservoirs used in connection with such water rights, as may be recognized and acknowledged by the local customs, laws, and decisions of courts; and there is reserved from the lands hereby granted, a right of way thereon for ditches or canals constructed by the authority of the United States. Reserving, also, to the United States, all minerals in the lands so granted, together with the right to prospect for, mine and remove the same, as authorized by the provisions of said section 8, as amended as aforesaid.

IN TESTIMONY WHEREOF, I, **Franklin D. Roosevelt,**

President of the United States of America, have caused these letters to be made Patent, and the Seal of the General Land Office to be hereunto affixed.

GIVEN under my hand, at the City of Washington, the **TWENTY-FIFTH**

(SEAL)

day of **SEPTEMBER** in the year of our Lord one thousand

nine hundred and **FORTY-ONE** and of the Independence of the

United States the one hundred and **SIXTY-SIXTH**

By the President:

*Franklin D. Roosevelt*

By

*Jeanne Swaney* Secretary

*R. Clinton*

1112073

Chief, Patents Division, *General Land Office*

Input Parameters for Geographic Report with Land

System Id = CR

Admin State = AZ

Geo State = AZ

Casetype begins with

Case Disp Txt =

Mer Twp Rng =

Mtrs = 14 0040S 0110E 034

Commodity =

Pending Org =

Total Rows Returned: 2

RUN TIME: 02:58 PM

UNITED STATES DEPARTMENT OF INTERIOR  
BUREAU OF LAND MANAGEMENT  
GEOGRAPHIC REPORT WITH LAND  
Sorted by Serial Number

RUN DATE: 04/22/2002  
Page 1 of 1

Adm State: AZ

Serial Number: AZA 012335  
Total Case Acres: 1,280.000

<u>Casetype</u>	<u>Case Disp</u>				<u>Sect</u>	<u>Sur Typ</u>	<u>Sur Num</u>	<u>Suff</u>	<u>Subdivision</u>	<u>Act Pend</u>
311111	CLOSED	14	0040S	0110E	034	ALIQ			ALL;	

Serial Number: AZA 020990  
Total Case Acres: 4,970.290

<u>Casetype</u>	<u>Case Disp</u>				<u>Sect</u>	<u>Sur Typ</u>	<u>Sur Num</u>	<u>Suff</u>	<u>Subdivision</u>	<u>Act Pend</u>
311211	CLOSED	14	0040S	0110E	034	FF		1	ALL;	







Red Hills Mining LLC  
4101 E. Tamaya St.  
Phoenix, AZ 85044

PLACE STICKER AT TOP OF ENVELOPE TO THE RIGHT  
OF THE RETURN ADDRESS. FOLD AT DOTTED LINE

**CERTIFIED MAIL**



7001 2510 0005 6292 4145



9264

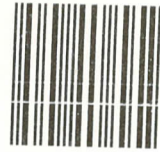

85004

U.S. POSTAGE  
PAID  
PHOENIX, AZ  
85044  
MAR 22, '02  
AMOUNT

**\$4.63**  
00021623-00

**RETURN RECEIPT  
REQUESTED**

**RETURN RECEIPT  
REQUESTED**

Bureau of Land Management  
Arizona State Office  
222 N. Central Ave  
Phoenix, AZ 85004-2203

RECEIVED  
BUREAU OF  
LAND MANAGEMENT  
2002 MAR 25 A 9:11  
ARIZONA  
STATE OFFICE  
PHOENIX, ARIZONA